

## Toyota Tundra Exhaust System Installation PN 140238 & 140332



These instructions have been written to help you with the installation of your Borla Performance Exhaust System. Please read this document completely before beginning the installation of your system.

Please compare the parts in the box with the bill of materials provided to assure that you have all the parts necessary for this installation.

To ensure this part number fits your specific model year, please visit our website for the latest model year listings at [www.BORLA.com](http://www.BORLA.com).

**Thank you for purchasing a Borla Performance Cat-Back™ Exhaust System.**

**Borla Performance Cat-Back™ Exhaust System (Part number 140238 & 140332) has been designed for the Toyota Tundra Crew Max Short Bed, Double Cab Standard Bed and Regular Cab Long Bed each equipped with 5.7L V8 engine, two or four-wheel drive and an automatic transmission.**

Borla Performance Industries recommends that an exhaust shop or professional after market parts installer perform the installation of this system. However, if you decide to perform the installation on your own it is recommended that two people are used. This installation should not be performed by one person due to the risk of injury. Ensure the installers use all under car safety precautions including eye protection.

*Please take time to read and understand the following...*

By installing your Borla Performance Exhaust System, you indicate that you have read this document and you agree with the terms stated below.

It is the responsibility of the purchaser to follow all installation instruction guidelines and safety procedures supplied with your Borla Performance Exhaust System

Borla Performance Industries assumes no responsibility for damages occurring from misuse, abuse, improper installation, improper operation, lack of responsible care, or all previously stated reasons resulting from incompatibility with other manufacturer's products and/or systems.

Included with your Borla Performance Exhaust System is a warranty card. Please read it carefully before you begin any work on your vehicle. If you should have any questions regarding our warranty policy, installation, or any other matter pertaining to your new Borla Performance Exhaust System, please give us a call at the number provided on the warranty card.

**Minimum Required Tool List:**

**TOOLS:**

- 1 3/8" Drive Ratchet
- 2 3/8" Drive Extension 3"
- 3 15mm Socket
- 5 Pry Bar

**SHOP SUPPLIES:**

- 1 Spray Lubricant

**Borla Performance Cat-Back™ Bill of Materials**

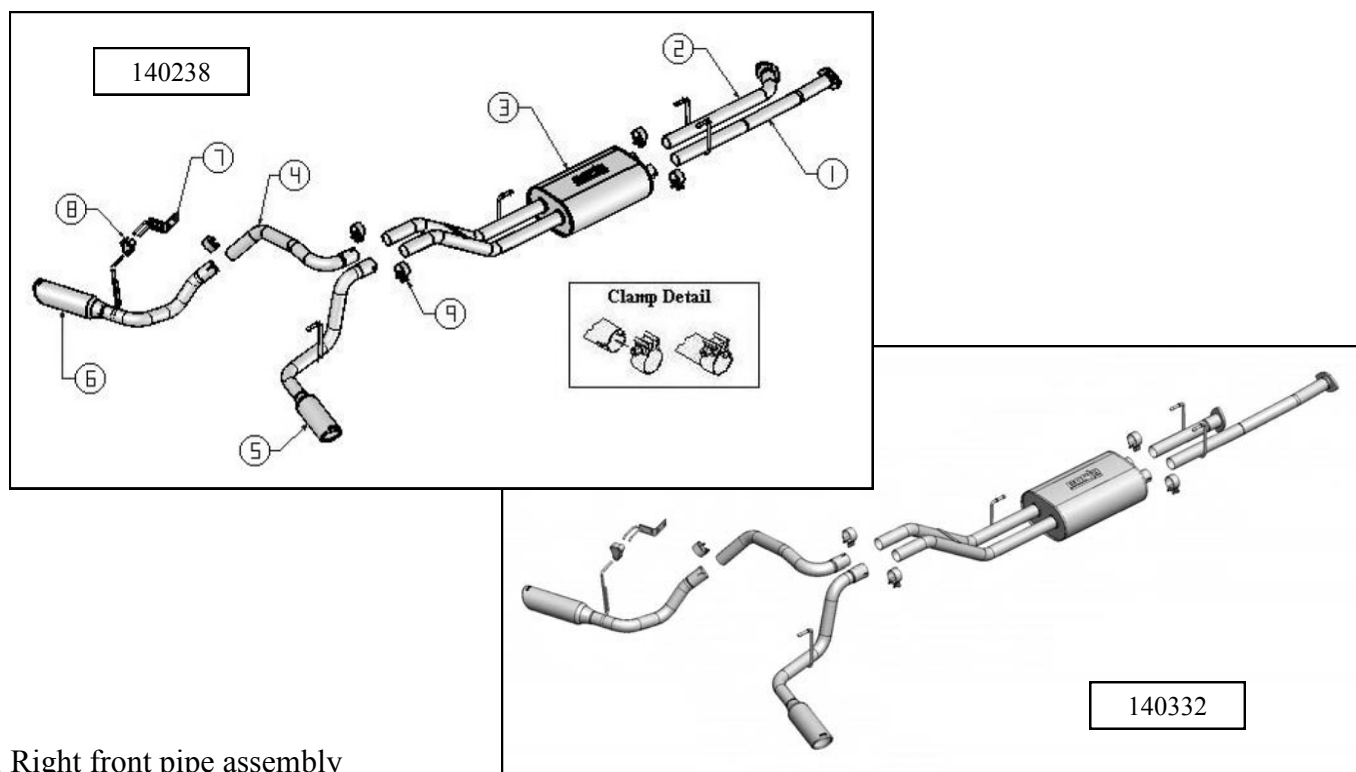

- 1. Right front pipe assembly
- 2. Left front pipe assembly
- 3. Muffler assembly
- 4. Left over axle pipe
- 5. Right tail pipe assembly
- 6. Left tail pipe assembly
- 7. Hanger/Bracket assembly (qty 1)
- 8. Isolator (qty 1)
- 9. 2.25" clamp (qty 5)

**Caution!!! Never work on a hot exhaust system. Serious injury in the form of burns can result**

If the vehicle has been in use and the exhaust system is hot, allow vehicle to cool for at least 1 hour. Always wear eye protection when working under any vehicle.

*Note: It is our recommendation that you use a hoist or hydraulic lift to facilitate the installation of your new Borla Performance Cat-Back™ Exhaust System.*

Taking all under car safety precautions, lift the vehicle using a hoist or hydraulic lift. Once this has been done, you may begin the removal of your old exhaust system from your vehicle.

*Note: Before removing the original exhaust system from your vehicle, please compare the parts you have received with the bill of materials provided on the previous page to assure that you have all the parts necessary for the installation of your new Borla Performance Cat-Back Exhaust System.*

## Original Exhaust System Removal

*Note: With a used vehicle, we suggest a penetrating spray lubricant to be applied liberally to all exhaust fasteners and allowing a significant period of time for the chemical to lubricate the threads before attempting to disassemble.*

1. For an easier time during the removal of the factory exhaust and for the installation of your new exhaust system, remove the spare tire as recommended by vehicle manual.
2. Loosen the clamp located just behind the muffler assembly. (See figure 1)
3. Lubricate all the hangers and rubber isolators.
4. Using a muffler stand or an additional person to hold the tail pipe assembly in position, remove the hangers from the rubber isolators and remove the tail pipe assembly from the vehicle.
5. Unbolt the two flanges located just after each catalytic converter. Place the hardware to the side for use during the installation of your new exhaust system. (See figure 2A and 2B)
6. Using a muffler stand or an additional person to hold the muffler assembly in position, remove the hangers from the rubber isolators and remove the remaining exhaust from the vehicle.

**Warning: Use extreme caution during installation. Torque all fasteners according to manufacturer's torque values and tightening sequence. DO NOT use air impact tools to tighten fasteners on Borla Performance Exhaust Systems. Use of such tools may result in bent flanges or gasket contact areas leading to exhaust leaks.**



Figure 1



Figure 2A



Figure 2B

## Borla Performance Cat-Back™ Exhaust System Installation

1. Place both left and right front pipe assemblies into position making sure to install the hangers into the rubber isolators. (See figure 3)
2. Using the original hardware, hand tighten the flanges.
3. Place a clamp over the expanded ends of the muffler assembly and insert into front pipe assemblies and hangar. Do Not tighten the clamps.
4. Place a clamp over the expanded end of the left intermediate pipe and set it into muffler assembly. Do Not tighten the clamps.
5. Install the hanger/bracket assemblies provided onto the outside of the passenger-side frame rail at the rear of the vehicle. Install the isolators provided onto the hanger/bracket assemblies. (See figure 4) Repeat for driver-side hanger/bracket assembly.
6. Place a clamp over the expanded ends of both the left tail pipe assembly and set them into position making sure to install the hangers into the rubber isolators. Do Not tighten the clamps. (See figure 5) Repeat for driver-side assembly.
7. Check your exhaust system for proper clearance under the vehicle and also for tip alignment. (See figure 6)
8. Once position has been determined to be correct, tighten the Accuseal™ clamps to 32-35 ft. lbs. making sure the clamp opening is not over any of the notches in the pipe and tighten the flange hardware to 18-22 ft. lbs.
9. Using the original hardware, reinstall the heat shield.
10. Reinstall the spare tire as recommended by vehicle manufacturer.
11. Before starting your vehicle, make sure to check all wires, hoses, brake lines, body parts and tires for safe clearance from the exhaust system.
12. Start vehicle and check for any leaks. If any leaks are found, determine cause (such as loose hardware or incorrectly positioned clamp) and repair as necessary.

*Note: When you first start your vehicle after the installation of your new Borla Performance Exhaust System, there may be some smoke and fumes coming from the system. This is a protective oil based coating used in the manufacturing of mandrel bent performance exhaust tubing. This is not a problem and will disappear within a very short period of time after the exhaust has reached normal operating temperatures.*



**Figure 3**



**Figure 4**



**Figure 5**



**Figure 6**