



Performance Front Strut Bar

Part Number: 42-103

**2002-2006 BMW 3-Series E46
(325, 330, & M3. M54 & S54 engine)**

Installation Instructions

For technical inquiries please email us at tech@hpsperformanceproducts.com

In the email, please include the following information for faster response:

- Year / Make / Model / Engine of your vehicle.
- If it is a fitment issue, please include pictures showing the fitment problem.
- If there are missing parts, please list the part number(s) from the bill of materials on the 2nd page.
- Optional but recommended – Your contact phone number and preferred call back time.

You can also give us a call via 626-747-9200 for tech support Monday-Friday, 9:00am-5:00pm Pacific Time.

Bill of Materials

Part Number: 42-103

Description	Prep	Part Number	Qty	Check
E46 Front Strut Bar		42-103		
Bar	1	451-103-AL	1	
Passenger Side Bracket	1	431-103-R	1	
Driver Side Bracket	1	431-103-L	1	
M12 Bolt, 10mm Allen Head	1		2	
M12 Flange Nut, 18mm Head	1		2	



- Before installing any parts of this strut bar, please read the instructions thoroughly.
- Verify the contents of this strut bar before disassembling your vehicle.
- Report any defective or missing parts to HPS directly. The HPS dealer you purchased this product from might not have the replacement parts you need.
- Installation requires moderate mechanical skills. A qualified mechanic is highly recommended.
- Do not attempt to install the strut bar while the engine is hot.
- For technical inquiries, please e-mail us at tech@hpsperformanceproducts.com

PLEASE READ CAREFULLY BEFORE INSTALLATION!

This installation is not for the novice customer. Install this product with EXTREME caution! Misuse of this product can destroy your engine and electrical systems! If you are not mechanically inclined, please have a professional automotive mechanic install this kit.

NOTE: HPS holds no responsibility for any damage that results from misuse of this product.

GETTING STARTED

1. Turn the ignition OFF and **disconnect the vehicle's negative battery cable**. If the engine has run within the past two hours let it cool down.

NOTE: Disconnecting the negative battery cable erases pre-programmed electronic memories. Write down all memory settings before disconnecting the negative battery cable. Some radios will require an anti-theft code to be entered after the battery is reconnected. The anti-theft code is typically supplied with your owner's manual. In the event your vehicles' anti-theft code cannot be recovered, contact an authorized dealership to obtain your vehicles anti-theft code. We also highly recommend NOT discarding any stock parts after the installation.



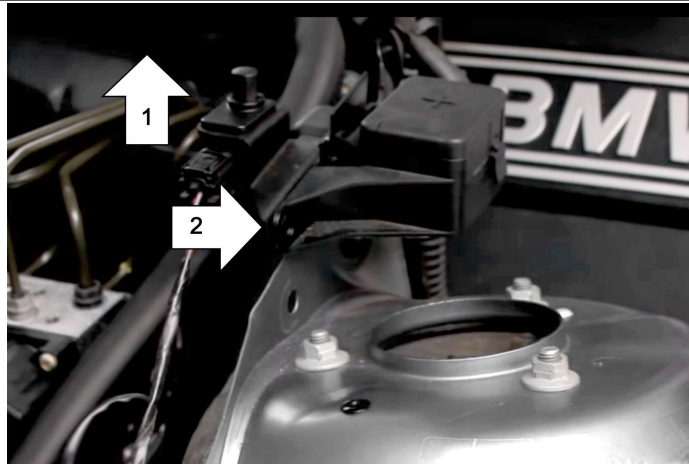

3. Lift up on the hood switch bracket (1) and push the plastic rivet out towards the front of the vehicle (2). Carefully lift the switch/battery terminal assembly up enough to let the strut bar bracket fit underneath.

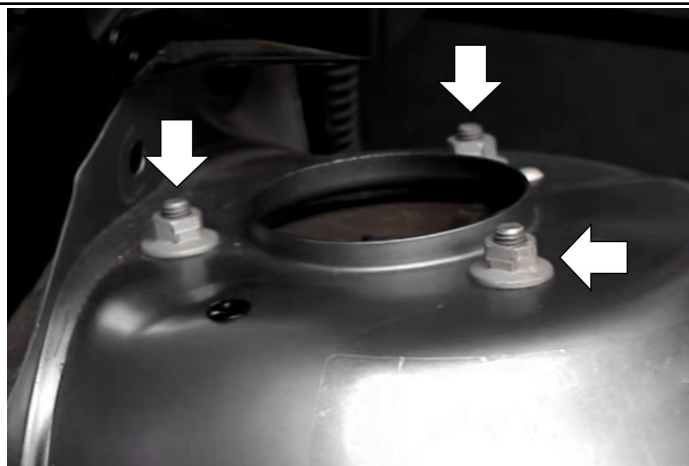

4. Remove the 3 nuts on each of the strut towers. If stock, use a 13mm socket.

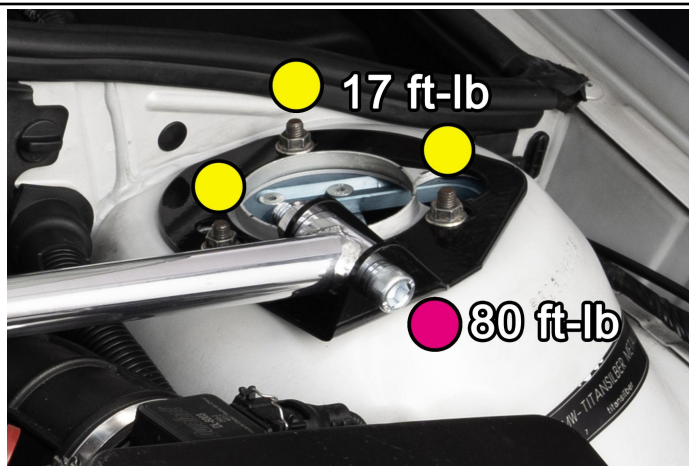

5. Place the strut bar onto the strut tower using the 3 studs on each side to align it into place. Reinstall the 6 nuts that were removed and fasten to 17 ft-lb. Fasten the hardware between the bar and bracket using a 10mm allen key and 18mm wrench and torque to 80 ft-lb.

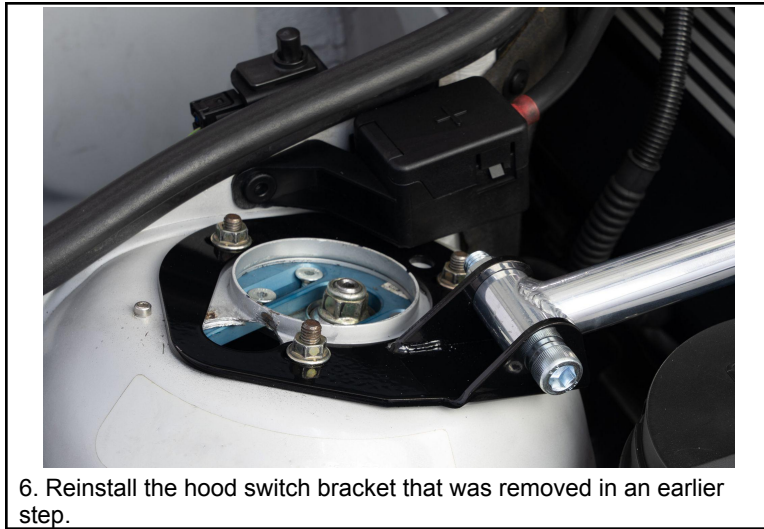

6. Reinstall the hood switch bracket that was removed in an earlier step.

Final Steps

Once the strut bar has been positioned, tighten all of the clamps and secure all of the parts.

Perform a final inspection before driving. Listen carefully for any odd noises or rattles test drive.

A 2-wheel alignment is highly recommended shortly after the installation of the strut bar to ensure proper tire wear.

Periodically, recheck the alignment of the strut bar and make sure there is proper clearance around and along the length of the strut bar. Failure to follow proper maintenance procedures may cause damage to the strut bar and will void the warranty.



ALSO AVAILABLE FOR BMW 3-SERIES E46

**HPS Silicone Radiator + Heater Hose Kit (Black/Blue/Red) with Stainless Steel Clamps
For M52TU and M54 2.5L and 3.0L engines!**



Part Number: 57-1698 - MSRP: \$141

**HPS Silicone Radiator + Heater Hose Kit (Black/Blue/Red) with Stainless Steel Clamps
For M3 S54 3.2L engine!**



Part Number: 57-1543 - MSRP: \$224

Titanium Coolant Bleeder Screw!



Part Number: HW22-1001 - MSRP: \$26