



INSTALLATION INSTRUCTIONS

MAKE: Jeep
MODEL: Wrangler (JK)
YEAR: 2007-2018
ENGINE: V6-3.6L/3.8L (4-Door)

**Cat-Back Hi-Tuck
Aluminized Steel
49-08042-1**

aFe recommends professional installation on our products.

Hanger Rod Assembly

05-41525



Over-Axle Pipe

05-42933

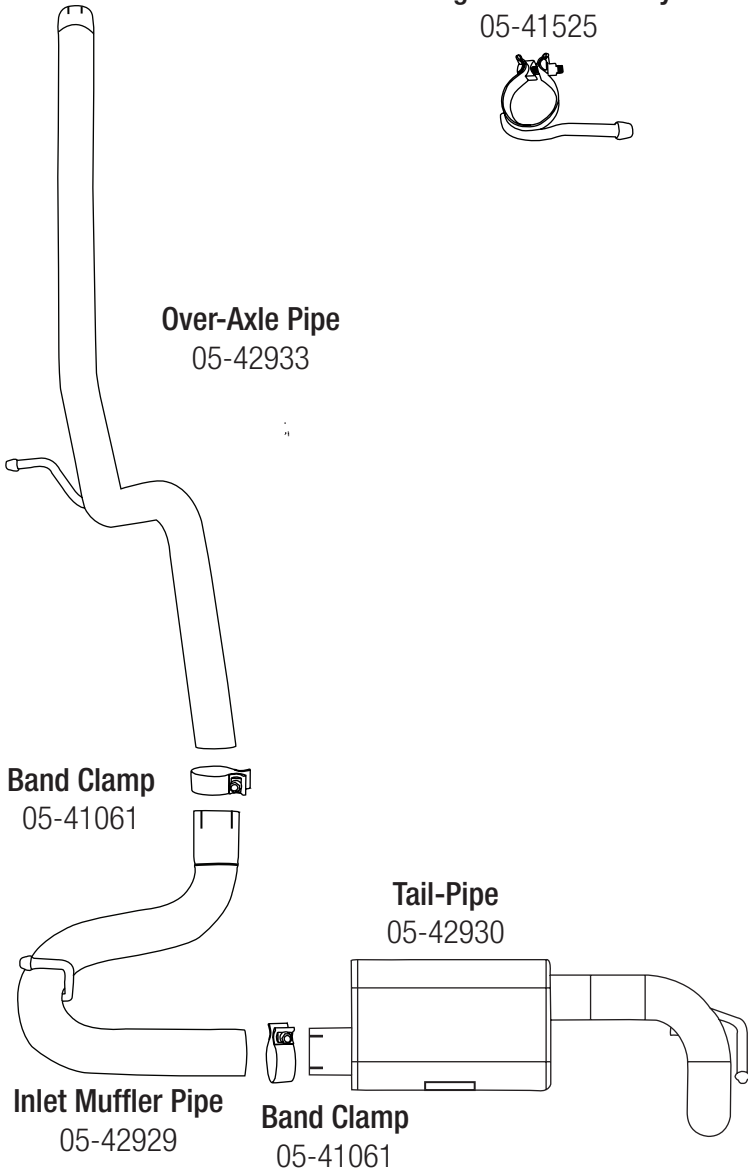

Caution: Allow time for your vehicle to cool down prior to installation. When working on or under your vehicle proceed with caution. Exhaust systems reach high temperatures and may cause serious burns. Wear protective safety equipment; eye goggles and gloves to ensure a safe installation.

Step 1: BEFORE STARTING ANY OF THE STEPS BELOW, ENSURE THAT THE VEHICLE IS COLD AND HAS NOT BEEN RUN FOR A MINIMUM OF 2 HOURS. ALWAYS WEAR EYE PROTECTION WHEN PERFORMING INSTALL.

Step 2: Secure vehicle on jack stands (Refer to your manual for specified jack stand positions).

Step 3: Loosen the band clamp securing the OE muffler to the mid pipe.

Step 4: Remove the muffler off the rubber hanger mounts and then slide off the mid pipe.

Step 5: Loosen the band clamp securing the OE mid pipe to the y-pipe.

Step 6: Remove the OE mid pipe off the rubber hangers and then slide off the y-pipe.

Step 7: Slide the supplied assembly hanger rod over the aFe Mid Pipe (The hanger rod should face the bottom and point left), (x1) supplied 2.5" band clamp and install onto the y-pipe and rubber hanger mounts. Do not tighten the band clamp or hanger rod assembly.

Step 8: Using (x1) supplied 2.5" band clamp, install the aFe Muffler Inlet Pipe onto the Mid Pipe and rubber hanger mount but do not tighten.

Step 9: Using (x1) supplied 2.5" band clamp, install the aFe Muffler Section onto the muffler inlet pipe and rubber hanger mount but do not tighten.

Step 10: Align aFe exhaust system and then tighten all band clamps and hanger rod assembly.

Step 11: Re-check all your work.

Step 12: Remove vehicle off jack stands.

NOTE: It is normal for the aFe Exhaust System to emit smoke for the first few minutes upon initial start-up.