



INSTALLATION INSTRUCTIONS

Cat -Back Exhaust

49-32070

MAKE: Dodge
MODEL: Charger
YEAR: 15-19
ENGINE: V8-6.2L(sc) V8-6.4L

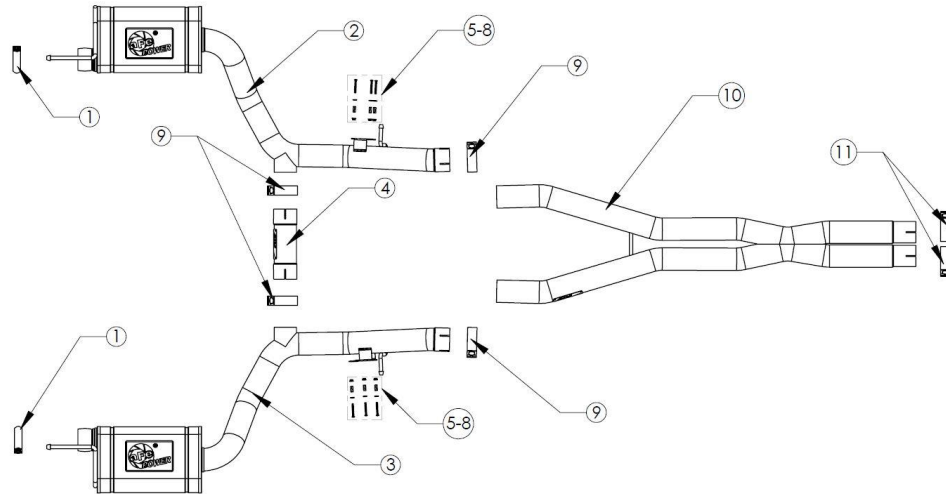
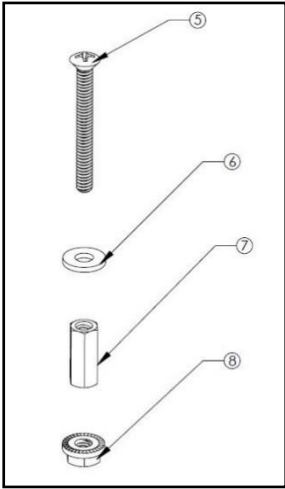

Item	Description	Part Number	Quantity
1	Clamp, Ball Joint	05-41284	2
2	Muffler Assembly Left	05-145876	1
3	Muffler Assembly Right	05-145875	1
4	Muffler Cross Over Tube	05-145153	1
5	Screw, Phil Hd: #10-24x1.75	03-50116	6
6	Washer, Flat: #10, Zn Plt	03-50117	6
7	Nut: 3/4" x 5/16" x 10-24	03-50536	6
8	Locknut, Serrated Flange: 10-24	03-50547	6
9	Clamps, Band 3"	05-41055	4
10	X-Pipe Assembly	05-145718	1
11	Clamp, Band 2-3/4"	05-41160	2

aFe POWER recommends professional installation on this product. Thoroughly inspect the aFe POWER exhaust system to make sure there is no damage from shipping (if damage is noted, immediately contact aFe POWER customer service). Allow time for your vehicle to cool down prior to installation. When working on your vehicle proceed with caution. Wear protective safety equipment; eye goggles and gloves to ensure a safe installation.

Install band clamps to proper torque specifications of 40-45 ft-lb.

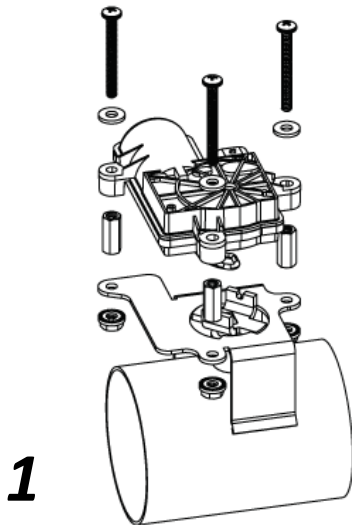



INSTALLATION INSTRUCTIONS

Cat -Back Exhaust

MAKE: Dodge
MODEL: Charger
YEAR: 15-19
ENGINE: V8-6.2L(sc) V8-6.4L

49-32070

1. **(Read instructions prior to installation.)** It is recommended to not fully tighten the exhaust until it has been fully installed. Leave loose for adjustability.
2. Secure vehicle on jack stands (refer to your manual for specified jack stand positions).
3. For faster installation, spread out the parts of the exhaust alongside your vehicle as shown in the diagram above.
4. Secure the stock exhaust with jack/stands.
5. Disconnect the battery.
6. Disconnect the factory ground strap from the muffler hanger on the rear of the OE exhaust system.
7. Remove both cross members.
8. Remove the Right and Left exhaust tips from the OE mufflers.
9. Unplug the wire harness from the right and left exhaust valve actuators.
10. Loosen the band clamps on the OE exhaust system to connection pipes.
11. Remove the rubber isolation mounting brackets from the chassis and remove the OE exhaust system.
12. Remove the exhaust valve actuators from the OE exhaust and install them on the right and left aFe POWER Muffler Assembly using the supplied (x6) Philips Head Screw, (x6) Flat Washer, (x6) $\frac{3}{4}$ " long nut, and (x6) Locknut, see Fig 1. (Make sure you mark the exhaust valve actuators right and left to reinstall them on the correct side)
13. Slide the 2-3/4" band clamps on the aFe POWER X-pipe inlets and install X-pipe onto the OE connection pipes, do not tighten the clamps.
14. Remove the rubber isolation mounts from the OE exhaust and reinstall them onto the aFe POWER Right and Left Muffler Assembly.
15. Slide the 3" band clamps onto the right and left aFe POWER Muffler Assembly inlets, slide the 3" band clamps onto the ends of the Cross Over Tube and slide Cross Over Tube onto the aFe POWER Muffler Assemblies, do not tighten.
16. Install the aFe POWER Muffler Assemblies onto the aFe POWER X-pipe, do not tighten.
17. Reinstall the rubber isolation mounts to the chassis and tighten.
18. Ensure that all the components of the aFe POWER exhaust system are aligned and are at a safe clearance from all wires, hoses, brake lines, body parts, and tires.
19. Once the position of the aFe POWER exhaust system has been determined for proper alignment and clearance, tighten all band clamps.
20. Reinstall the wire harness on the right and left exhaust valve actuators.
21. Reinstall cross members.
22. Install the right and left OE exhaust tips using supplied (x2) Ball Joint Clamp.
23. Reconnect the battery.
24. Start the vehicle and check for any leaks. If any leaks are found, determine cause and repair as necessary.
25. Remove vehicle from jacks stands.
26. It is recommended to re-tighten all clamps and hardware after 50-100 miles.