



INSTALLATION INSTRUCTIONS

Cat-Back Exhaust

MAKE: Nissan
MODEL: Z
YEAR: 2023
ENGINE: V6-3.0L (tt)

49-36138-B
 49-36138-C
 49-36138-L
 49-36138-P

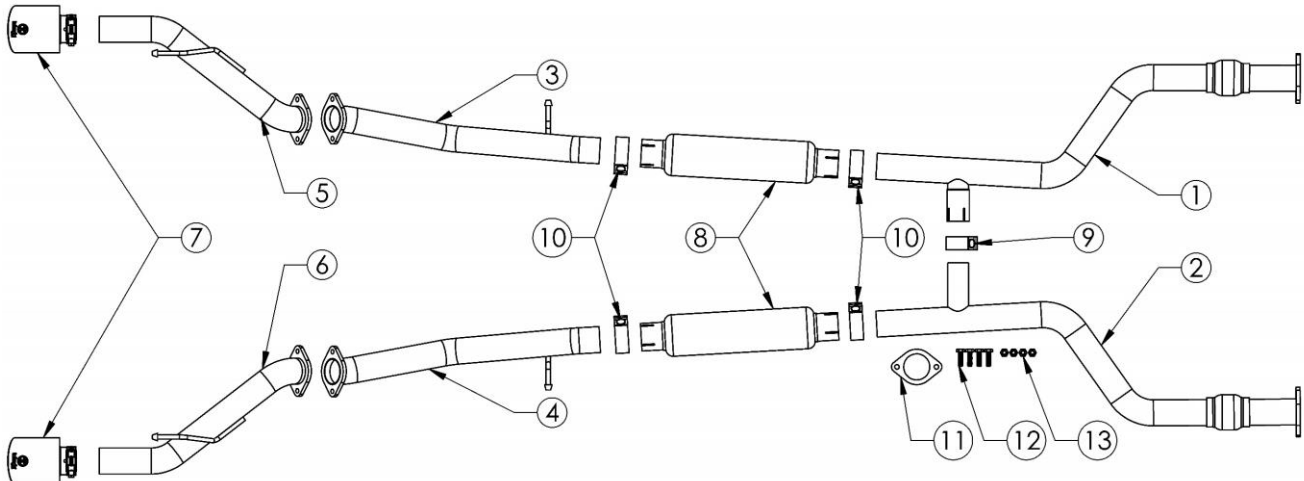

Item	Description	Part Number	Quantity
1	Driver Side Front Pipe	05-245433	1
2	Passenger Side Front Pipe	05-245434	1
3	Driver Side Mid-Pipe	05-245435	1
4	Passenger Side Mid-Pipe	05-245436	1
5	Driver Side Tailpipe	05-245437	1
6	Passenger Side Tailpipe	05-245438	1
7	EXH Tip 2-1/2 In x 4-1/2 Out X 7L Bolt-On Blk	49T25454-B07	2
7	EXH Tip 2-1/2 In x 4-1/2 Out X 7L Bolt-On CF	49T25454-C07	2
7	EXH Tip 2-1/2 In x 4-1/2 Out X 7L Bolt-On Blue	49T25454-L07	2
7	EXH Tip 2-1/2 In x 4-1/2 Out X 7L Bolt-On Pol	49T25454-P07	2
8	Resonator, 4" x 19"	R49-91022	2
9	Clamp, Band: 2"	05-41235	1
10	Clamp, Band: 2-1/2"	05-41061	4
11	Gasket	05-46326	1
12	Bolt, M10 x 1.25	03-50401	4
13	Nut, M10 x 1.25	03-50400	4

aFe POWER recommends professional installation on this product. Thoroughly inspect the aFe POWER exhaust system to make sure there is no damage from shipping (if damage is noted, immediately contact aFe POWER customer service). Allow time for your vehicle to cool down prior to installation. When working on your vehicle proceed with caution. Wear protective safety equipment; eye goggles and gloves to ensure a safe installation.

Install band clamps to proper torque specifications of 40-45 ft-lb.

Install V-band clamps with anti-seize lubricant and hand tighten only to torque specifications of 10-15 ft-lb.



INSTALLATION INSTRUCTIONS

MAKE: Nissan
MODEL: Z
YEAR: 2023
ENGINE: V6-3.0L (tt)

Cat-Back Exhaust

49-36138-B
49-36138-C
49-36138-L
49-36138-P

1. **(Read instructions prior to installation.)** It is recommended to not fully tighten the exhaust until it has been fully installed. Leave loose for adjustability.
2. Secure vehicle on jack stands (refer to your manual for specified jack stand positions).
3. For faster installation, spread out the parts of the exhaust alongside your vehicle as shown in the diagram above.
4. Secure the stock exhaust with jack/stands.
5. Remove the O.E. Hardware from the flanges in the O.E. Rear Muffler Section. Remove the rear Muffler Hangers from the Rubber Isolation Mounts.
6. Remove the O.E. Rear Muffler Section from the Vehicle.
7. Remove the (x4) Nuts and Bolts from the Front Flanges after the Catalytic Converters. Retain hardware for installation.
8. Unbolt the O.E Hanger Brackets located in the O.E. Mid-Pipe Section. Remove the remainder of the exhaust from the vehicle.
9. Install the TAKEDA Driver Side Front Pipe using the O.E. Hardware.
10. Install the TAKEDA Passenger Side Front Pipe using the O.E. Hardware. Slide the H-Pipe tube into the TAKEDA Driver Side Front Pipe and secure with the provided 2" Band Clamp.
11. Slide the TAKEDA Resonator into the TAKEDA Driver Side Front Pipe and secure with the provided 2.5" Band Clamp.
12. Slide the TAKEDA Resonator into the TAKEDA Passenger Side Front Pipe and secure with the provided 2.5" Band Clamp.
13. Remove the O.E. Hanger Brackets from the O.E. Mid-Pipe and transfer them over to the TAKEDA Driver Side Mid-Pipe and TAKEDA Passenger Side Mid-Pipe.
14. Slide the TAKEDA Driver Side Mid-Pipe into the TAKEDA Resonator and secure with the provided 2.5" Band Clamp. Bolt the O.E. Hanger Bracket to the Chassis.
15. Slide the TAKEDA Passenger Side Mid-Pipe into the TAKEDA Resonator and secure with the provided 2.5" Band Clamp. Bolt the O.E. Hanger Bracket to the Chassis.
16. Install the TAKEDA Driver Side Tailpipe to the TAKEDA Driver Side Mid-Pipe using the provided Gasket, (x2) Nuts, and (x2) Bolts. Slide Hangers into O.E. Rubber Isolation Mounts.
17. Install the TAKEDA Passenger Side Tailpipe to the TAKEDA Passenger Side Mid-Pipe using the provided Gasket, (x2) Nuts, and (x2) Bolts. Slide Hangers into O.E. Rubber Isolation Mounts.
18. Install TAKEDA Exhaust Tips.
19. Ensure that all the components of the TAKEDA exhaust system are aligned and are at a safe clearance from all wires, hoses, brake lines, body parts, and tires.
20. Start from the front of the aFe exhaust system and evenly tighten all clamps and fasteners.
21. Start the vehicle and check for any leaks. If any leaks are found, determine cause and repair as necessary.
22. Remove vehicle from jacks stands.
23. It is recommended to re-tighten all clamps and hardware after 50-100 miles.