

MAKE: SUBARU
MODEL: CROSS-TREK
YEAR: 2018-2019
ENGINE: H4-2.0L

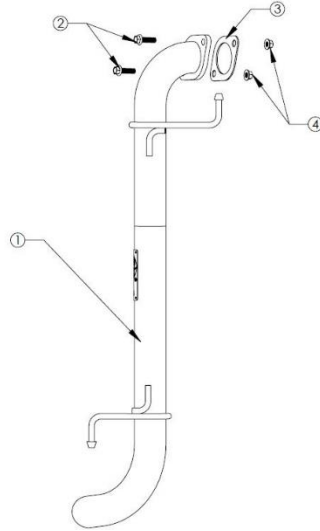

Item	Description	Part Number	Quantity
1	Tail Pipe Assembly	05-145696	1
2	Screw, Socket Head Cap: 7/16-14 x 1" S/S	03-50415	2
3	Gasket, Exhaust 2-Bolt: 3.00 ID x 4.00 BC	05-46300	1
4	Nut, Flange 7/16 - 14	03-50208	2

aFe recommends professional installation on this product. Thoroughly inspect the aFe exhaust system to make sure there is no damage from shipping (if damage is noted, immediately contact aFe customer service). Allow time for your vehicle to cool down prior to installation. When working on your vehicle proceed with caution. Wear protective safety equipment; eye goggles and gloves to ensure a safe installation.

Install band clamps to proper torque specifications of 40-45 ft-lb





INSTALLATION INSTRUCTIONS

Axle-Back Exhaust

49-36802

MAKE: SUBARU
MODEL: CROSS-TREK
YEAR: 2018-2019
ENGINE: H4-2.0L

1. **(Read instructions prior to installation.)** It is recommended to not fully tighten the exhaust until it has been fully installed. Leave loose for adjustability.
2. Secure vehicle on jack stands (refer to your manual for specified jack stand positions).
3. For faster installation, spread out the parts of the exhaust alongside your vehicle as shown in the diagram above.
4. Secure the stock exhaust with jack/stands.
5. Remove the OE muffler by unbolting it from the first flanged joint and removing it from the rubber isolation mounts.
6. Using the provided gasket and bolts/nuts, install the tailpipe assembly and slide it into the rubber isolation mount.
7. Ensure that all the Takeda exhaust system is aligned.
8. Tighten down all fasteners.
9. Start the vehicle and check for any leaks. If any leaks are found, determine cause and repair as necessary.
10. Remove vehicle from jacks stands.
11. It is recommended to re-tighten all clamps and hardware after 50-100 miles