

MAKE: SUBARU
MODEL: CROSS-TREK
YEAR: 2018-2019
ENGINE: H4-2.0L

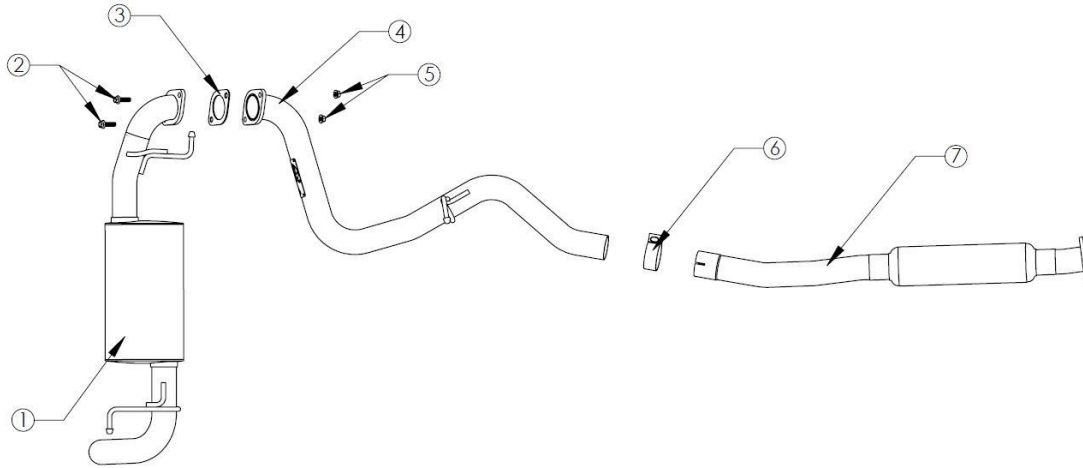

Item	Description	Part Number	Quantity
1	Muffler Assembly	05-145695	1
2	Screw, Socket Head Cap: 7/16-14 x 1" S/S	03-50415	2
3	Gasket, Exhaust 2-Bolt: 3.00 ID x 4.00 BC	05-46300	1
4	Mid Pipe Assembly	05-145694	1
5	Nut, Flange 7/16 - 14	03-50208	2
6	Clamp, Band: 2-1/2"	05-41061	1
7	Resonated Pipe Assembly	05-145693	1

aFe recommends professional installation on this product. Thoroughly inspect the aFe exhaust system to make sure there is no damage from shipping (if damage is noted, immediately contact aFe customer service). Allow time for your vehicle to cool down prior to installation. When working on your vehicle proceed with caution. Wear protective safety equipment; eye goggles and gloves to ensure a safe installation.

Install band clamps to proper torque specifications of 40-45 ft-lb





INSTALLATION INSTRUCTIONS

Cat-Back Exhaust

49-36803

MAKE: SUBARU
MODEL: CROSS-TREK
YEAR: 2018-2019
ENGINE: H4-2.0L

1. **(Read instructions prior to installation.)** It is recommended to not fully tighten the exhaust until it has been fully installed. Leave loose for adjustability.
2. Secure vehicle on jack stands (refer to your manual for specified jack stand positions).
3. For faster installation, spread out the parts of the exhaust alongside your vehicle as shown in the diagram above.
4. Secure the stock exhaust with jack/stands.
5. Unbolt the (x2) bolts and nuts on the OE muffler that holds the muffler to the mid pipe.
6. Remove the rubber isolation mount from the chassis and remove the OE muffler.
7. Unbolt the (x2) bolts and nuts holding the OE mid pipe to OE converter pipes.
8. Remove the rubber isolation mount from the chassis and remove the OE mid pipe.
9. Remove the rubber isolation mounts from the OE exhaust and reinstall them onto the TAKEDA exhaust system.
10. Install the TAKEDA exhaust system resonated pipe assembly to the OE converter pipes using the original bolts / gasket but do not tighten.
11. Install the TAKEDA mid pipe assembly onto the resonated pipe assembly using the (x1) supplied 2.5" band clamp, but do not tighten.
12. Install the TAKEDA muffler assembly onto the mid pipe assembly using the (x2) supplied gasket and bolts/nuts, but do not tighten.
13. Ensure that all the components of the Takeda exhaust system are aligned.
14. Start from the front of the Takeda exhaust system and evenly tighten all clamps and fasteners.
15. Start the vehicle and check for any leaks. If any leaks are found, determine cause and repair as necessary.
16. Remove vehicle from jacks stands.
17. It is recommended to re-tighten all clamps and hardware after 50-100 miles.