

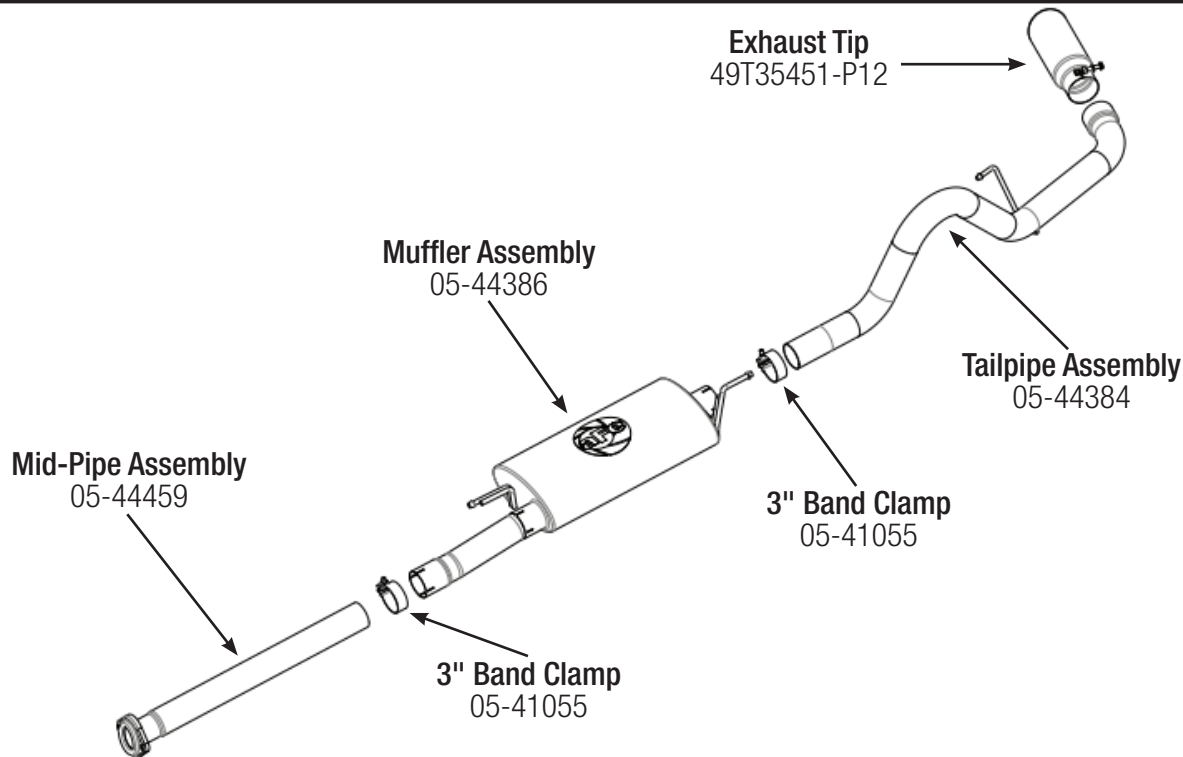

INSTALLATION INSTRUCTIONS

MAKE: Ford
MODEL: F-150
YEAR: 2011 - 2014
ENGINE: V8-5.0L

Cat-Back Exhaust
49-43033



Caution: aFe recommends professional installation on our products. Allow time for your vehicle to cool down prior to installation. When working on or under your vehicle proceed with caution. Exhaust systems reach high temperatures and may cause serious burns. Wear protective safety equipment; eye goggles and gloves to ensure a safe installation.

Step 1: (Read Instructions prior to installation) Remove your stock exhaust up to the catalytic converter from the rear of your truck working your way forward. Take caution not to damage the factory hardware and isolation mounts as they will be reused. **It is recommended to not fully tighten the clamps until the entire system has been installed.**

Step 2: For faster installation spread the pieces of the exhaust along side of your vehicle according to the diagram shown.

Step 3: Install mid-pipe using factory hardware. For 144.5" wheelbase, use as is. For 125.9" wheelbase it will require cutting at the rear end. Cut on the end that is not reduced to fit shorter wheelbase, test fit prior to cutting. Cut 18" for 125.9" wheelbase.

Step 4: Slip band clamp over expanded end of mid-pipe/muffler assembly prior to installation.

Step 5: Utilizing the factory isolation mounts now install over-axle/tailpipe and tighten all band clamps from front to rear

Step 6: Once aligned and you're satisfied, you may now tighten complete system.

Step 7: Double check all work and ensure everything is tight Congratulations, your system is now complete and full.

Step 8: Installed! It is recommended to re-tighten all clamps and bolts after 50-100 miles.