

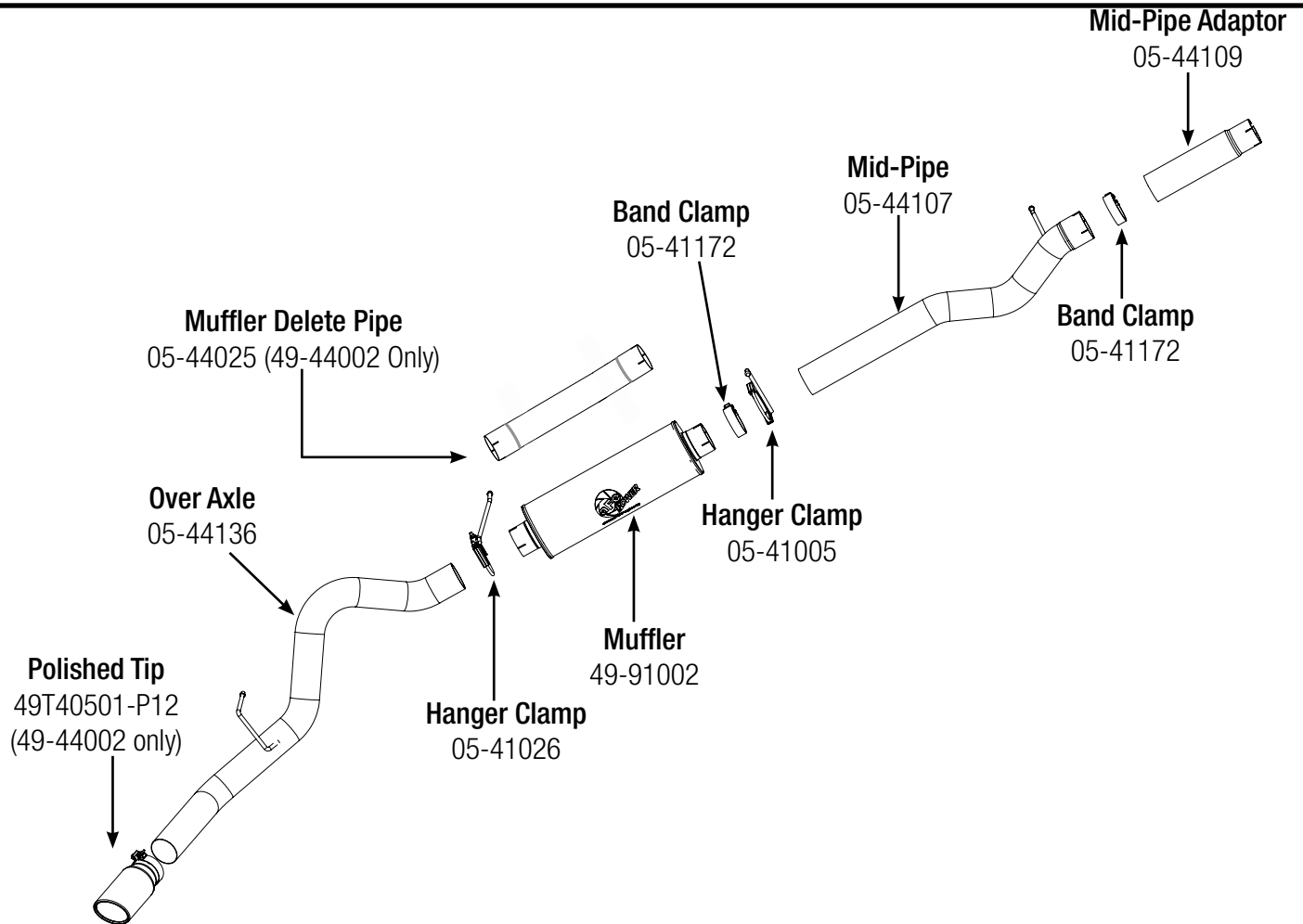

INSTALLATION INSTRUCTIONS

MAKE: GM
MODEL: Silverado HD/Sierra HD
YEAR: 2006-2007
ENGINE: V8-6.6L (td) Duramax
WHEELBASE: All

4" Cat-Back
49-14002 (w/ Muffler & No Tip)
49-44002 (w/ Muffler & Polished Tip)



Step 1: (Read Instructions prior to installation) Remove your stock exhaust up to the catalytic converter from the rear of your truck working your way forward. It may be necessary to cut the pipes if the slip joints are stuck. Take caution not to damage the factory isolation mounts as they will be reused.

It is recommended to not fully tighten the clamps until the entire system has been installed.

Step 2: For faster installation spread the pieces of the exhaust along side of your vehicle according to the diagram shown.

Step 3: Install the mid-pipe adaptor. Slip band clamp over expanded end of the mid-pipe prior to installation.

Now install the mid-pipe, it will require cutting at the muffler end to fit shorter wheel bases. Test fit prior to cutting.

Step 4: Slip band clamp over expanded end of muffler prior to installation. Now install muffler onto mid-pipe.

Step 5: Install the hanger clamp using the factory isolation mounts prior to installation of over-axle/tailpipe. Utilizing the factory isolation mounts now install over-axle/tailpipe and tighten clamp. Make sure to tighten all clamps from front to rear.

Step 6: (For kit 49-44002: Install the exhaust tip and tighten.) Your installation is now complete.

It is recommended to re-tighten all parts after 50-100 miles.

NOTES:

- aFe recommends that the tailpipe be at least 1/2"-1" away from any body panels to avoid heat related body damage. **Tighten and secure.**

Caution: Allow time for your vehicle to cool down prior to installation. When working on or under your vehicle proceed with caution. Exhaust systems reach high temperatures and may cause serious burns. Wear protective safety equipment; eye goggles and gloves to ensure a safe installation. **aFe recommends professional installation on our products.**