



INSTALLATION INSTRUCTIONS

DPF-Back Exhaust

MAKE: GM
MODEL: Silverado HD/ Sierra HD
YEAR: 2020
ENGINE: V8-6.6L (td) Duramax (L5P)

49-44126-P
 49-44126-B

See Table on Page 2 for Fitment

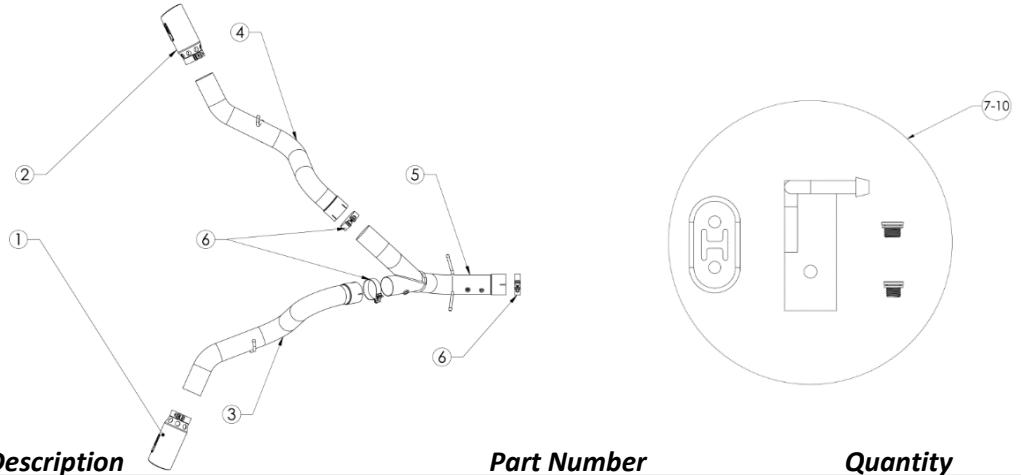

Item	Description	Part Number	Quantity
1	EXH Tip 4 In x 5 Out, 12L, Rolled I/C, Blk	49T40501-B121	1
1	EXH Tip 4 In x 5 Out, 12L, Rolled I/C, Pol	49T40501-P121	1
2	EXH Tip 4 In x 5 Out, 12L, Rolled I/C, Blk	49T40502-B121	1
2	EXH Tip 4 In x 5 Out, 12L, Rolled I/C, Pol	49T40502-P121	1
3	S/A Tube, Tailpipe PS	05-144976	1
4	S/A Tube Tailpipe DS	05-144977	1
5	S/A Tube, Y-pipe	05-144975	1
6	Clamp, Band: 4" (SS)	05-41172	3
7	Exhaust Isolation Mount	05-46050	1
8	S/A Clamp Hanger	05-410416	1
9	Plug Threaded: M16 x 1.5	05-46019	1
10	Plug Threaded: M14 x 1.5	05-46020	1
11	Washer, Split Lock: 1/2	03-50435	1
12	Screw, Hex Cap: 1/2-13 x 1.5 Gr. 8	03-50439	1
13	Nut, Hex: 1/2-13, Gr. 5	03-50441	1

aFe POWER recommends professional installation on this product. Thoroughly inspect the aFe POWER exhaust system to make sure there is no damage from shipping (if damage is noted, immediately contact aFe POWER customer service). Allow time for your vehicle to cool down prior to installation. When working on your vehicle proceed with caution. Wear protective safety equipment; eye goggles and gloves to ensure a safe installation.

Install band clamps to proper torque specifications of 40-45 ft-lb.





INSTALLATION INSTRUCTIONS

DPF-Back Exhaust

MAKE: GM
MODEL: Silverado HD/ Sierra HD
YEAR: 2020
ENGINE: V8-6.6L (td) Duramax (L5P)

49-44126-P
 49-44126-B

See Table on Page 2 for Fitment

- (Read instructions prior to installation.)** It is recommended to not fully tighten the exhaust until it has been fully installed. Leave loose for adjustability.
- Secure vehicle on jack stands (refer to your manual for specified jack stand positions).
- For faster installation, spread out the parts of the exhaust alongside your vehicle as shown in the diagram above.
- Secure the stock exhaust with jack/stands.
- Remove NOX sensor.
- If your install is for a Crew/Cab Long-Bed 172" wheelbase or Double/Cab Long-Bed do not remove the EGT sensor or the EPD sensor. All other wheelbase and cab configurations must remove all sensors from tail-pipe section.
- Using a visible ink; measure the correct inches indicated below. From the rear weld line of the DPF (Diesel Particulate Filter) place a mark as shown in the table below

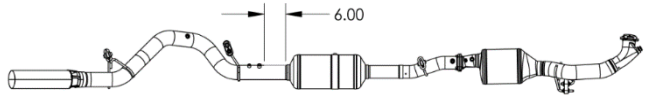
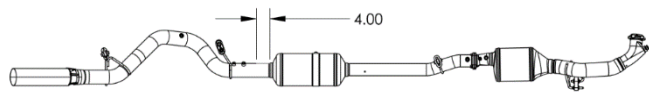
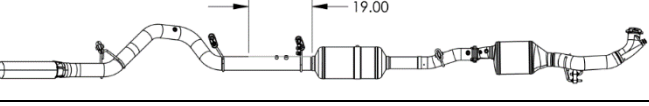
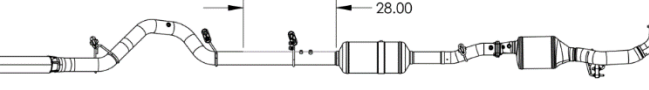
CAB Configuration	Wheelbase	Cut Lengths	Image
Double/Cab Short-Bed	149.4	6"	
Crew/Cab Short-Bed	158.9"	4"	
Double/Cab Long-Bed	162.4"	19"	
Crew/Cab Long-Bed	172"	28"	

- Cutting will be done under vehicle, make sure support stands are supporting weight before cutting stock exhaust. Remove the rear tail-pipe section after it has been cut.
- Install Y-pipe using the provided 4" band clamp and slide hangers into O.E. Isolation mount.
- Install (passenger) right side Tailpipe onto the Y-pipe Using the Provided 4" band clamp. Slip hanger into the O.E Isolation mount.
- Remove the stock Bolt on the Driver's side Tow Package to Install (HANGER BRACKET 05-410417) Use the O.E Bolt, the provide bolt, nut and lock washer, and the Provided O.E Isolator to tighten the bracket back in place.
- Install (Driver) left side Tailpipe onto Y-pipe using the provided 4" band clamp. Slip hanger into the rubber isolation mount. NOTE: You will need to loosen the undercarriage spare tire. Push the spare tire away as far as possible to lean against the heat shield on the passenger side. This will allow more clearance between left side tube and the spare tire from rubbing against each other and avoiding any heat damage. Once the clearance has been satisfied tighten the spare tire back up.



INSTALLATION INSTRUCTIONS

MAKE: GM
MODEL: Silverado HD/ Sierra HD
YEAR: 2020
ENGINE: V8-6.6L (td) Duramax (L5P)

DPF-Back Exhaust

49-44126-P

49-44126-B

See Table on Page 2 for Fitment

13. Place tips at desired position with aFe badge logo facing the rear of truck.
14. Begin to align all exhaust components and fully tighten down all band clamps and tips. Zip ties and heat shield adhesive is included. Only use them if it necessary around the brake line cables and hoses from the axle on the driver side as shown.
15. Ensure that all the components of the aFe POWER exhaust system are aligned and are at a safe clearance from all wires, hoses, brake lines, body parts, and tires.
16. Start from the front of the aFe exhaust system and evenly tighten all clamps and fasteners.
17. Start the vehicle and check for any leaks. If any leaks are found, determine cause and repair as necessary.
18. Remove vehicle from jacks stands.
19. It is recommended to re-tighten all clamps and hardware after 50-100 miles.