

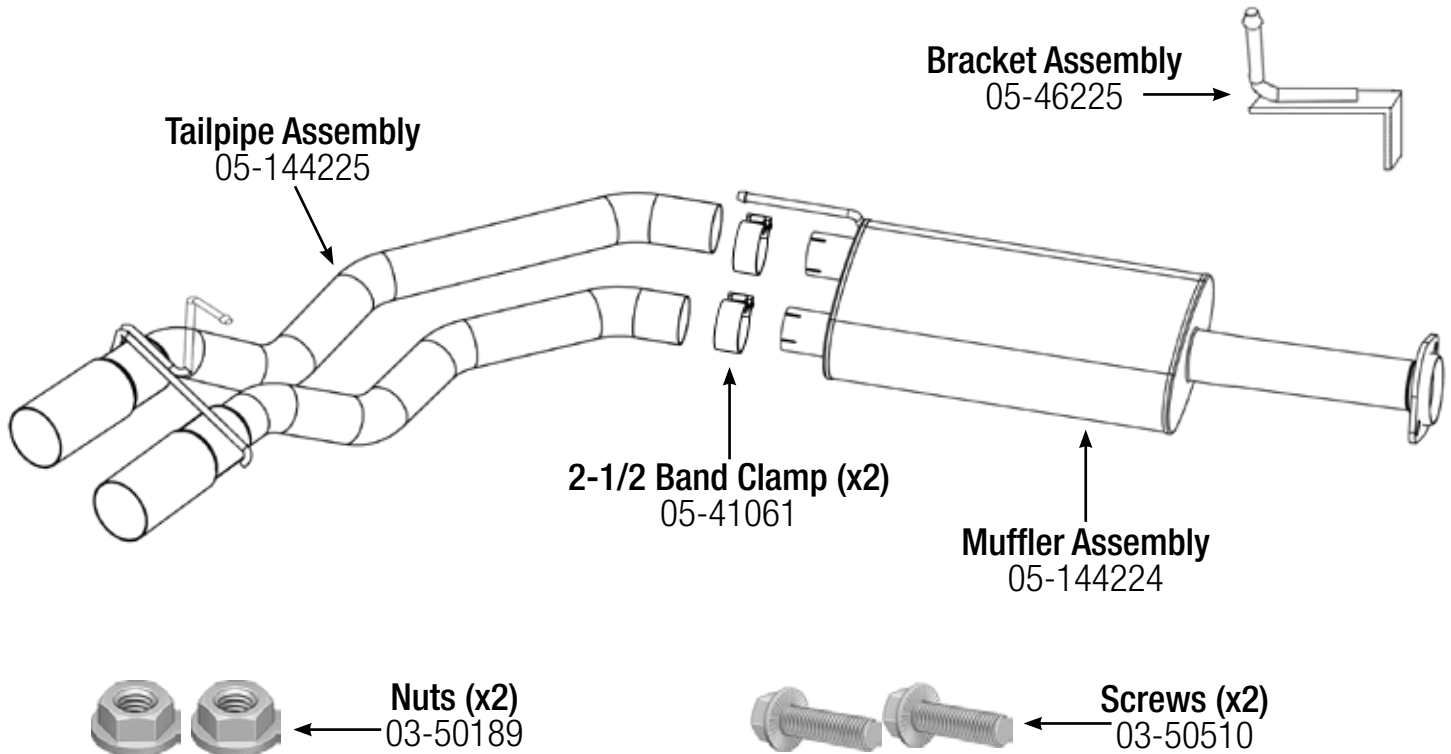

INSTALLATION INSTRUCTIONS

MAKE: Toyota
MODEL: Tacoma
YEAR: 2016 - 2020
ENGINE: V6-3.5L

Cat-Back Exhaust
49-46032-B (Black Tips)
49-46032-P (Polished Tips)



Caution: aFe recommends professional installation on our products. Allow time for your vehicle to cool down prior to installation. When working on or under your vehicle proceed with caution. Exhaust systems reach high temperatures and may cause serious burns. Wear protective safety equipment; eye goggles and gloves to ensure a safe installation.

- Step 1: (Read instructions prior to installation.)** Remove your stock exhaust up to the catalytic converter from the rear of your vehicle, working your way forward. Take caution not to damage the factory hardware and isolation mounts as they will be reused. (It is recommended not to fully tighten the clamps until the entire system has been installed.)
- Step 2:** For faster installation spread the pieces of the exhaust alongside of your vehicle according to the diagram shown.
- Step 3:** Install the muffler assembly onto the stock y-pipe using the stock bolts, gaskets, and factory isolation mounts. (Use a jack stand to support the muffler assembly.)
- Step 4:** Install the provided hanger bracket using the provided hardware and one of the factory isolation mounts. Make sure to loosen the brake cable bracket, and tuck the brake cable over the hanger bracket. Then retighten Brake cable bracket. **(See reference photo A).**
- Step 5:** Install the provided 2-1/2" band clamps onto the end of the muffler assembly, then slide in the tailpipe assembly and install onto the provided hanger bracket using the stock isolation mount.
- Step 6:** Adjust and align the exhaust system to desired position. You can now begin to tighten down the exhaust starting from the front flange working your way back.
- Step 7:** Your installation is now complete. It is recommended to retighten all exhaust components after 50-100 miles.



Reference Photo A