



# INSTALLATION INSTRUCTIONS

**MAKE:** Toyota  
**MODEL:** Tacoma  
**YEAR:** 16-20  
**ENGINE:** 3.5L

**Cat-Back Exhaust**  
49-46046

Fits 127.4" AWD and  
140.6" Wheelbases

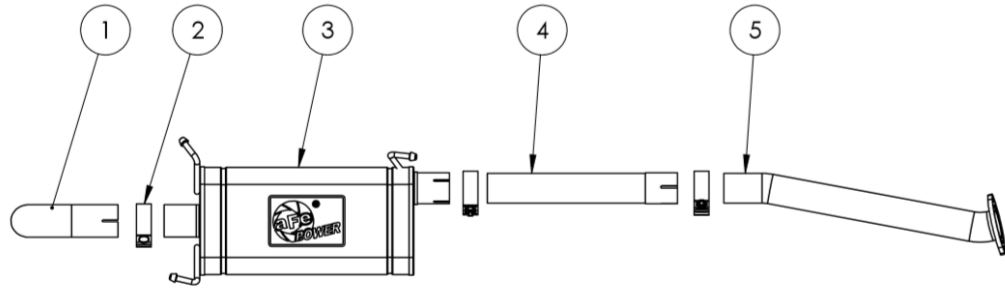

<i>Item</i>	<i>Description</i>	<i>Part Number</i>	<i>Quantity</i>
1	2-1/2" Polished Clamp on Tip	49T25254-P09	1
2	2-1/2" Band Clamp	05-41061	3
3	Muffler Assembly	05-144934	1
4	Extension Pipe	05-144230	1
5	Mid Pipe Assembly	05-144229	1

**aFe POWER recommends professional installation on this product.** Thoroughly inspect the aFe POWER exhaust system to make sure there is no damage from shipping (if damage is noted, immediately contact aFe POWER customer service). Allow time for your vehicle to cool down prior to installation. When working on your vehicle proceed with caution. Wear protective safety equipment; eye goggles and gloves to ensure a safe installation.

Install band clamps to proper torque specifications of 40-45 ft-lb.

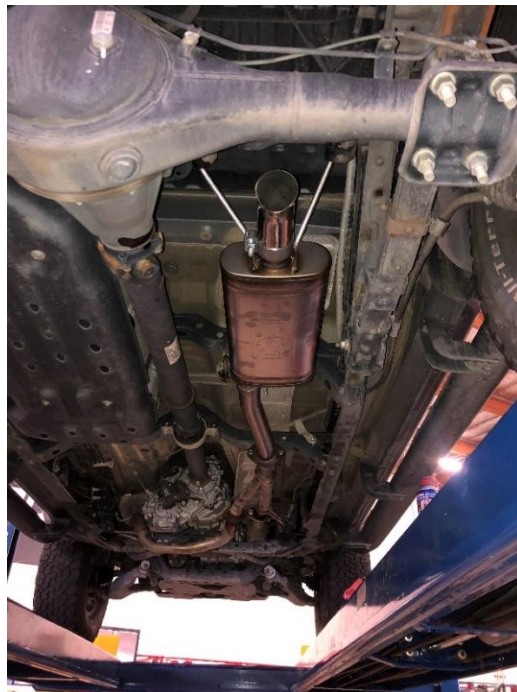



## INSTALLATION INSTRUCTIONS

**MAKE:** Toyota  
**MODEL:** Tacoma  
**YEAR:** 16-20  
**ENGINE:** 3.5L

**Cat-Back Exhaust**

49-46046

Fits 127.4" AWD and  
140.6" Wheelbases

---

1. **(Read instructions prior to installation.)** It is recommended to not fully tighten the exhaust until it has been fully installed. Leave loose for adjustability.
2. Secure vehicle on jack stands (refer to your manual for specified jack stand positions).
3. For faster installation, spread out the parts of the exhaust alongside your vehicle as shown in the diagram above.
4. Secure the stock exhaust with jack/stands.
5. Remove the (x2) 14mm bolts securing the OE exhaust to the OE Y-Pipe.
6. Using a pry-bar or a hanger rod tool remove the (x4) hanger rods from the OE isolation mounts.
7. Install the aFe Power Front-Pipe using the (x2) OE 14mm bolts and OE gasket.
8. For the 127.4 Wheelbase, it does not use extension pipe. For the 140.6 Wheelbase Install 2.5" band clamp onto the extension and slide the extension pipe onto the mid-pipe.
9. Install the aFe Muffler Assembly by sliding the hanger rods onto the OE isolation mounts and using the provided 2.5" Band Clamp along with the aFe Polished Turn Down Tip.
10. Ensure that all the components of the aFe POWER exhaust system are aligned and are at a safe clearance from all wires, hoses, brake lines, body parts, and tires.
11. Start from the front of the aFe exhaust system and evenly tighten all clamps and fasteners.
12. Start the vehicle and check for any leaks. If any leaks are found, determine cause and repair as necessary.
13. Remove vehicle from jacks stands.
14. It is recommended to re-tighten all clamps and hardware after 50-100 miles.