

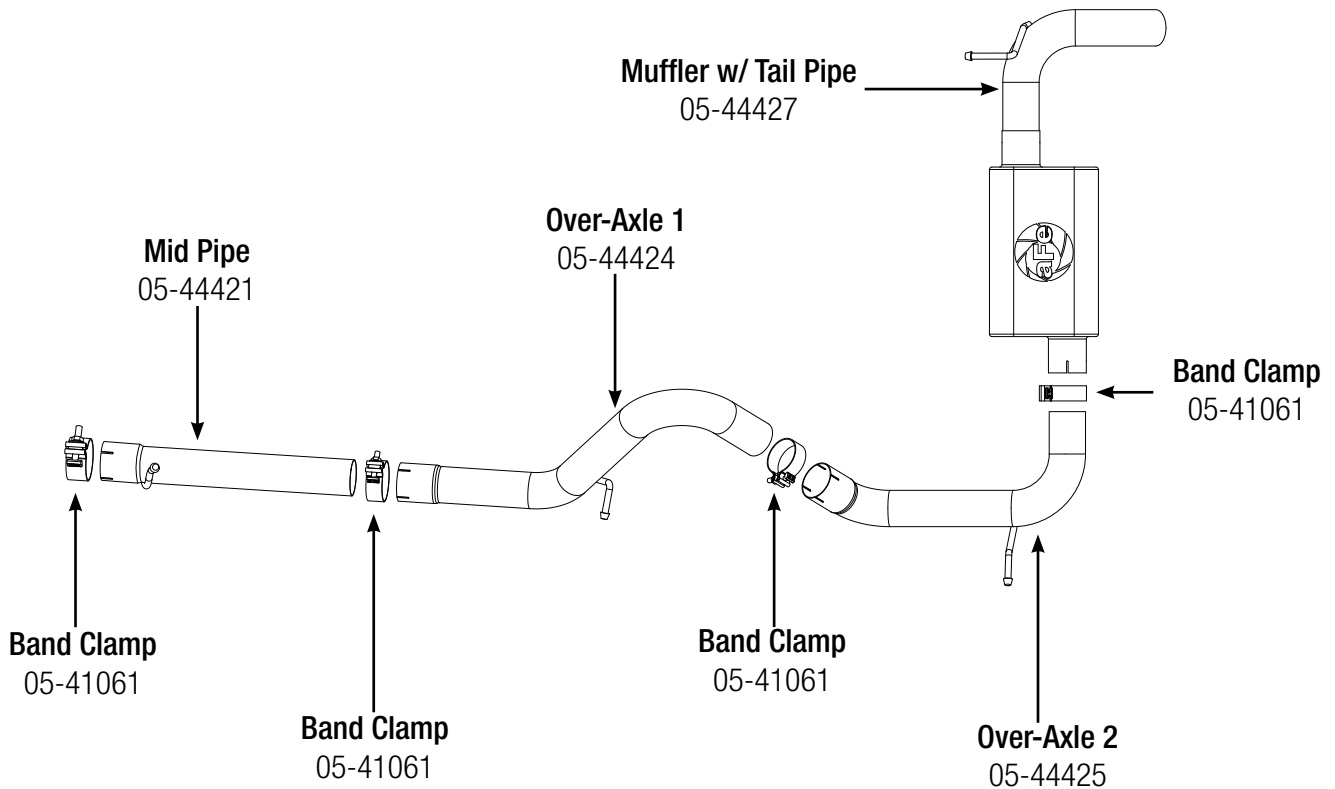

## INSTALLATION INSTRUCTIONS

MAKE: Jeep  
MODEL: Wrangler Unlimited JK  
YEAR: 2007-2011  
ENGINE: V6-3.8L  
WHEELBASE: 95.4"

**2.5" Cat-Back Exhaust  
Hi-Tuck  
49-46208 (409 SS)  
FITS 2-DOOR ONLY**



**Step 1: (Read Instructions prior to installation)** Remove your stock exhaust from the rear of your truck working your way forward. Take caution not to damage the factory isolation mounts as they will be reused. It may be helpful to lubricate the isolation mounts prior to disassembly. **It is recommended to not fully tighten the clamps until the entire system has been installed.**

**Step 2:** For faster installation spread the pieces of the exhaust along side of your vehicle according to the diagram shown.

**Step 3:** Install mid-pipe with 2-1/2" band clamp to cat-side utilizing the factory isolation mount. With 2-1/2" band clamp, install over-axle 1, utilizing the factory isolation mount.

**Step 4:** With 2-1/2" band clamp, install over-axle 2 utilizing the factory isolation mount. With 2-1/2" band clamp install muffler with tailpipe to the factory isolation mount. Make sure all pieces match up to drawing above.

**Step 5:** Now tighten all clamps. Your installation is now complete. aFe recommends to re-tighten all parts after 50-100 miles. Check periodically.

### NOTES:

- aFe recommends that the tailpipe be at least 1/2"-1" away from any body panels to avoid heat related body damage. **Tighten and secure.**
- Controller/Programmers are required to operate this system. Extra sensor bungs are included and need to be welded in place if your programmer requires sensors.

**Caution:** Allow time for your vehicle to cool down prior to installation. When working on or under your vehicle proceed with caution. Exhaust systems reach high temperatures and may cause serious burns. Wear protective safety equipment; eye goggles and gloves to ensure a safe installation. **aFe recommends professional installation on our products.**