

GT
MOMENTUM

advanced FLOW engineering

Cold Air Intake System

Instruction Manual P/N: 50-70125D / 50-70125R

Make: **Dodge**

Model: **Challenger**

Year: **2011-2023**

Engine: **V8-6.4L (w/ Shaker Hood)**



- Please read the entire instruction manual before proceeding.
- Ensure all components listed are present.
- If you are missing any of the components, call customer support at 951-493-7185.
- Ensure you have all necessary tools before proceeding.
- Do not attempt to work on your vehicle when the engine is hot.
- Retain factory parts for future use.

Label	Qty.	Description	Part Number
A	1	Air Filter (Pro 5R) For 50-70125R	24-91136
A	1	Air Filter (Pro DRY S) For 50-70125D	21-91136
B	1	Tube, Rotomold: 50-70125	05-5070125B1
C	1	Housing, Rotomold: 50-70125/70126	05-5070126B2
D	1	Clamp, 064 (3-9/16" - 4-1/2")	03-50006
E	1	Clamp, 056 (3-1/16" - 4")	03-50009
F	1	Grommet, Rubber	03-50167
G	1	Seal, Trim 20.5" Length	05-00072
H	1	Plug, Polyurethane	05-01361
J	1	Fitting, Air Temp Sensor	05-01454
K	1	Hose, Silicone Breather: 5/8" ID, Black 6.5" Length	05-01502
M	1	Coupler, Silicone Bellow: (3.90x3.5")ID x 2.35"L	05-01555

Installation will require the following tools:

8mm and 10mm Nut Drivers or Ratchet and Sockets, 10mm Combination or Ratcheting Wrench, Flat Head Screwdriver, Pry Tool.

Warranty Information available at: <https://afepower.com/contact#warranty>

Emissions Disclaimer: This product is not currently CARB exempt and is not available for purchase in California or for use on any vehicle registered with the California Department of Motor Vehicles.

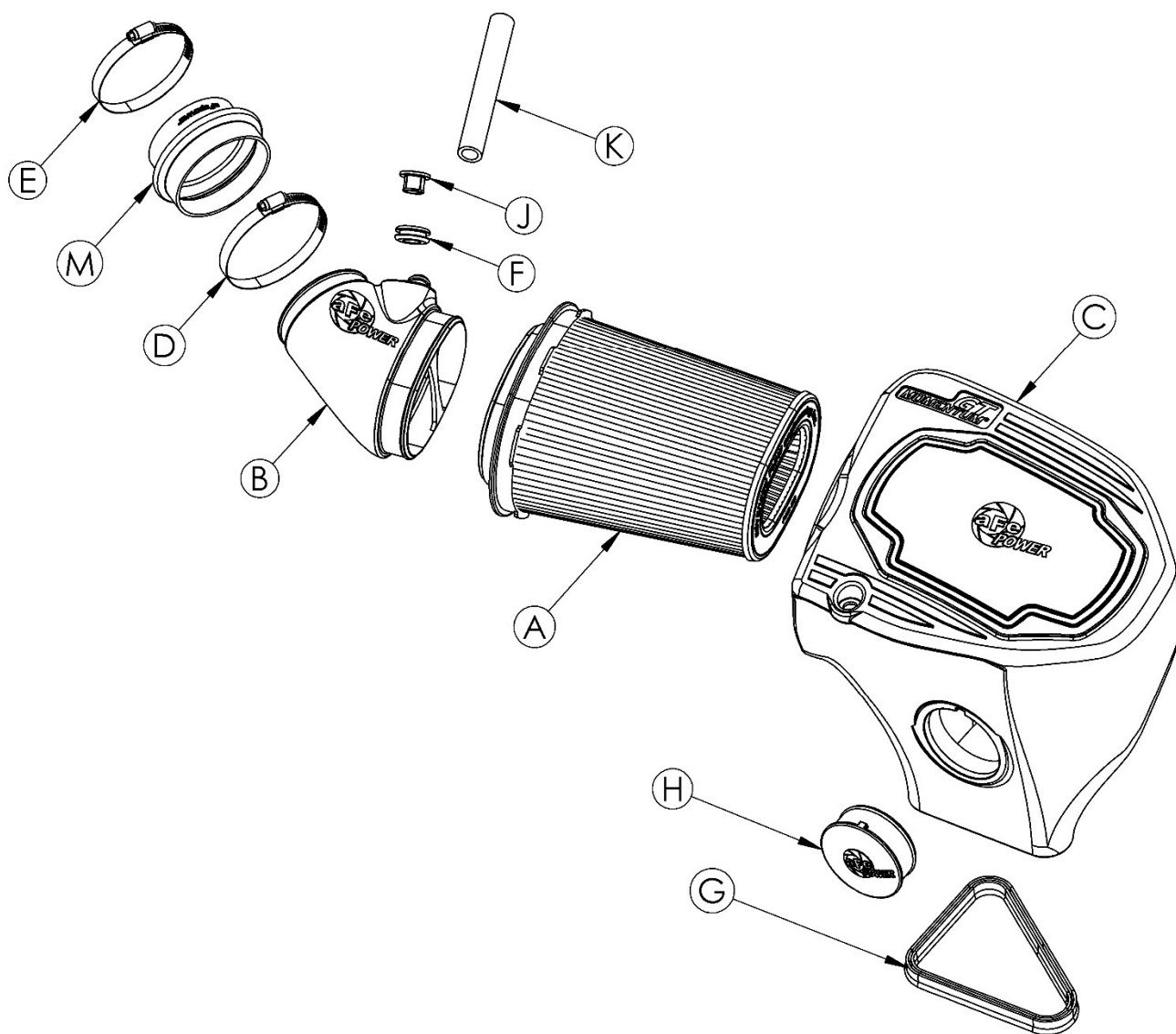



Refer to Figure A for Step 1

Step 1: Remove the four (4) factory nuts using a 10mm driver or socket wrench and remove the upper portion of the shaker hood air scoop. Nuts will be used later in the installation.



Figure B

Refer to Figure B for Step 2

Step 2: Remove the two (2) factory shaker hood tube retaining clips from the factory housing, using a pry tool or flathead screwdriver. Retaining clips will be used later in the installation.



Figure C

Refer to Figure C for Step 3

Step 3: Use a 10mm driver or socket wrench to remove the four (4) factory screws and one (1) nut in order to remove the base of the shaker hood and tube. Screws and nut will be used later in the installation.



Figure D

Refer to Figure D for Steps 4-7

Step 4: Carefully unplug the (IAT) intake air temperature sensor connector from the factory intake tube.

Step 5: Disconnect the breather hose from the crankcase ventilation port.

Step 6: Use an 8mm driver or socket wrench to loosen the hose clamp securing the factory intake tube to the throttle body.

Step 7: Use an 8mm driver or socket wrench to remove the front mounting screw securing the factory intake housing. Screw will be used later in the installation.

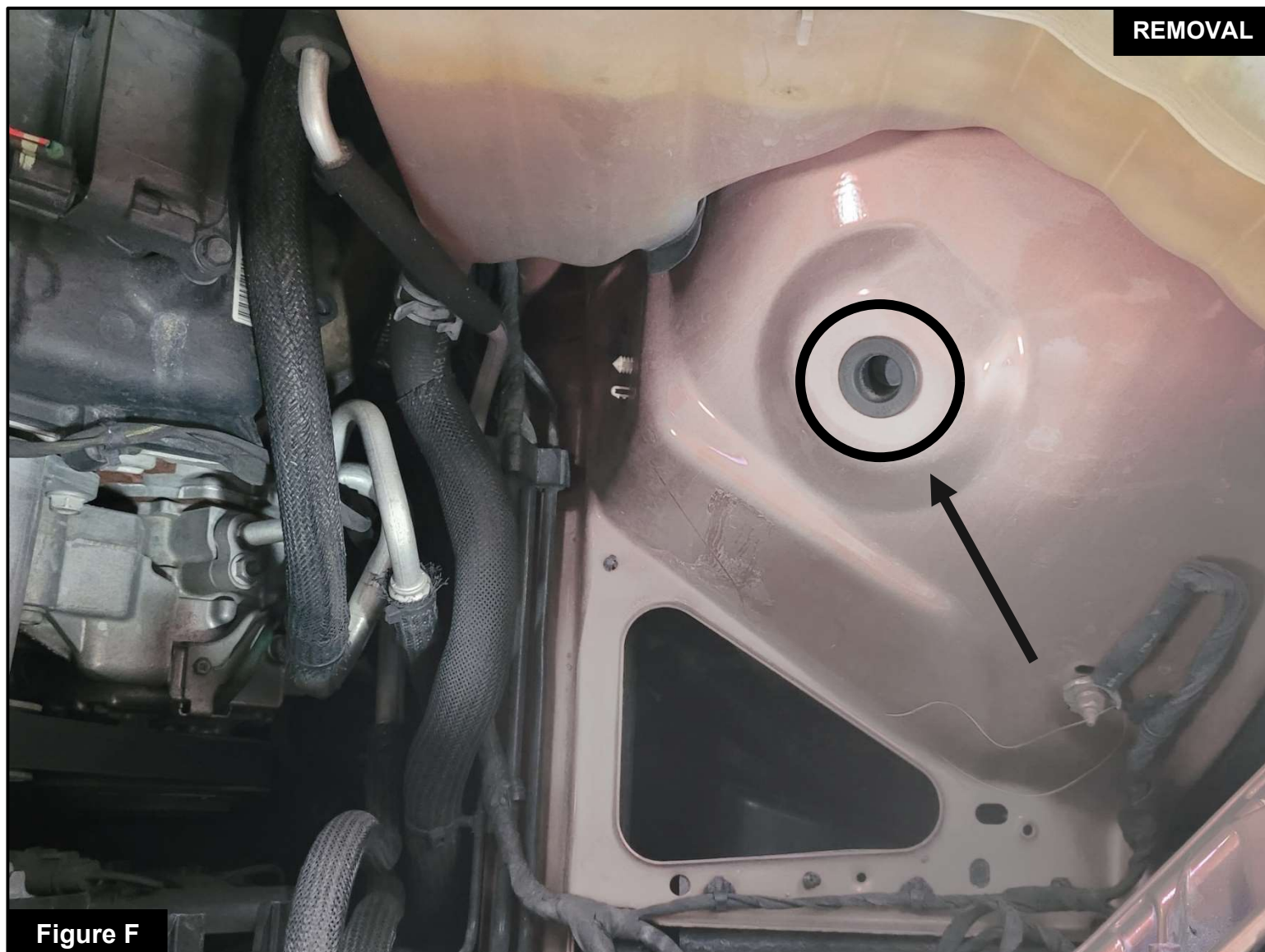

Figure F

Refer to Figure F for Step 8

Step 8: Carefully remove the factory intake housing and tube together. Make sure not to drop or lose the rubber grommet located at the bottom side of the housing.

**Figure G****Refer to Figure G for Step 9**

Step 9: Use a 10mm wrench or ratchet wrench to remove the factory mount and screw from the factory housing and transfer them to the Momentum GT housing.



Figure H

Refer to Figure H for Step 10

Step 10: Transfer the factory rubber grommet and steel mount from the factory housing to the Momentum GT housing.

**Figure J****Refer to Figure J for Step 11**

Step 11: Install the provided seal trim onto the bottom edge of the Momentum GT housing.

**Figure K****Refer to Figure K for Step 12**

Step 12: Install the air filter into the Momentum GT housing by firmly pushing it into the housing until the filter tabs lock into place. Install the clamp onto the air filter, but do not tighten at this time.

Figure M

Refer to Figure M for Step 13

Step 13: Install aFe POWER plug onto the Momentum GT housing. Leave the housing inlet open to get more air or close it off with the aFe POWER plug to block off the hot engine air.

- If you have purchased the headlight D.A.S. (50-70009S or 54-72203-SR) for this intake system, install it into the Momentum GT housing. You may need to remove the headlight cap behind the vehicle's driver-side headlight, which may be secured with Torx T-10 security screws. Remove the screws to twist and remove the cap before installing the D.A.S. into the housing.

**Figure N****Refer to Figure N for Steps 14-15**

Step 14: Install the provided silicone breather hose onto the Momentum GT intake tube.

Step 15: Install the provided rubber grommet and fitting for the (IAT) intake air temperature sensor onto the Momentum GT intake tube.

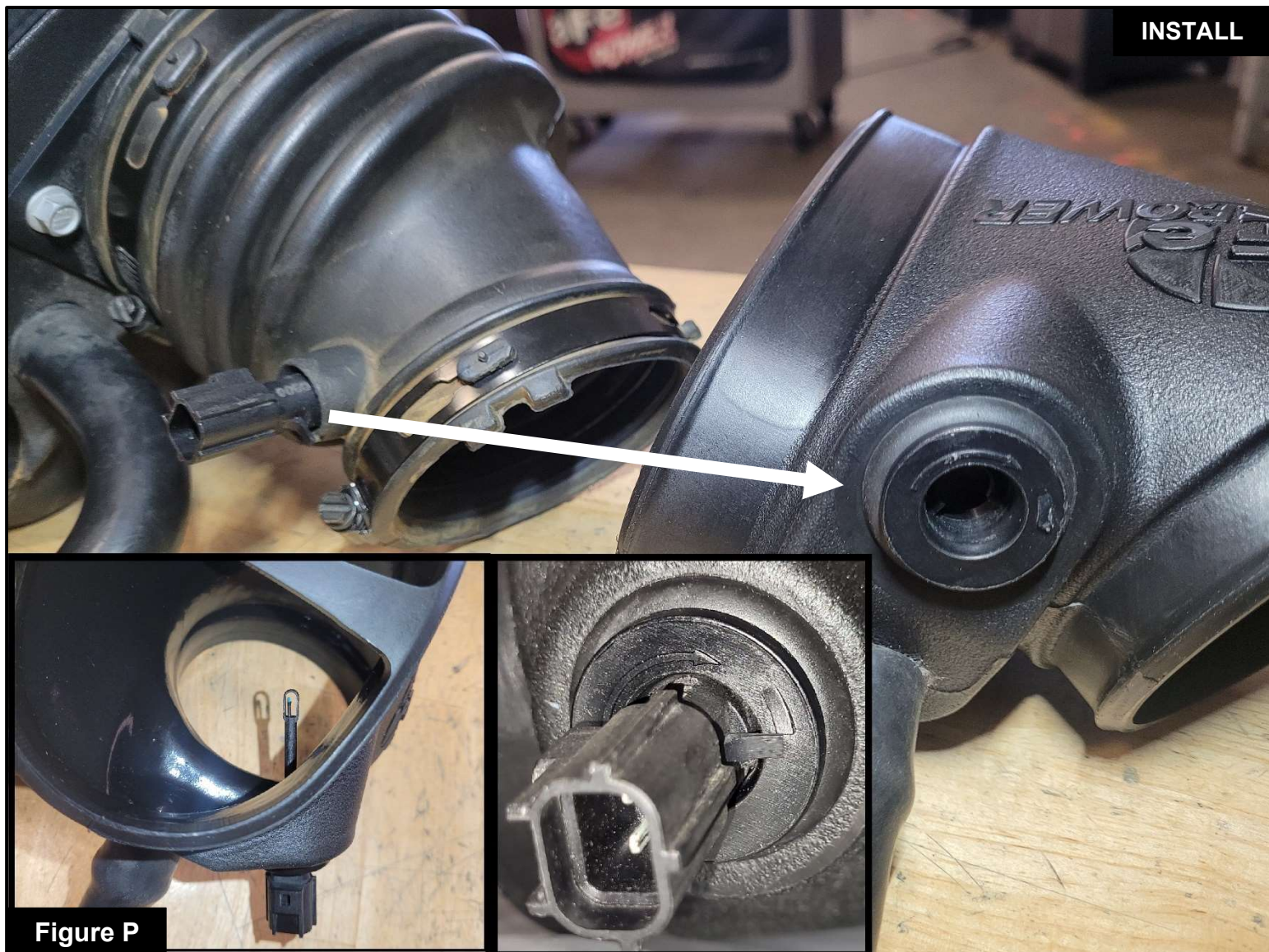
Figure P

Refer to Figure P for Step 16

Step 16: Transfer the (IAT) intake air temperature sensor from the factory intake tube to the Momentum GT intake tube. Twist to lock in place. Ensure that the (IAT) intake air temperature sensor is oriented correctly for optimal readings and secure fit.

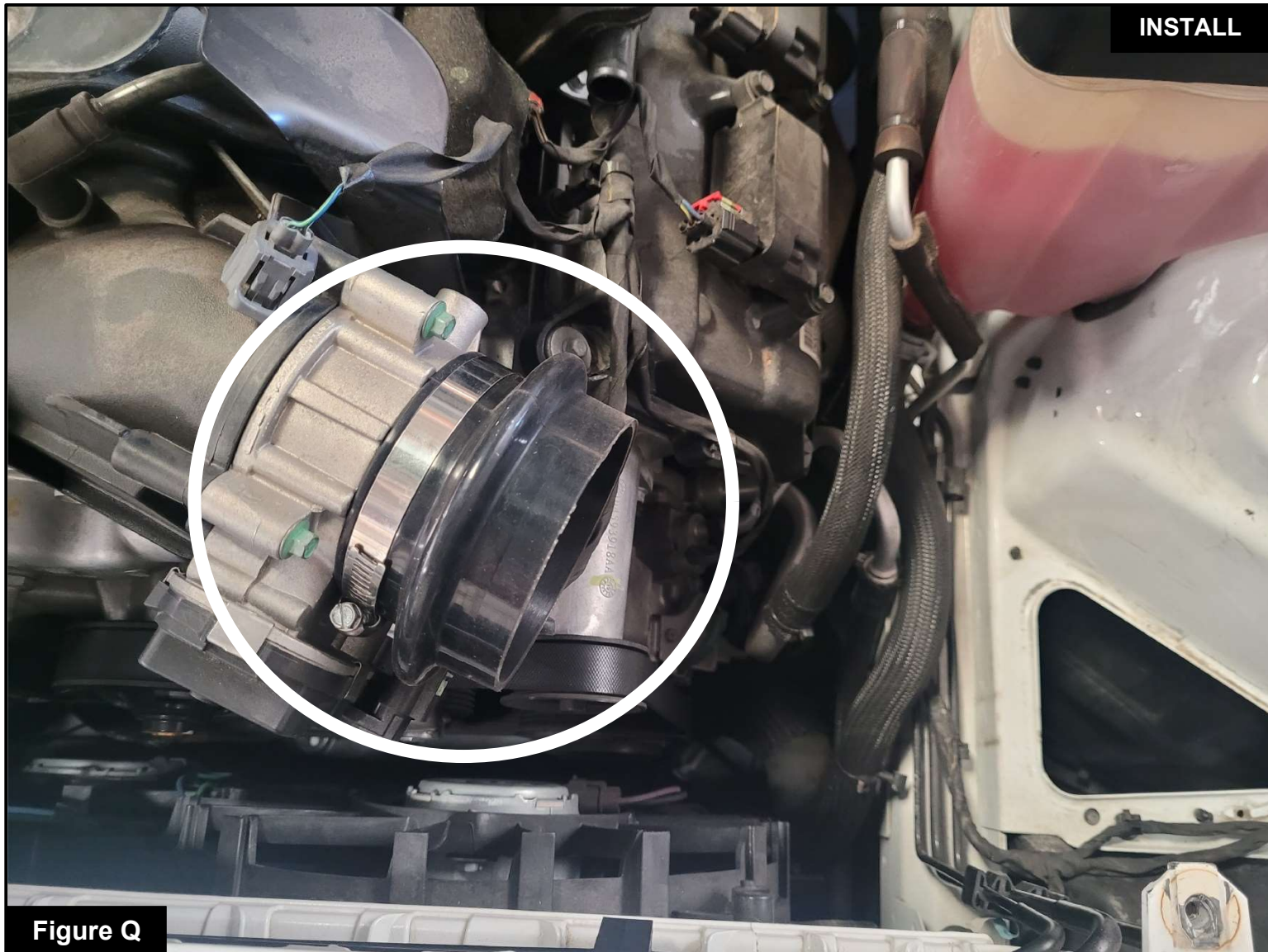

Figure Q

Refer to Figure Q for Step 17

Step 17: Install the aFe POWER coupler onto the throttle body and use an 8mm driver or ratchet wrench to tighten the #56 hose clamp to ensure a secure connection.



Figure R

Refer to Figure R for Steps 18-19

Step 18: Carefully install the Momentum GT housing assembly. If using the D.A.S. carefully align the headlight scoop and ensure everything fits correctly and that the housing mount fully sits into the locating hole in the vehicle body. Do not tighten anything at this time.

Step 19: Slip #64 hose clamp over the aFe POWER coupler. Do not tighten at this time.

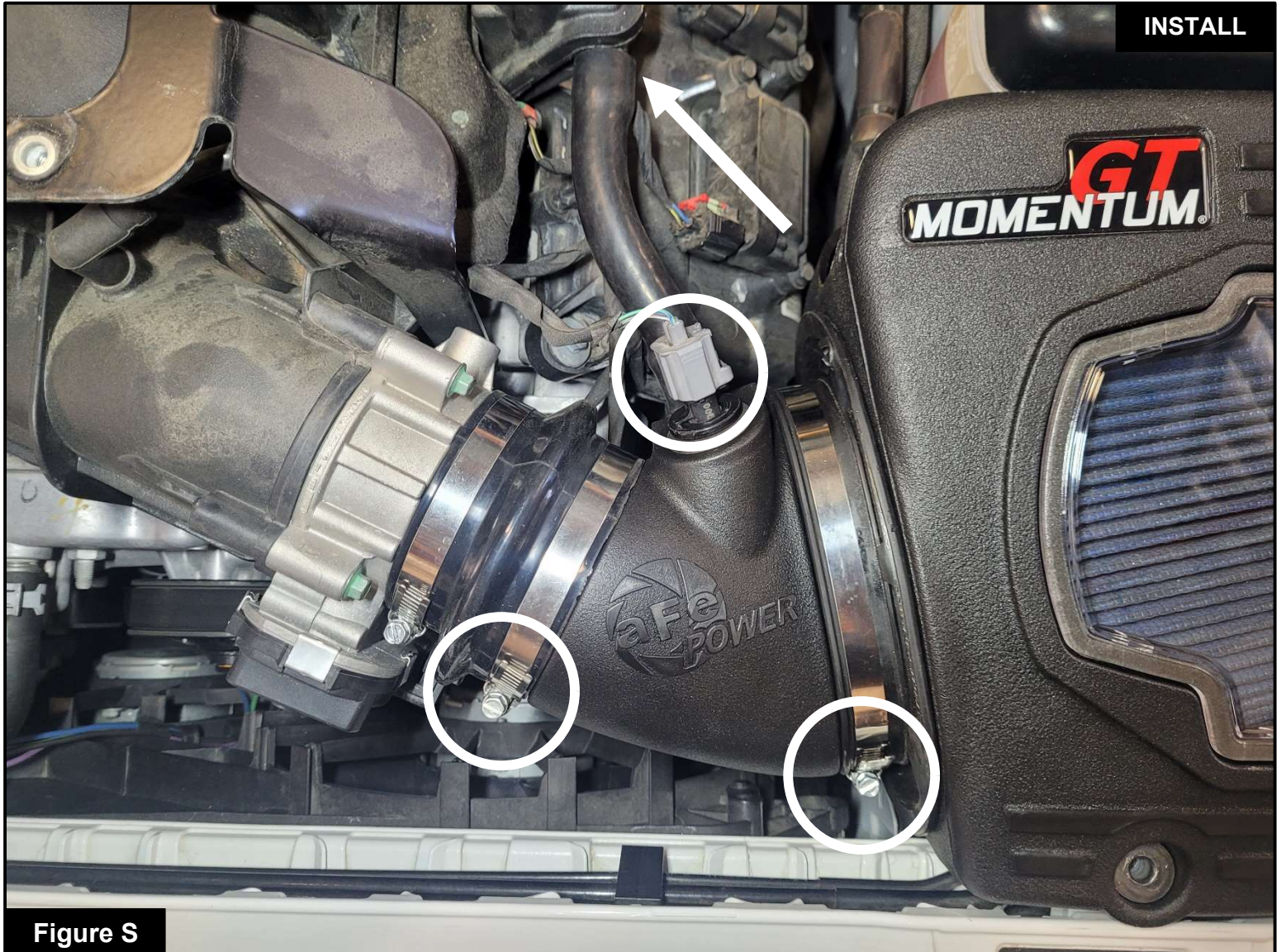

Figure S

Refer to Figure S for Steps 20-24

- Step 20: Carefully install the Momentum GT intake tube between the coupler and the filter, ensuring proper alignment.
- Step 21: Connect the breather hose to the crankcase ventilation port. Make sure that the hose is not kinked.
- Step 22: Use an 8mm driver or ratchet wrench to tighten the #64 hose clamp.
- Step 23: Use an 8mm driver or ratchet wrench to tighten the filter clamp.
- Step 24: Carefully plug in the (IAT) intake air temperature sensor connector to the Momentum GT intake tube.

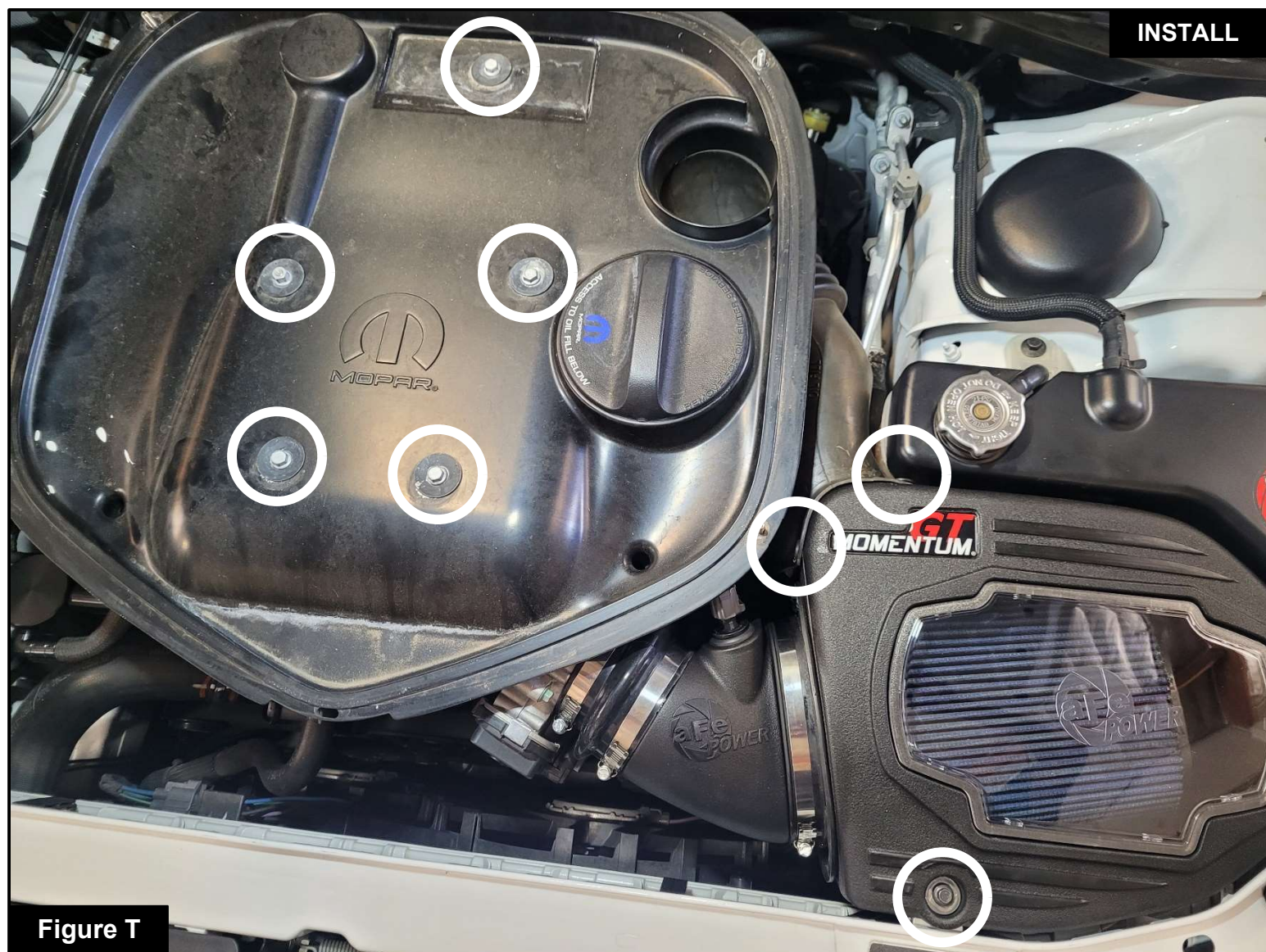

Figure T

Refer to Figure T for Steps 25-27

Step 25: Install the base of the shaker hood air scoop. Use a 10mm driver or ratchet wrench to install the four (4) factory screws and one (1) nut, that were removed in Step 3.

- **Position the base as accurately as possible to its original position so that the shaker air scoop aligns and seals properly with the hood cut out when the hood is closed.**

Step 26: Insert the factory shaker hood tube into the Momentum GT housing and secure it with the two (2) factory retaining clips that were removed at Step 2.

Step 27: Use an 8mm driver or ratchet wrench to install the front factory mount screw that was removed in Step 7.



Figure U

Refer to Figure U for Step 28

Step 28: Install the upper portion of the shaker hood air scoop and use a 10mm driver or ratchet wrench to install the four (4) factory nuts that were removed in Step 1.

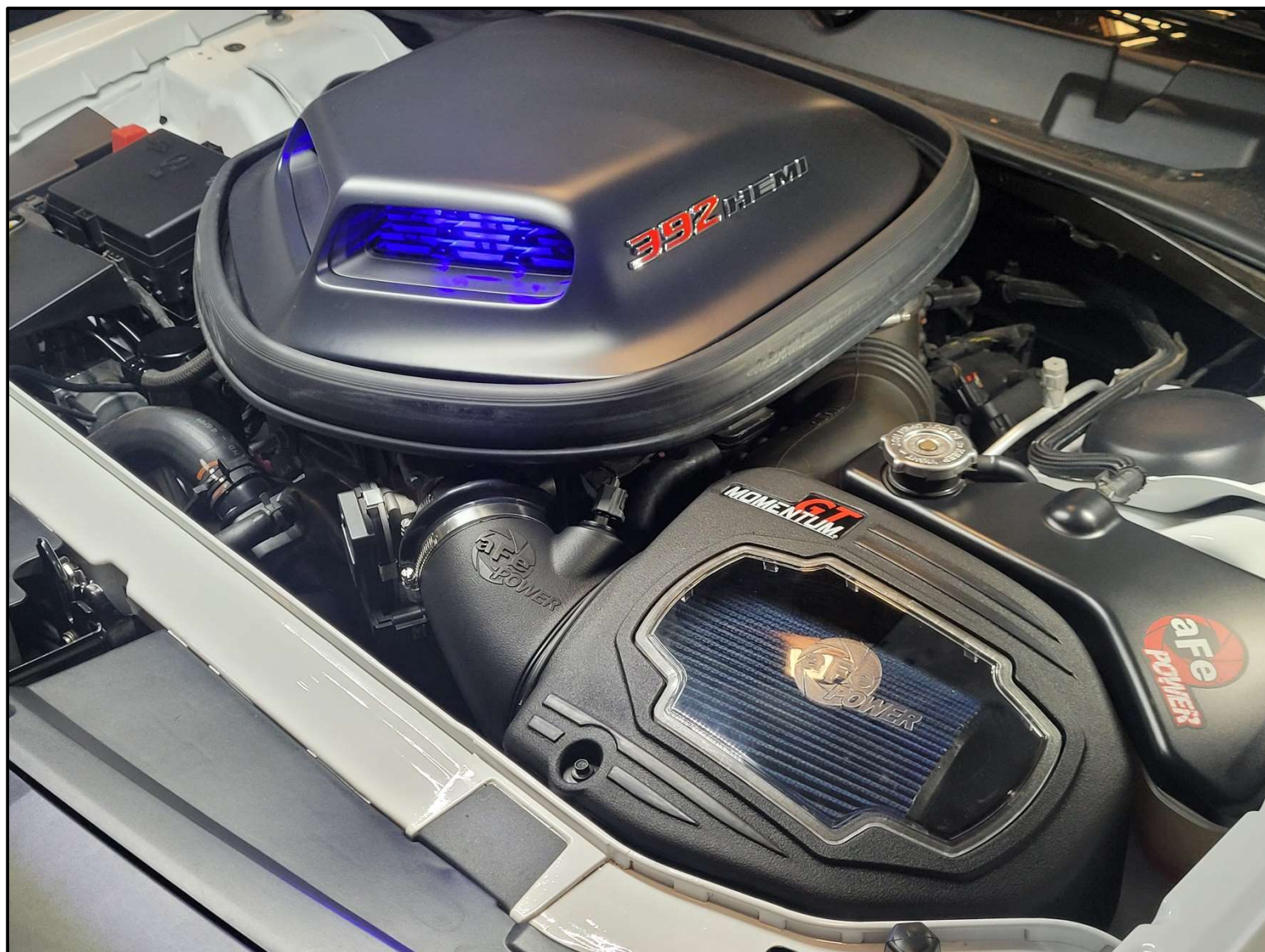

Your installation is now complete. Thank you for choosing aFe POWER!

NOTE: Check to ensure that all screws, clamps, and connectors are secure after 100-200 miles



PAGE LEFT BLANK INTENTIONALLY



PAGE LEFT BLANK INTENTIONALLY



advanced FLOW engineering, Inc.

Corona, CA 92879

<https://afepower.com/contact>