

advanced FLOW engineering Magnum Force Stage-2 Air Intake System

Instruction Manual P/N: 51-11872-1 / 54-11872-1 / 75-11872-1

Make: **Ford** Model: **Super Duty F-250/350/450** Year: **2011-2016** Engine: **V8-6.7L (td)**



- Please read the entire instruction manual before proceeding.
- Ensure all components listed are present.
- If you are missing any of the components, call customer support at 951-493-7100.
- Ensure you have all necessary tools before proceeding.
- Do not attempt to work on your vehicle when the engine is hot.
- Disconnect both negative battery terminals before proceeding. (REMEMBER YOU HAVE 2 BATTERIES)
- Retain factory parts for future use.

Label	Qty.	Description	Part Number
A1	1	Air Filter (Pro DRY S)	21-91051
A2	1	Air Filter (Pro 5R)	24-91051
A3	1	Air Filter (Pro-GUARD 7)	72-91051
B	1	Housing	05-5411872B2
C	1	Tube	05-01135
D	1	Seal Trim (36")	05-01507
E	1	Coupling, Turbo Adaptor	05-01137
F	1	Coupling, Silicone Bellows	05-01430
G	2	Clamp #072	03-50010
H	1	Clamp #088	03-50005
I	1	MAS Gasket	05-00631
J	1	Adaptor	05-00611
K	5	Screw, Hex Hd: M6x1x12	03-50032
L	5	Washers, Wavy: M6	03-50058
M	2	Nylon Spacer	03-50089
N	2	Screw, Torx: M4	03-50491
O	1	Torx, Bit: T20	03-50066
P	1	Tie, Nylon, Black (12" in.)	05-60167
Q	1	Clamp, Fixing 3/4" ID	03-50234
R	1	Washer, Flat: M6	03-50070
S	1	Screw, Hex Hd: M6x1x20	03-50057

Installation will require the following tools:

10mm Socket, 13mm Socket, 8mm Socket, Ratchet, Extension & Flat-Head Screw Driver

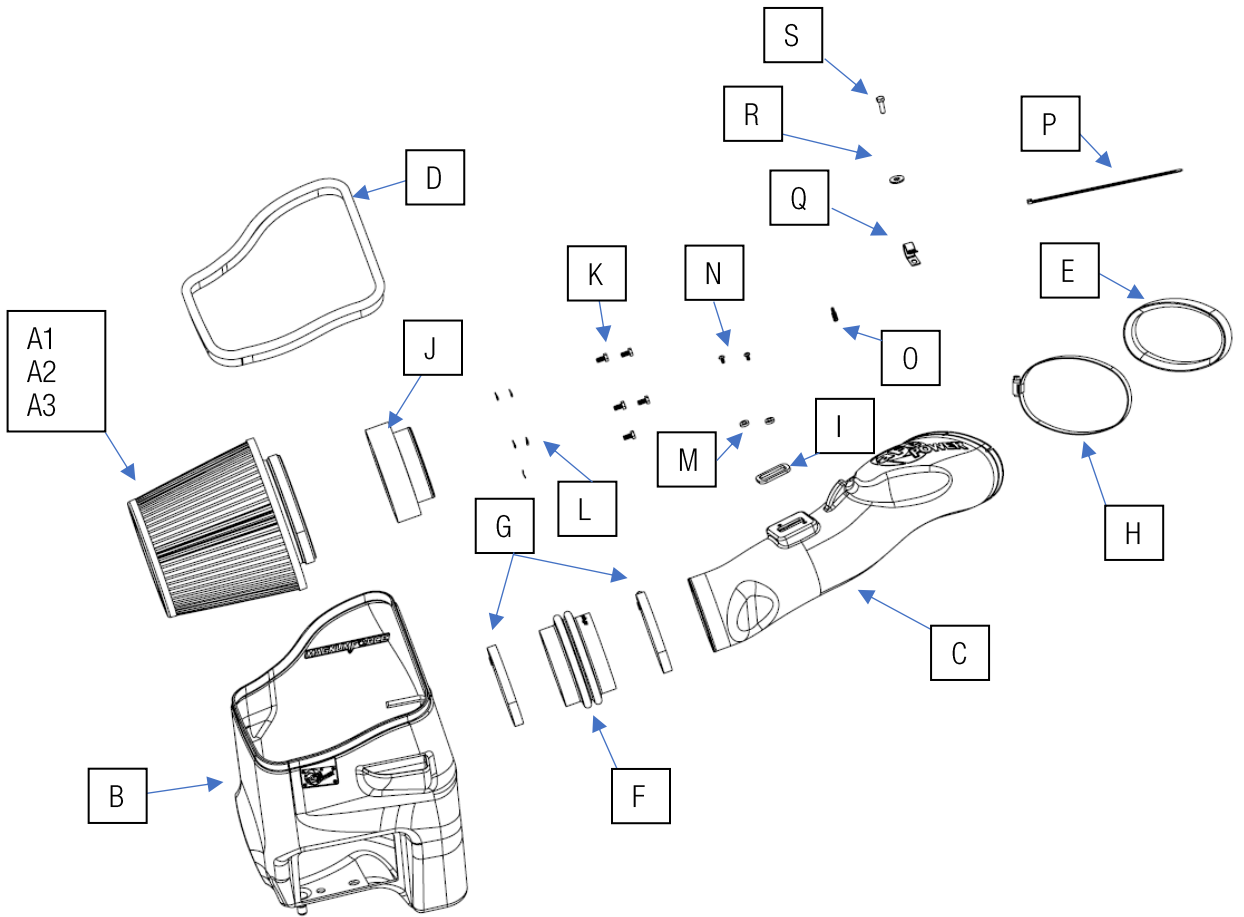

A1

A2

A3





Figure A

Refer to Figure A for step 1

Step 1: Take off the two 8mm screws securing the factory intake tube and filter box (1) and loosen the band clamps. Note: On 2015-16 models cut the plastic tie holding this coolant tube (2).

**Figure B****Refer to Figure B for steps 2-3**

Step 2: Disconnect the wire harness clip from the filter housing and pull the red tab out on the flow sensor connector, then press the tab and gently pull off the sensor plug. Remove the flow sensor off the tube with the provided T-20 torx bit (3).

Step 3: Pull out the air box in an upward motion. Remove the front inlet rubber gasket on factory air box. Remove the rubber grommet and sleeve that was installed on the air box near the battery.



Refer to Figure C for step 4

Step 4: Slip all the hoses out of the way on the factory intake tube, loosen the clamps, and remove the tube.

**Figure D****Refer to Figure D for steps 5**

Step 5: Install the sensor onto the aFe POWER intake tube with the provided nylon spacers, gasket and small screws (4). Also place the largest clamp on the big oval end of the tube. Add the bellows coupler with clamps onto the small end of the tube and slide until flush with tube. Do not tighten the clamps at this time.

**Figure E****Refer to Figure E for Step 6-7**

Step 6: Install the factory grommet and metal sleeve onto the aFe POWER housing.

Step 7: Install factory rubber inlet gasket onto the aFe POWER housing.

**Figure F****Refer to Figure F for Step 8**

Step 8: Install the seal trim on the top edge of the housing and install the Injection molded filter adaptor with the provided hex screws and wavy washers.

INSTALL

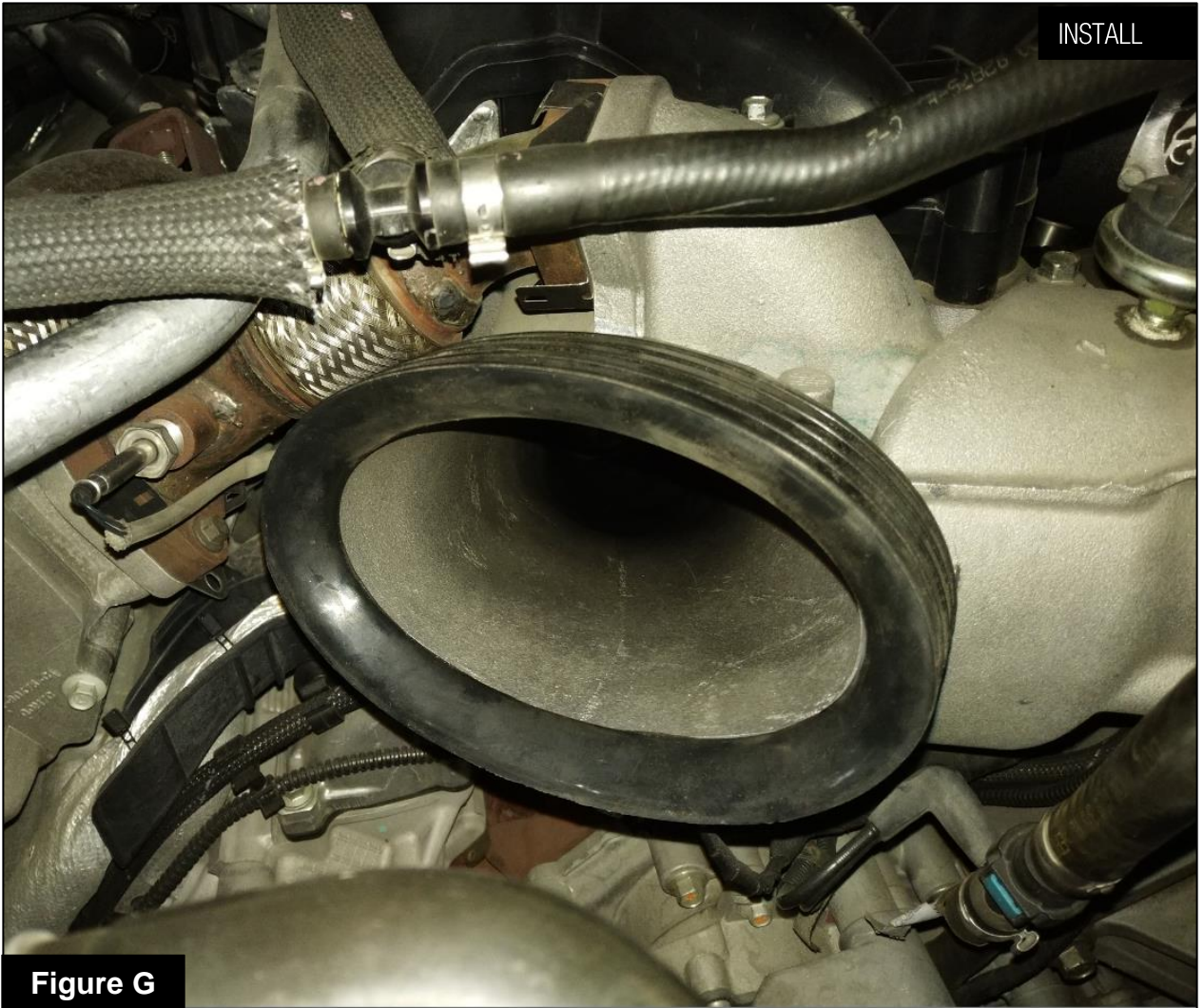

Figure G

Refer to Figure G for steps 9-10

Step 9: Install the adaptor coupling onto the engine with the radius edge outward.

Step 10: Install tube onto engine manifold over the adaptor coupling. Do not tighten clamps at this time.

**Figure H****Refer to Figure H for steps 11-13**

Step 11: Install the housing, reuse the factory 8mm bolt that held in the factory airbox in Step 1 to secure the housing.

Step 12: Slide the bellows coupling back onto the injection molded adaptor and align tube clamps then tighten all clamps. Keep the big oval end of the tube over the adaptor coupling and tighten the clamp.

Step 13: Make Sure the coolant tube snaps into the hook recess molded into the tube

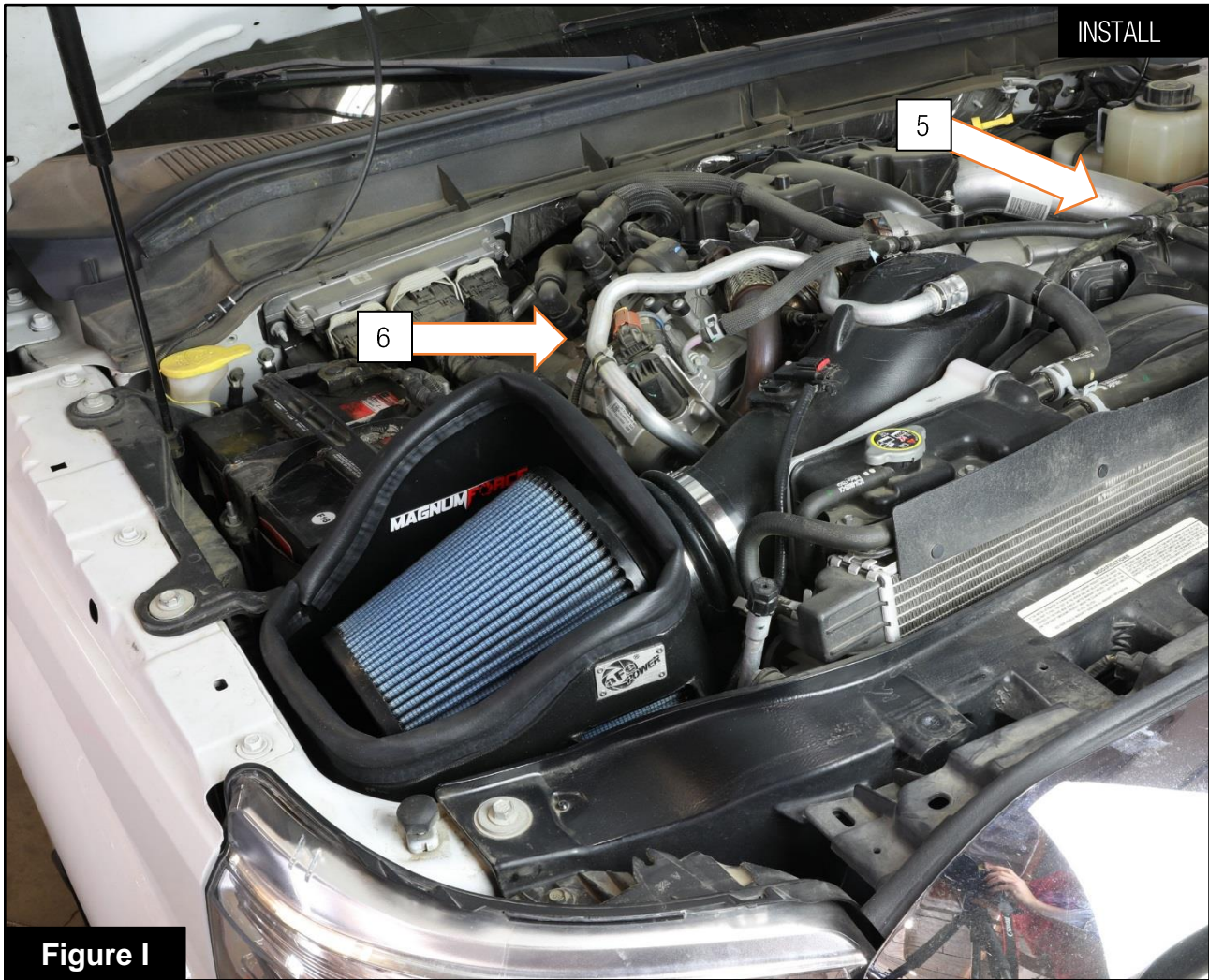

Figure I

Refer to Figure I for steps 14-16

Step 14: Install the filter with the provided hose clamp and tighten. Make sure the flange is contacting the housing wall.

Step 15: Secure the hoses (5) with the 3/4" clamp and hardware provided (Parts Q, R, and S) that held the factory tube in Step 1.

Step 16: Secure the coolant tube with a new nylon tie provided (6). (Only necessary on 2015-16 models)

**Figure J****Refer to Figure J for steps 17-19**

- Step 17: Reconnect MAF Sensor plug. It should click when engaged. Then press in the red tab. (7)
Step 18: Check that all components are tight and secure. Your installation is now complete.
Step 19: Reconnect batteries. Thank you for choosing aFe POWER!

NOTE: Retighten all connections after approximately 100-200 miles. Place enclosed CARB EO sticker on or near the device on a smooth/clean surface. EO identification label is required to pass the smog test inspection.

Pro DRY S Air Filter



P/N: 21-91051

Pro 5R Air Filter



P/N: 24-91051

Pro GUARD 7 Air Filter



P/N: 72-91051

Pre-Filters



P/N: 28-10303

Pro DRY S Restore Kit



P/N: 90-9999

Pro 5R Restore Kit



P/N: 90-50501

Pro GUARD 7 Restore Kit



P/N: 90-50500

SCORCHER HD Module



P/N: 77-43014

Intercooler Tubes



P/N: 46-20144-B

D/P-Back Exhaust



P/N: 49-43065-B

Rear Differential Cover



P/N: 46-70022

Sprint Booster



P/N: 77-13001

Warranty

General Terms:

- aFe warrants their products to be free from manufacturer's defects due to workmanship and material.
- This warranty applies only to the original purchaser of the product and is non-transferrable.
- Proof of purchase of the aFe product is required for all warranty claims.
- Warranty is valid provided aFe instructions for installation and/or cleaning were properly followed.
- Proper maintenance with regular inspections of product is required to insure warranty coverage.
- Damage due to improper installation, abuse, unauthorized repair or alteration is not warranted.
- Incidental or consequential damages or cost, including installation and removal of part, incurred due to failure of aFe product is not covered under this warranty.
- All warranty is limited to the repair and/or replacement of the aFe part. To request Return Goods Authorization ("RGA"), email RGA@afepower.com or call (951)493-7100. Upon receipt of the RGA, you must return the product to the address provided in the RGA, freight prepaid and accompanied with a dated proof of purchase and the RGA. Upon receipt of the defective product and upon verification of proof of purchase, aFe will either repair or replace the defective product within a reasonable time, not to exceed thirty days.

Product Category	P/N Prefix	Warranty duration
Direct OE Replacement Filters	10, 11, 30, 31, 71, 73	Life of the vehicle
Racing Filters	18	1 year
Universal	21, 24, 72,TF	2 years
Air Intake Systems	50, 51, 54, 55, 75,TR,TA,TL	2 years
Exhaust Systems	49	2 years
Intercoolers & Intercooler Tubes	46-2	2 years
Intake Manifolds	46-1	2 years
Differential Cover	46-7	Life of the vehicle
Exhaust Manifolds	46	2 years
Throttle Body Spacers	46-3	2 years
Turbochargers	46-6	2 years*
Fluid Filters	44	90 days
Pre-Filters	28	2 years
Heavy Duty OE Replacement	70	2 years
PowerSports OE Replacement	81, 87	2 years
PowerSports Intake Systems	85	2 years

No other warranty expressed or implied applies nor is any person or advanced FLOW engineering authorized to assume any other warranty. Some States do not allow the exclusion or limitation of incidental or consequential damages or do not allow limitations on how long an implied warranty lasts, so the above limitations or exclusions may not apply to you. This warranty gives you specific legal rights, and you may also have other rights which vary from State to State.

*See turbocharger warranty for more info



advanced FLOW engineering, inc.

252 Granite Street Corona, CA 92879

TEL: 951.493.7100 • TECH: 951.493.7134

E-Mail: Tech@aFepower.com

P/N: 06-81313