



TYPHOON INTAKE SYSTEMS

NOT LEGAL FOR SALE OR USE ON ANY POLLUTION CONTROLLED MOTOR VEHICLE IN CALIFORNIA OR STATES ADOPTING CALIFORNIA EMISSION PROCEDURES.

See knfilters.com for CARB status on each part for a specific vehicle

INSTALLATION INSTRUCTIONS

69-5325TS
HYUNDAI
2019-20 Veloster
L4-2.0L

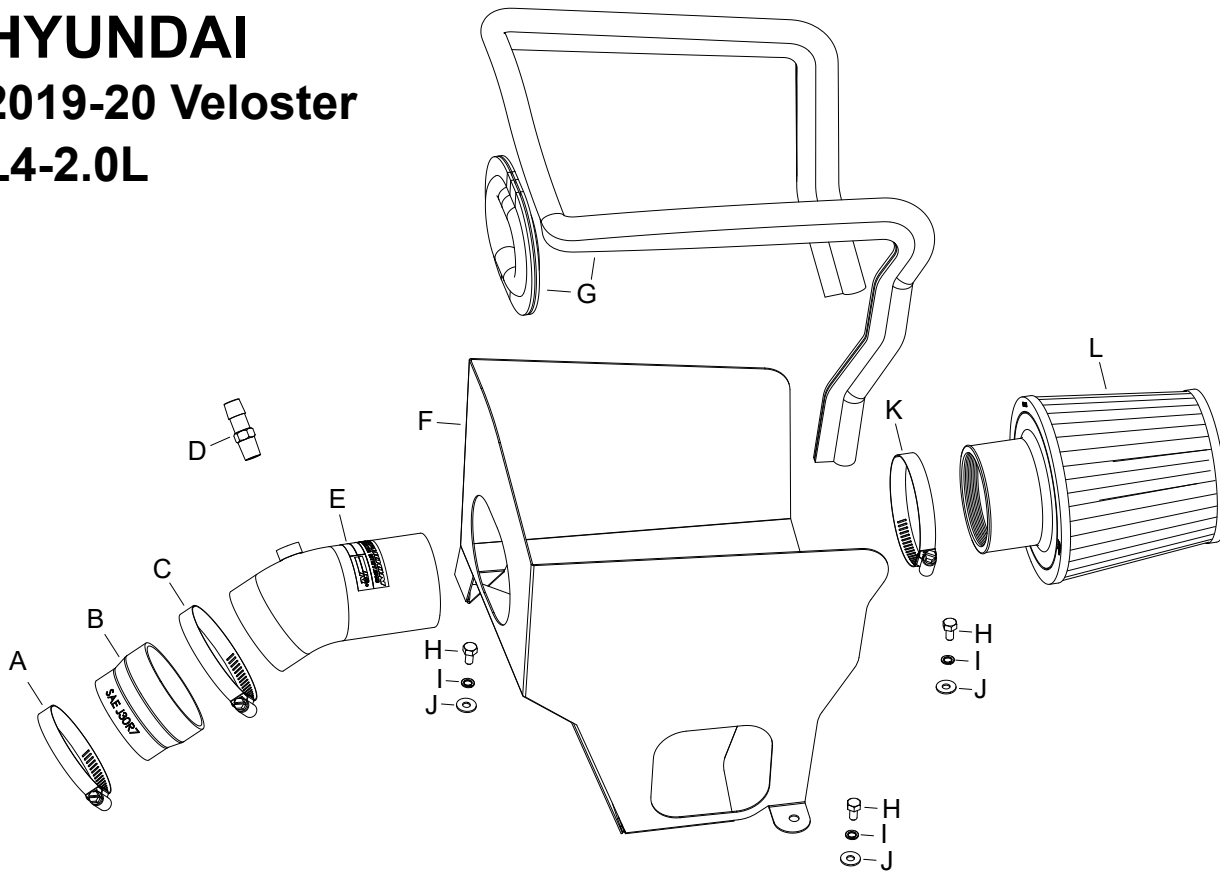

TOOLS NEEDED:

- Ratchet Extension
- 10mm socket
- Flat blade screw driver
- Pliers
- cutters
- 9/16" wrench

PARTS LIST:

Description	Qty.	Part #
A HOSE CLAMP; #44	1	08577
B HOSE; 3" TO 2.75"ID X 2"L	1	084036
C HOSE CLAMP; #48	1	08601
D VENT; STRT, 1/2", 1/4"NPT	1	080022
E TUBE; 3.0"OD X 7"L, AL	1	25835S
F HEAT SHIELD; 69-5325, MILD	1	07373
G EDGE TRIM; 3/4" BULB, TOP	1	102492A
H BOLT; M6 X 1 X 12MM, SS	3	07727
I WASHER; M6 SPLIT LOCK ZINC	3	1-3025
J WASHER; 6MM FLAT, SS	3	08269
K HOSE CLAMP; #52	1	08610
L 3"FLG, 6"B, 5"T, 5-9/16"H	1	RU-4990

If you need any assistance please call 1-800-858-3333 to speak with a representative in our Customer Service Center before returning the product.

NOTE: FAILURE TO FOLLOW INSTALLATION INSTRUCTIONS AND NOT USING THE PROVIDED HARDWARE MAY DAMAGE THE INTAKE TUBE, THROTTLE BODY AND ENGINE.

TO START:

- Turn off the ignition and disconnect the negative battery cable.
NOTE: Disconnecting the negative battery cable erases pre-programmed electronic memories. Write down all memory settings before disconnecting the negative battery cable. Some radios will require an anti-theft code to be entered after the battery is reconnected. The anti-theft code is typically supplied with your owner's manual. In the event your vehicles anti-theft code cannot be recovered, contact an authorized dealership to obtain your vehicles anti-theft code.



- Push in the center of the retaining pins and then remove the pins from the fresh air intake duct.



- Loosen the hose clamp that secures the intake hose to the throttle body and then release the spring clamp that secures the PCV hose and disconnect the PCV hose from the intake tube.



- Release the two spring clips that retain the upper air filter housing, then remove the upper housing, intake tube and air filter from the vehicle.



- Remove the three bolts that secure the lower air filter housing and then remove the lower housing and fresh air duct from the vehicle.
NOTE: K&N Engineering, Inc., recommends that customers do not discard factory air intake.



- Separate the fresh air intake duct from the lower air filter housing.

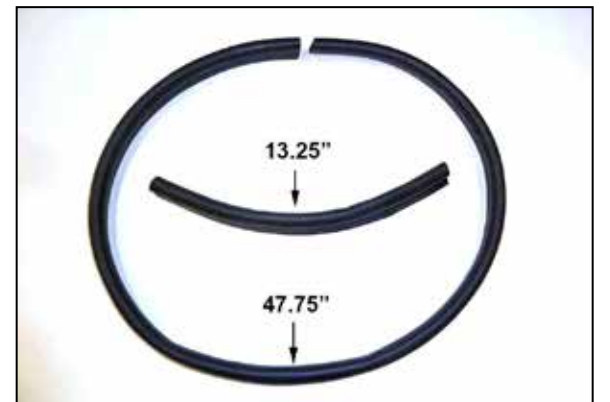

- Cut the provided edge trim into lengths of 13.25" and 47.75".



- Install the edge trim onto the heat shield as shown.



- Install the provided coupler (084036) onto the throttle body and secure with the provided hose clamp.



10. Install the K&N® heat shield and factory fresh air duct into the vehicle as an assembly. Secure the heat shield with the provided hardware and the fresh air duct with the factory pins.



11. Install the provided vent fitting into the K&N® intake tube as shown.

NOTE: Plastic NPT fittings are easy to cross thread. Install the vent fitting "hand" tight, then turn it two complete turns with a wrench.



12. Install the K&N® intake tube into the heat shield and then into the coupler at the throttle body, align the tube for best fit and then secure with the provided hose clamp.



13. Install the K&N® air filter and secure with the provided hose clamp.



14. Reconnect the vehicle's negative battery cable. Double check to make sure everything is tight and properly positioned before starting the vehicle.

15. It will be necessary for all K&N® high flow intake systems to be checked periodically for realignment, clearance and tightening of all connections. Failure to follow the above instructions or proper maintenance may void warranty.

ROAD TESTING:

1. Start the engine with the transmission in neutral or park, and the parking brake engaged. Listen for air leaks or odd noises. For air leaks secure hoses and connections. For odd noises, find cause and repair before proceeding. This kit will function identically to the factory system except for being louder and much more responsive.

2. Test drive the vehicle. Listen for odd noises or rattles and fix as necessary.

3. If road test is fine, you can now enjoy the added power and performance from your kit.

4. K&N Engineering, Inc., requires cleaning the intake system's air filter element every 100,000 miles. When used in dusty or off-road environments, our filters will require cleaning more often. We recommend that you visually inspect your filter once every 25,000 miles to determine if the screen is still visible. When the screen is no longer visible some place on the filter element, it is time to clean it. To clean and re-oil, purchase our filter Recharger® service kit, part number 99-5050 or 99-5000 and follow the easy instructions.

NOT LEGAL FOR SALE OR USE ON ANY POLLUTION CONTROLLED MOTOR VEHICLE IN CALIFORNIA OR STATES ADOPTING CALIFORNIA EMISSION PROCEDURES.

See knfilters.com for CARB status on each part for a specific vehicle