



TYPHOON INTAKE SYSTEMS

INTAKE SYSTEMS FOR VEHICLES LISTED ARE 50 STATE LEGAL. SEE KNFILTERS.COM FOR CARB STATUS ON EACH PART FOR A SPECIFIC VEHICLE.

INSTALLATION INSTRUCTIONS

69-8433TTK PONTIAC / SATURN 2008 Solstice / Sky I4-2.0L Turbo

TOOLS NEEDED:

- Flat Blade Screwdriver
- Phillips Screwdriver
- Ratchet
- Extension
- 10mm Socket
- 17mm Wrench
- 13mm Wrench
- 10mm Wrench
- 3mm Allen Key

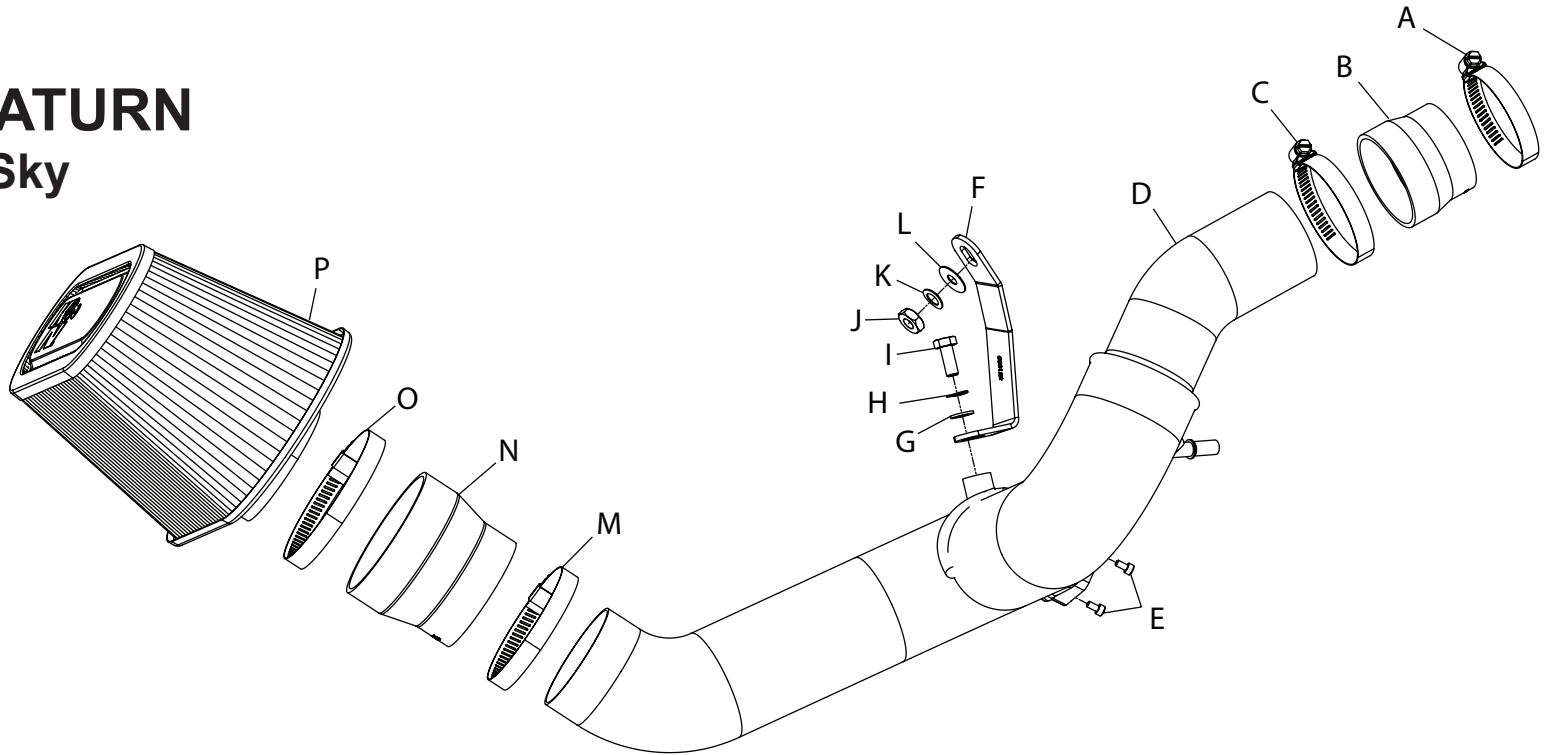

PARTS LIST:

Description	Qty.	Part #	Description	Qty.	Part #	Description	Qty.	Part #
A Hose Clamp #36	1	08530	G Washer; 8mm, Flat SS	1	08272	M Hose Clamp #48	1	08601
B Hose; 2-1/2" To 2-1/4"IDx2"L	1	08476	H Washer; 10mm Wave	1	08175	N Hose; 3-1/2" To 3"IDx3"L	1	084055
C Hose Clamp #40	1	08554	I Bolt; M8 - 1.0 X 20mm, Tap	1	06533	O Hose Clamp #56	1	08620
D Intake Tube	1	27458	J Nut; M10 X 1.5, Hex, SS	1	07508	P Air Filter	1	RP-5182
E Bolt; M4-0.07 8mm, A/H Cap	2	07733	K Washer; 8mm Spring	1	08239			
F Bracket; "C", STL	1	083122	L Washer; 3/8" Flat Washer	1	08134			

NOTE: FAILURE TO FOLLOW INSTALLATION INSTRUCTIONS AND NOT USING THE PROVIDED HARDWARE MAY DAMAGE THE INTAKE TUBE, THROTTLE BODY AND ENGINE.

TO START:

1. Turn off the ignition and disconnect the negative battery cable.

NOTE: Disconnecting the negative battery cable erases pre-programmed electronic memories. Write down all memory settings before disconnecting the negative battery cable. Some radios will require an anti-theft code to be entered after the battery is reconnected. The anti-theft code is typically supplied with your owner's manual. In the event your vehicles' anti-theft code cannot be recovered, contact an authorized dealership to obtain your vehicles anti-theft code.



2. Disconnect the mass air sensor electrical connection.

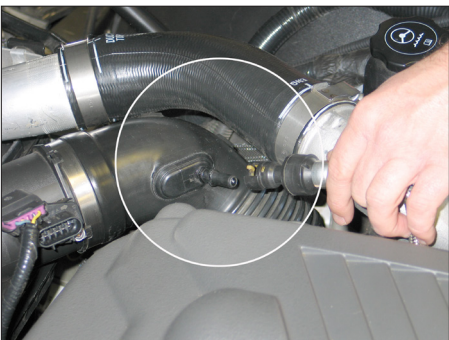

3. Release the crank case vent line retaining clip and then disconnect the crank case vent line.



4. Loosen the hose clamps which secure the intake tube to the turbo inlet and air box.



5. Remove the bolt which secures the front of the factory air box to the frame.

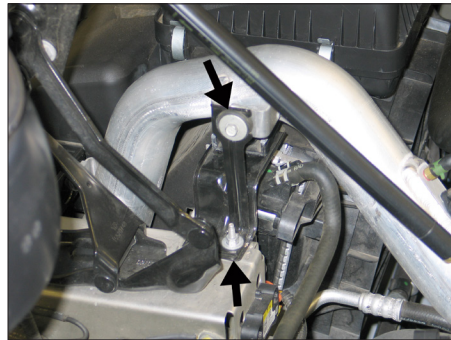

6. Remove the two bolts which secure the left side intercooler tube mounting bracket and then remove the bracket.

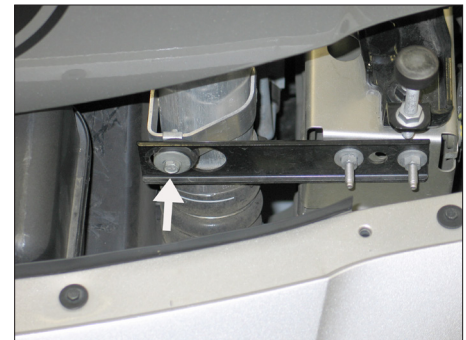

7. Remove the bolt which secures the left side intercooler tube to the front mounting bracket. **NOTE: This bolt will be reused.**



8. Pop the air box assembly up to release it from the mounting grommets, slide the air box assembly to the right side of the vehicle, pull the left side intercooler tube to the left and then pull up the air box flange around the intercooler tube. Once the air box is clear of the intercooler tubes, tip the back side up towards the hood so the front will clear the hood and then remove the complete air box assembly.



9. Remove the stock intake tube from the vehicle. **NOTE: K&N Engineering, Inc., recommends that customers do not discard factory air intake.**

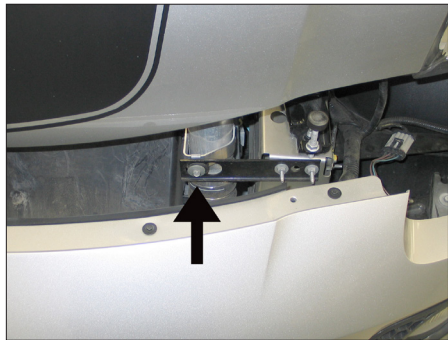

10. Reinstall the bolt which secures the left side intercooler tube to the front mounting bracket.

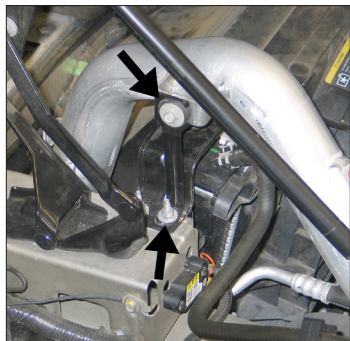

11. Reinstall the left side intercooler tube mounting bracket and secure with the factory hardware.

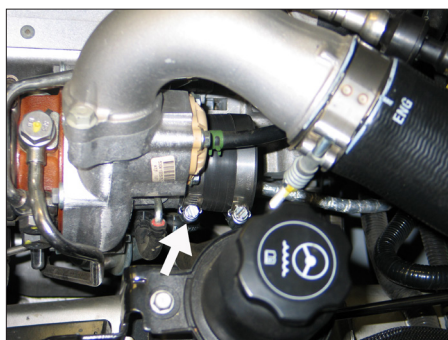

12. Install the silicone hose (08476) onto the turbo inlet and secure with the provided hose clamp.

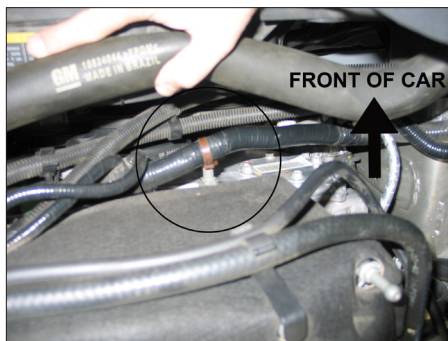

13. Unhook the engine wiring harness from the stud on the front of the engine.

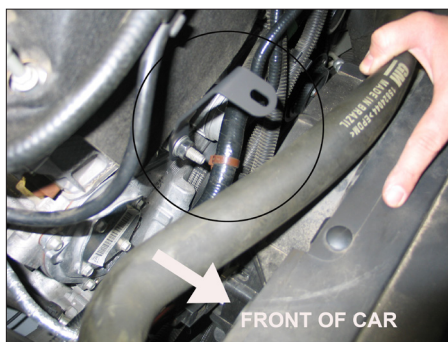

14. Install the tube mounting bracket (083122) onto the stud on the front of the engine and secure with the hardware. Re-secure the wiring harness to the stud after the bracket has been installed.



15. Remove the mounting screws and then remove the mass air sensor from the stock air box.



16. Install the mass air sensor into the K&N® intake tube and secure it with the provided hardware.



17. Install the provided silicone hose (084055) onto the K&N® air filter and secure with the provided hose clamp.



18. Set the K&N® filter assembly into position on the radiator shroud as shown.

NOTE: The filter's inlet is off-set to one side of the filter, be sure to place the filter so the offset is towards the top as in the photo.



19. Install the K&N® intake tube into the silicone hose at the turbo inlet and align with the mounting bracket installed in step #14, slide the filter onto the end of the intake tube. Secure the intake tube with the provided hose clamp and hardware. Secure the filter with the provided hose clamp.



20. Connect the crank case vent fitting to the fitting on the K&N® intake tube.



21. Reconnect the mass air sensor electrical connection.



22. Reconnect the vehicle's negative battery cable. Double check to make sure everything is tight and properly positioned before starting the vehicle.

23. It will be necessary for all K&N® high flow intake systems to be checked periodically for realignment, clearance and tightening of all connections. Failure to follow the above instructions or proper maintenance may void warranty.

ROAD TESTING:

1. Start the engine with the transmission in neutral or park, and the parking brake engaged. Listen for air leaks or odd noises. For air leaks secure hoses and connections. For odd noises, find cause and repair before proceeding. This kit will function identically to the factory system except for being louder and much more responsive.

2. Test drive the vehicle. Listen for odd noises or rattles and fix as necessary.

3. If road test is fine, you can now enjoy the added power and performance from your kit.

4. K&N Engineering, Inc., requires cleaning the intake system's air filter element every 100,000 miles. When used in dusty or off-road environments, our filters will require cleaning more often. We recommend that you visually inspect your filter once every 25,000 miles to determine if the screen is still visible. When the screen is no longer visible some place on the filter element, it is time to clean it. To clean and re-oil, purchase our filter Recharger® service kit, part number 99-5050 or 99-5000 and follow the easy instructions.

INTAKE SYSTEMS FOR VEHICLES LISTED ARE 50 STATE LEGAL. SEE KNFILTERS.COM FOR CARB STATUS ON EACH PART FOR A SPECIFIC VEHICLE.