



**advanced FLOW engineering**

**Instruction Manual** P/N: 77-44010

**SCORCHER HD Module**

---

Make: <b>Chevrolet</b>	Model: <b>Silverado HD</b>	Year: <b>2017-2019</b>	Engine: <b>V8-6.6L (td) Duramax (L5P)</b>
Make: <b>GMC</b>	Model: <b>Sierra HD</b>	Year: <b>2017-2019</b>	Engine: <b>V8-6.6L (td) Duramax (L5P)</b>

Note: **Includes Denali Models.**



- Please read the entire instruction manual before proceeding.
- Ensure all components listed are present.
- If you are missing any of the components, call customer support at 951-493-7100.
- Ensure you have all necessary tools before proceeding.
- Do not attempt to work on your vehicle when the engine is hot.
- Disconnect the negative battery terminal before proceeding.
- Retain factory parts for future use.

Label	Qty.	Description	Part Number
A	1	Module	R77-44010
B	1	LED Switch	05-70013
C	2	Velcro (2 Inches)	05-01244
D	4	Cable Ties	05-60167





# SLEEP MODE

Figure A

## **Refer to Figure A for Step 1.**

Step 1: Before installing your aFe module, you will have to place your vehicles ECU in sleep mode. In order to do this you will need to do the following:

- If the engine is cold, open the hood, close the doors lock the car and wait 30 seconds.
- If the engine is warm, open the hood, close the doors lock the car and wait 20 minutes.
- If the engine is warm and you can't wait 20 minutes, disconnect the battery.



Figure B

**Refer to Figure B for Step 2.**

Step 2: Locate the MAP and Fuel Pressure sensor on the engine. The MAP Sensor is located on top of the engine, on the intake manifold. The fuel pressure connector is more difficult to access. It is located under the intake tube between the charge intake pipe and the alternator. It is necessary to remove the intake tube to access it.

**Figure C****Refer to Figure C for Steps 3-4.**

Step 3: Disconnect the MAP sensor connector.

Step 4: Locate the MAP sensor jumper harness on the aFePower module. This is the shorter harness.

Plug the male connector of the module to the stock map sensor, then the female connector of the module male connector of the engine harness.

**Note: Make sure connections are fully engaged. Usually, connectors make a snapping sound when fully engaged.**



Figure D

**Refer to Figures D for Step 5.**

Step 5: Remove the intake tube by disconnecting the two clamps to gain access to the fuel pressure sensor.

**Figure E****Refer to Figure E for Steps 6-7.**

Step 6: Locate and disconnect the fuel pressure sensor, at the end of the fuel rail between charge intake tube and alternator.

Step 7: Locate the fuel pressure sensor jumper harness on the aFePower module. This is the longer harness. Plug the male connector of the module to the stock fuel pressure sensor, then take the female connector of the module and connect to the male connector of the engine harness.

**Note: Make sure connections are fully engaged. Usually, connectors make a snapping sound when fully engaged.**





Figure F

**Refer to Figure F for Steps 9-10.**

Step 9: Mount the Switch on an open, flat surface.

Step 10: Carefully route the switch cable behind steering wheel cover.

**Figure G****Refer to Figure G for Step 11.**

Step 11: Route the switch cable through firewall and into the engine bay. Follow the main harness through the grommet into the firewall. Plug the end of the switch cable to the module.

**Figure H****Refer to Figure H for Step 12.**

Step 12: Mount the module in a safe location, using the supplied Velcro strip. Then, secure the wires and module away from any extreme heat and moving parts, with the provided ties. Make sure all connections are secured and fully engaged.

**Figure 1**
**Refer to Figure 1 for Step 13.**

Step 13: When turning on the vehicle, the switch will go through the light. It will stop at its last setting.

The LED on the switch represents the different level of power.

- Green LED: Stock
- Yellow LED: Sport
- Orange LED: Sport+
- Red LED: Race

Use the grey button to select the desired setting. Power adjustments can be done at any moment.

Thank you for choosing aFe POWER!

**NOTE: Place enclosed CARB EO sticker on or near the device on a smooth, clean surface.**

**EO identification label is required to pass the smog test inspection.**

Page left blank intentionally



Page left blank intentionally

Page left blank intentionally

**OE Replacement Filter**



P/N: 30-10275 (P5R)  
31-10275 (PDS)

**Momentum HD Intake**



P/N: 50-74008 (P10R)  
51-74008 (PDS)

**Cold Air Intake**



P/N: 51-12902 (PDS)  
54-12902 (P5R)

**Intercooler Tubes**



P/N: 46-20334-B

**DPF-Back Exhaust System**



P/N: 49-04086-B (Blk. Tips)  
49-04086-P (Pol. Tips)

**DPF-Back Exhaust System**



P/N: 49-44085-B (Blk. Tips)  
49-44085-P (Pol. Tips)

**DP-Back Exhaust System**

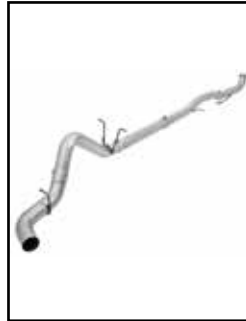

P/N: 49-04090NM (No Muff.)  
49-44090 (w/ Muff.)

**SPRINT BOOSTER V3**



P/N: 77-14003

**DFS780 Fuel System**



P/N: 42-14023

**Rear Differential Cover**



P/N: 46-70012-WL (w/ Oil)  
46-70010 (RAW)

**Oil Filter**



P/N: 44-LF001

**Oil Cap**



P/N: 79-12002

To purchase any of the items above, view airflow charts, dyno graphs, photos, and video please go to [aFepower.com](http://aFepower.com).



# Warranty

## General Terms:

- aFe warrants their products to be free from manufacturer's defects due to workmanship and material.
- This warranty applies only to the original purchaser of the product and is non-transferrable.
- Proof of purchase of the aFe product is required for all warranty claims.
- Warranty is valid provided aFe instructions for installation and/or cleaning were properly followed.
- Proper maintenance with regular inspections of product is required to insure warranty coverage.
- Damage due to improper installation, abuse, unauthorized repair or alteration is not warranted.
- Incidental or consequential damages or cost, including installation and removal of part, incurred due to failure of aFe product is not covered under this warranty.
- All warranty is limited to the repair and/or replacement of the aFe part. To request Return Goods Authorization ("RGA"), email [RGA@afepower.com](mailto:RGA@afepower.com) or call (951)493-7100. Upon receipt of the RGA, you must return the product to the address provided in the RGA, freight prepaid and accompanied with a dated proof of purchase and the RGA. Upon receipt of the defective product and upon verification of proof of purchase, aFe will either repair or replace the defective product within a reasonable time, not to exceed thirty days.

<b>Product Category</b>	<b>P/N Prefix</b>	<b>Warranty duration</b>
Direct OE Replacement Filters	10, 11, 30, 31, 71, 73	Life of the vehicle
Racing Filters	18	1 year
Universal	21, 24, 72, TF	2 years
Air Intake Systems	50, 51, 54, 55, 75, TR, TA, TL	2 years
Exhaust Systems	49	2 years
Intercoolers & Intercooler Tubes	46-2	2 years
Intake Manifolds	46-1	2 years
Differential Cover	46-7	Life of the vehicle
Exhaust Manifolds	46	2 years
Throttle Body Spacers	46-3	2 years
Fluid Filters	44	90 days
Pre-Filters	28	2 years
Heavy Duty OE Replacement	70	2 years
PowerSports OE Replacement	81, 87	2 years
PowerSports Intake Systems	85	2 years
Tuners	77	1 year

No other warranty expressed or implied applies nor is any person or advanced FLOW engineering authorized to assume any other warranty. Some States do not allow the exclusion or limitation of incidental or consequential damages or do not allow limitations on how long an implied warranty lasts, so the above limitations or exclusions may not apply to you. This warranty gives you specific legal rights, and you may also have other rights which vary from State to State.



Page Left Blank Intentionally

Page Left Blank Intentionally

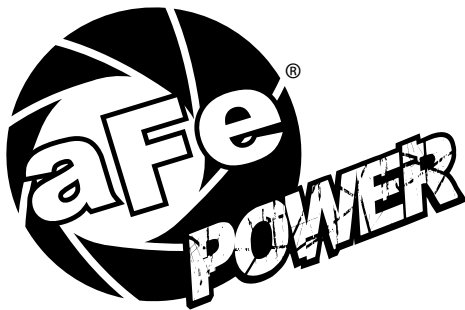

**advanced FLOW engineering, inc.**  
252 Granite Street Corona, CA 92879  
TEL: 951.493.7100 TECH: 951.493.7134  
E-Mail: [Tech@aFepower.com](mailto:Tech@aFepower.com)

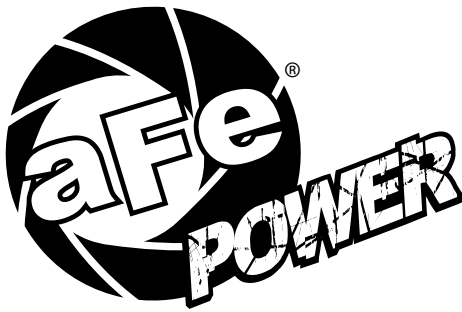

**HD**  
**MOMENTUM™**

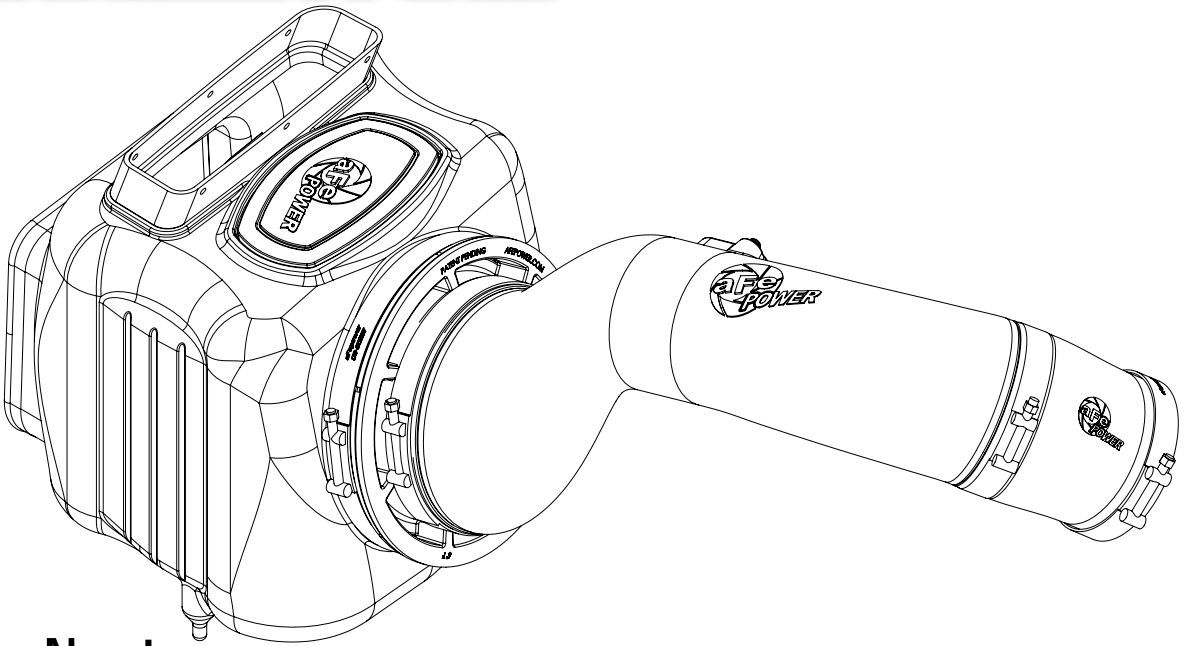

The Next  
Generation  
of Intakes  
advanced FLOW engineering

**Instruction Manual** P/N: 50-74008 / 51-74008

Make: **Chevrolet** Model: **Silverado HD**

Year: **2017-2019** Engine: **V8-6.6L Duramax (L5P)**

Make: **GMC** Model: **Sierra HD**

Year: **2017-2019** Engine: **V8-6.6L Duramax (L5P)**

Note: **Includes Denali Models.**



- Please read the entire instruction manual before proceeding.
- Ensure all components listed are present.
- If you are missing any of the components, call customer support at 951-493-7100.
- Ensure you have all necessary tools before proceeding.
- Do not attempt to work on your vehicle when the engine is hot.
- Disconnect the negative battery terminal before proceeding.
- Retain factory parts for future use.

Label	Qty.	Description	Part Number
A1	1	Pro DRY S Air Filter	21-91059
A2	1	Pro 10R Air Filter	20-91059
B	1	Tube	05-74008B1
C	1	Housing	05-74008B2
D	1	Scoop	05-74008B3
E	1	Clamp, T-bolt (8-5/16" - 8-5/8")	03-50267
F	1	Coupling, Silicone Elbow	05-01420
G	1	Clamp, T-bolt (4-5/16" - 4-5/8")	03-50499
H	1	Seal Trim 7/16" (27" Inches)	05-00072
I	2	Screws, Torx M4	03-50491
J	1	Clamp, T-bolt (4-1/16" - 4-3/8")	03-50262

Installation will require the following tools:

8mm Nut driver, 11mm Nut driver, T20 torx bit or driver, 13mm deep socket, extension and driver.

Note: Legal in California for use on race vehicles only. The use of this device on vehicles used on public streets or highways is strictly prohibited in California and others states that have adopted California emission regulations.

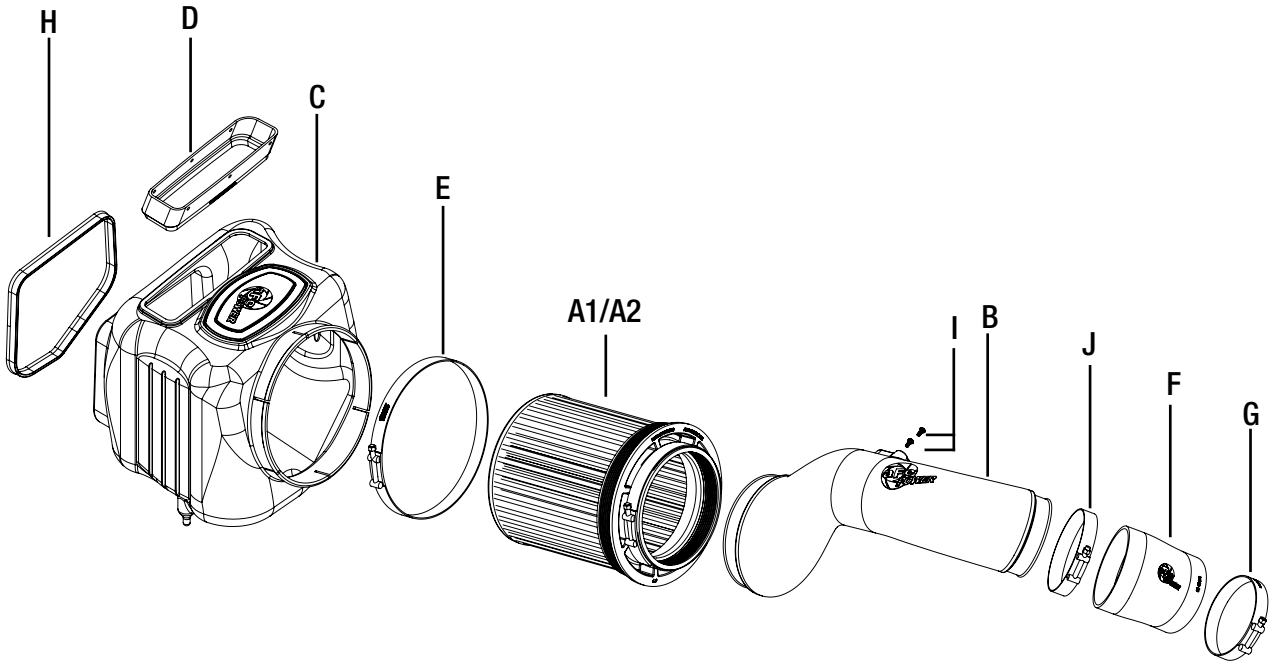



**Refer to Figure A for Steps 1-2**

Step 1: Disconnect the MAF sensor plug. ①

Step 2: Disconnect the MAF sensor harness clip ② from the OE airbox.



**Figure B****Refer to Figure B for Steps 3-4**

Step 3: Loosen the clamps (3) at the airbox and at the resonator coupler.

Step 4: Remove the stock intake tube. (4)

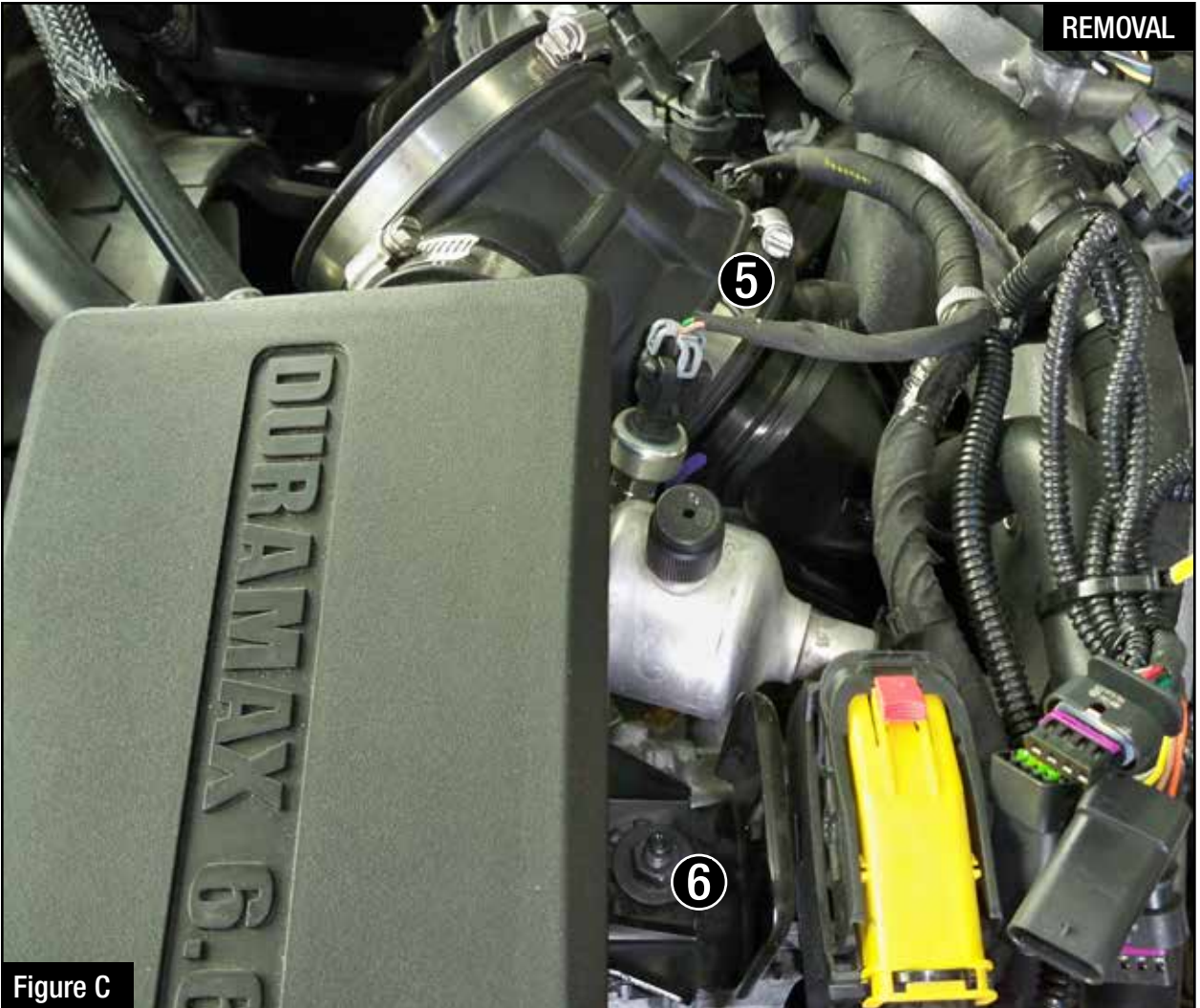
**Figure C**
**Refer to Figure C for Step 5**

Step 5: If you wish to remove the resonator, loosen the clamp (5) at the turbo inlet with an 8mm nut driver. Using a 13mm deep socket, extension and driver, remove the nut (6) holding the resonator. Remove the resonator with the stock coupler.

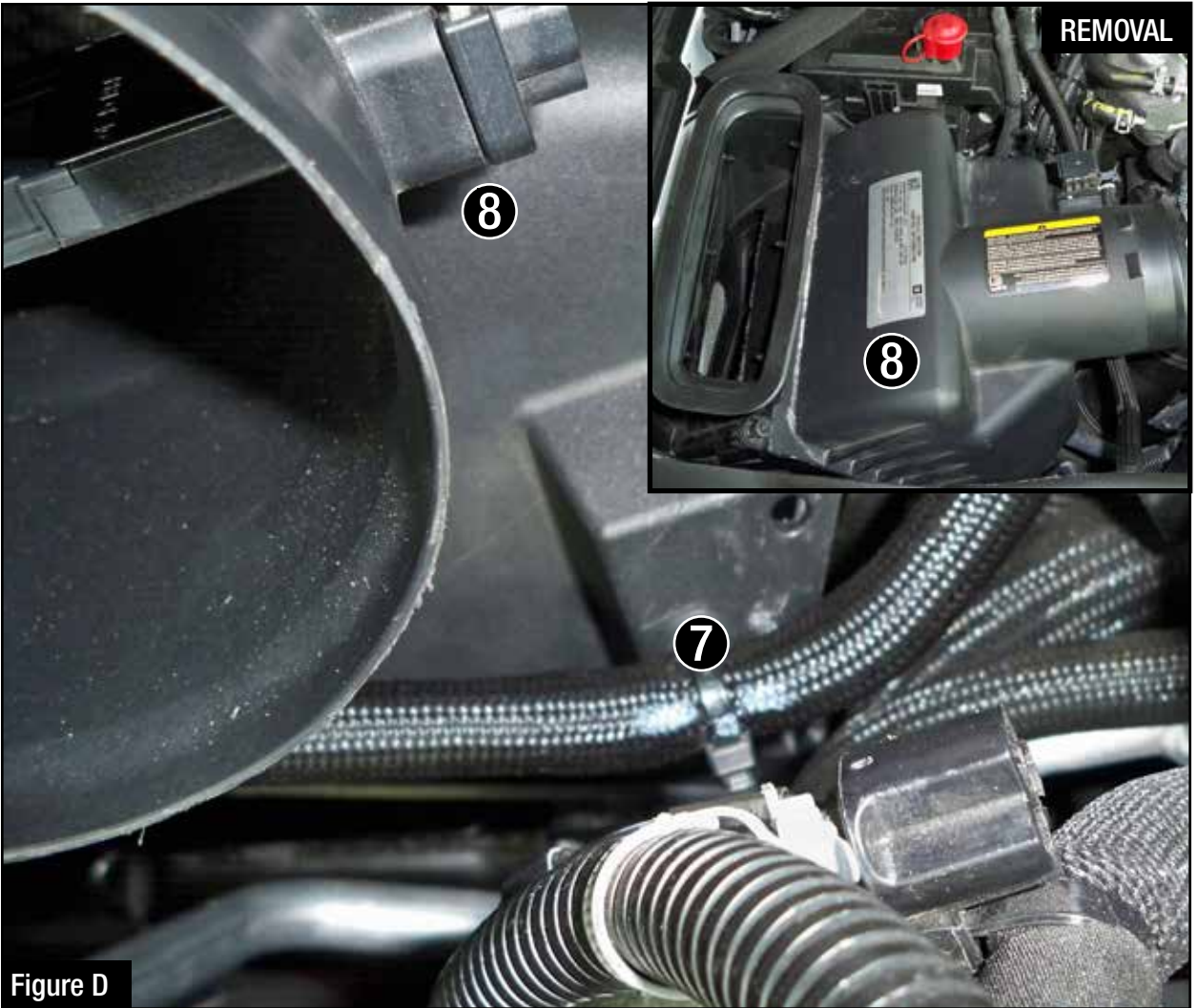
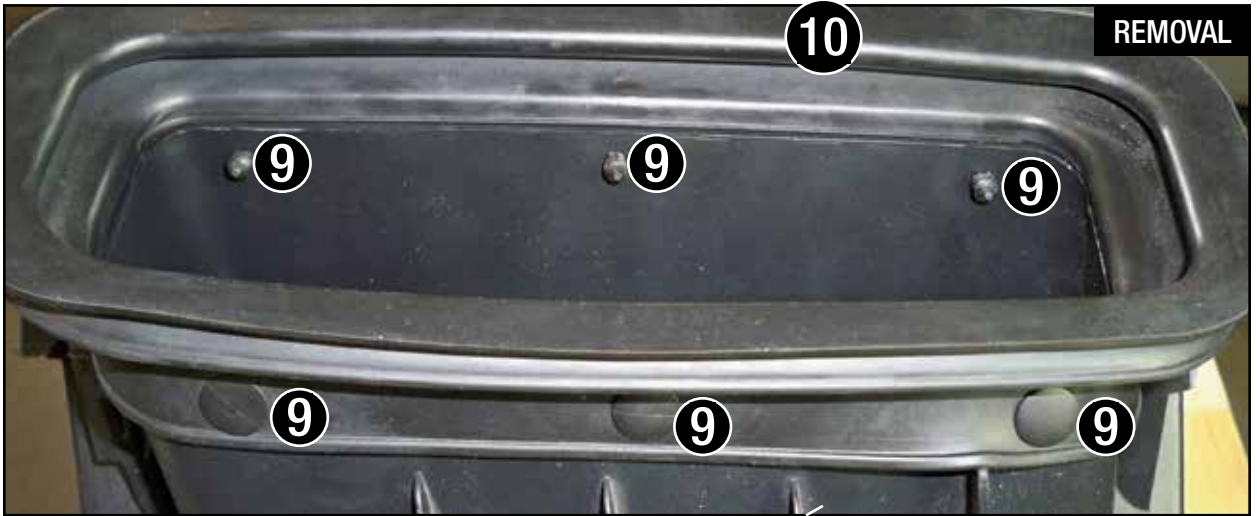

Figure D

**Refer to Figure D for Step 6**

Step 6: Remove the coolant line clip (7) from the airbox then remove the factory airbox (8) out of the vehicle. (Use an upward pull to release the retaining plug).



**Refer to Figure E for Step 7**

Step 7: Remove the 6 clips (9) holding the rubber seal (10) on the stock airbox. Remove the rubber seal and transfer it to the aFe airbox scoop (11). Reuse the 6 clips to attach the rubber seal to the scoop.



Figure F

**Refer to Figure F for Steps 8-9**

Step 8: Remove the retaining plug (12) from the bottom of the factory airbox and transfer it to the aFe airbox.

Step 9: Install the trim seal (13) on the opening of the aFe airbox.



Figure G

**Refer to Figure G for Step 10**

Step 10: Install the supplied large clamp (14) on the airbox then Slide the aFe filter and clamp (15) into the airbox. Do not tighten the clamps at this time.



Figure H

**Refer to Figure H for Step 11**

Step 11: Install the aFe airbox assembly into the vehicle. Firmly push it into the factory mounting grommets.

REMOVAL

INSTALL



Figure I

**Refer to Figure I for Steps 12-13**

Step 12: Remove the MAF sensor with gasket (16) from the factory airbox using a T20 Torx drive.

Step 13: Install the MAF sensor with gasket into the aFe intake tube using the supplied M4 screws and a T20 Torx drive.



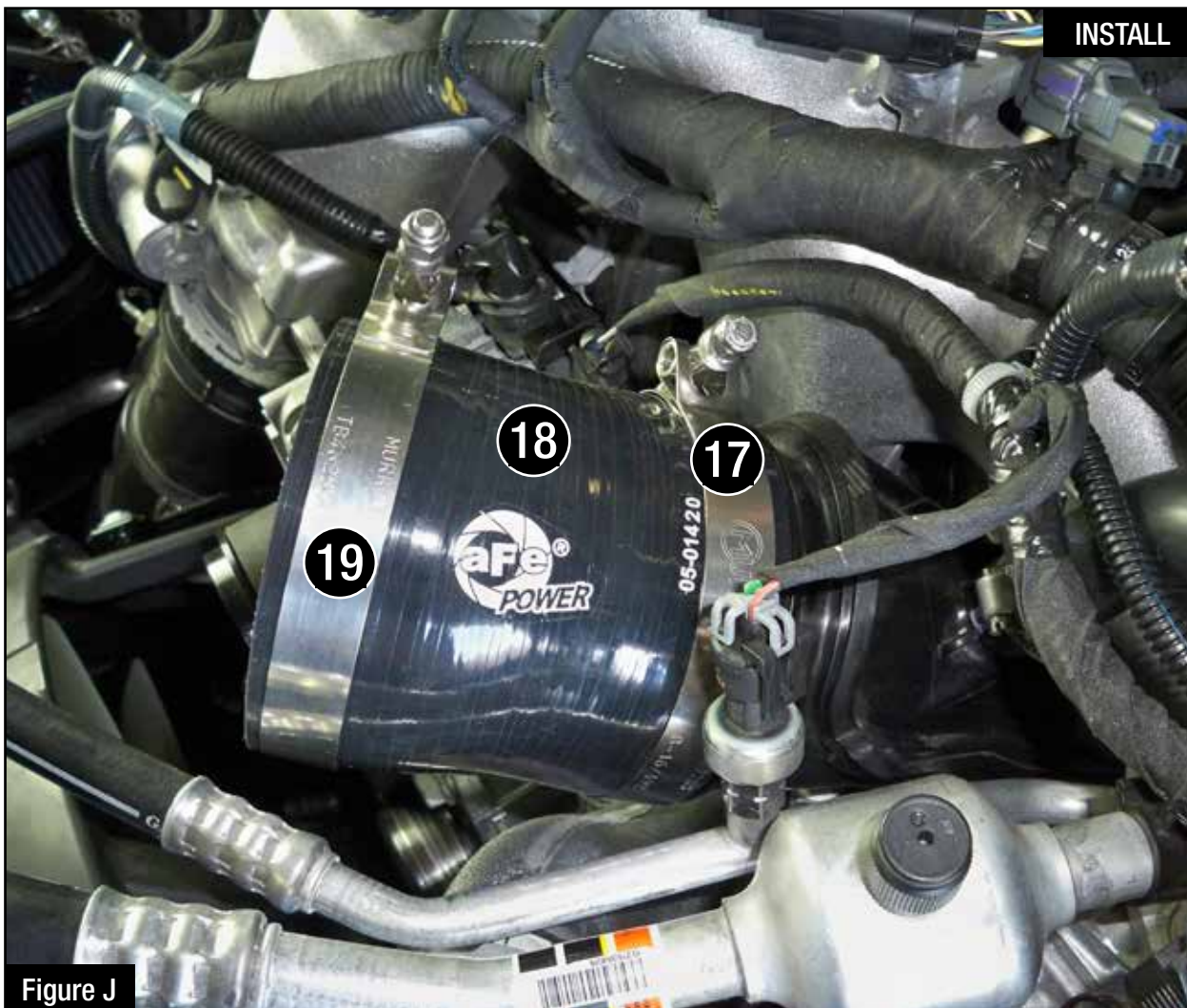

Figure J

**Refer to Figure J for Step 14**

Step 14: If the resonator is removed, install the supplied small clamp (17), coupler (18) and large clamp. (19)



Figure K

**Refer to Figure K for Steps 15-16**

Step 15: Slide the intake tube into the filter and then into the coupler.

Step 16: Align the intake tube correctly then tighten all clamps.



**Refer to Figure L for Steps 17-19**

Step 17: Install scoop with the rubber seal (20) on top of the airbox.

Step 18: Reconnect the MAF sensor harness. (21)

Step 19: Make sure all clamps and connections are secured. Your installation is now complete! Thank you for choosing aFe POWER.

**NOTE: Check all bolts, clamps, and connectors after 200 miles.**



PAGE LEFT BLANK INTENTIONALLY

PAGE LEFT BLANK INTENTIONALLY



Pro DRY S Air Filter



P/N: 21-91059

Pro 5R Air Filter



P/N: 20-91059

Pro DRY S Restore Kit



P/N: 90-59999

Blue Squeeze Restore Kit



P/N: 90-50501

Blue Aerosol Restore Kit



P/N: 90-50001

Rebel XD Series Exhaust



P/N: 49-44089-B (Blk. Tips)  
49-44089-P (Pol. Tips)

Downpipe Back Exhaust



P/N: 49-44087-B (Blk. Tip)  
49-44087-P (Pol. Tip)

DPF-Back Exhaust



P/N: 49-44085-B (Blk. Tip)  
49-44085-P (Pol. Tip)

Sprint Booster V3.



P/N: 77-14003

DFS Fuel System



P/N: 42-14023 (Full-Time)  
42-14024 (Part-Time)

SCORCHER HD Module



P/N: 77-44010

Rear Differential Cover



P/N: 46-70012-WL (w/ Oil)

To purchase any of the items above, view airflow charts, dyno graphs, photos, and video; please go to [aFepower.com](http://aFepower.com).

# Warranty

## General Terms:

- aFe warrants their products to be free from manufacturer's defects due to workmanship and material.
- This warranty applies only to the original purchaser of the product and is non-transferrable.
- Proof of purchase of the aFe product is required for all warranty claims.
- Warranty is valid provided aFe instructions for installation and/or cleaning were properly followed.
- Proper maintenance with regular inspections of product is required to insure warranty coverage.
- Damage due to improper installation, abuse, unauthorized repair or alteration is not warranted.
- Incidental or consequential damages or cost, including installation and removal of part, incurred due to failure of aFe product is not covered under this warranty.
- All warranty is limited to the repair and/or replacement of the aFe part. To request Return Goods Authorization ("RGA"), email [RGA@afepower.com](mailto:RGA@afepower.com) or call (951)493-7100. Upon receipt of the RGA, you must return the product to the address provided in the RGA, freight prepaid and accompanied with a dated proof of purchase and the RGA. Upon receipt of the defective product and upon verification of proof of purchase, aFe will either repair or replace the defective product within a reasonable time, not to exceed thirty days.

<b>Product Category</b>	<b>P/N Prefix</b>	<b>Warranty duration</b>
Direct OE Replacement Filters	10, 11, 30, 31, 71, 73	Life of the vehicle
Racing Filters	18	1 year
Universal	21, 24, 72	2 years
Air Intake Systems	50, 51, 54, 55, 75	2 years
Exhaust Systems	49	2 years
Intercoolers & Intercooler Tubes	46-2	2 years
Intake Manifolds	46-1	2 years
Differential Cover	46-7	Life of the vehicle
Exhaust Manifolds	46	2 years
Throttle Body Spacers	46-3	2 years
Fluid Filters	44	90 days
Pre-Filters	28	2 years
Heavy Duty OE Replacement	70	2 years
PowerSports OE Replacement	81, 87	2 years
PowerSports Intake Systems	85	2 years

No other warranty expressed or implied applies nor is any person or advanced FLOW engineering authorized to assume any other warranty. Some States do not allow the exclusion or limitation of incidental or consequential damages or do not allow limitations on how long an implied warranty lasts, so the above limitations or exclusions may not apply to you. This warranty gives you specific legal rights, and you may also have other rights which vary from State to State.



**advanced FLOW engineering, inc.**  
252 Granite Street Corona, CA 92879  
TEL: 951.493.7100 • TECH: 951.493.7134  
E-Mail: [Tech@aFepower.com](mailto:Tech@aFepower.com)