



Performance Oil Catch Can Kit

Part Number: 860-008

Subaru 2017-2021 WRX STI 2.5L Turbo

Installation Instructions

For technical inquiries please email us at tech@hpsperformance.com

In the email, please include the following information for faster response:

- Year / Make / Model / Engine of your vehicle
- If it is a fitment issue, please include pictures showing the fitment problem
- If there are missing parts, please list the part number(s) from the bill of materials on the 2nd page
- Optional but recommended – Your contact phone number and preferred call back time

You can also give us a call via 626-747-9200 for tech support Monday-Friday, 9:00am-5:00pm Pacific Time.

Bill of Materials

Kit Number: 860-008

Line #	Description	Part Number	Qty
1	Oil Catch Can	OCC-14	1
2	Oil Catch Can Bracket	OCC-BRKT-012	1
3	Bolt, M5 x 0.8, 10mm Long	HW-B5-10	3
4	Embossed Hose Clamp, 12mm - 22mm	EMSC-12-22	2
5	Straight Aluminum Adapter, -8 to 16mm x 1.50	AN816-8-M1615	2
6	Push-On Aluminum Hose End, AN-8, 30 Degree	150-3008	1
7	Push-On Aluminum Hose End, AN-8, 60 Degree	150-6008	1
8	Push On Hose, AN-8	150-08	14.5 inches
9	Push On Hose, AN-8	150-08	17 inches

- **Before installing any parts of this oil catch can kit, please read the instructions thoroughly.**
- **Verify the contents of this oil catch can kit before disassembling your vehicle.**
- **DO NOT INSTALL IF ANY PARTS ARE MISSING OR DAMAGED. CONTACT tech@hpsperformance.com IMMEDIATELY. WE ARE NOT RESPONSIBLE FOR ANY DAMAGE CAUSED DUE TO IMPROPER INSTALLATION.**
- **Installation requires moderate mechanical skills. A qualified mechanic is highly recommended.**
- **Do not attempt to install the catch can while the engine is hot.**
- **This installation may require removal of coolant lines that may be hot.**
- **For technical inquiries, please email us at tech@hpsperformance.com**

PLEASE READ CAREFULLY BEFORE INSTALLATION!

This installation is not for the novice customer. Install this product with EXTREME caution! Misuse of this product can destroy your engine! If you are not mechanically inclined, please have a professional automotive mechanic install this kit.

NOTE: HPS holds no responsibility for any engine damage that results from misuse of this product.

GETTING STARTED

1. Turn the ignition OFF and disconnect the vehicle's negative battery cable. If the engine has run within the past two hours let it cool down.

NOTE: Disconnecting the negative battery cable erases pre-programmed electronic memories. Write down all memory settings before disconnecting the negative battery cable. Some radios will require an anti-theft code to be entered after the battery is reconnected. The anti-theft code is typically supplied with your owner's manual. In the event your vehicle's anti-theft code cannot be recovered, contact an authorized dealership to obtain your vehicle's anti-theft code. We also highly recommend NOT discarding any stock parts after the installation.

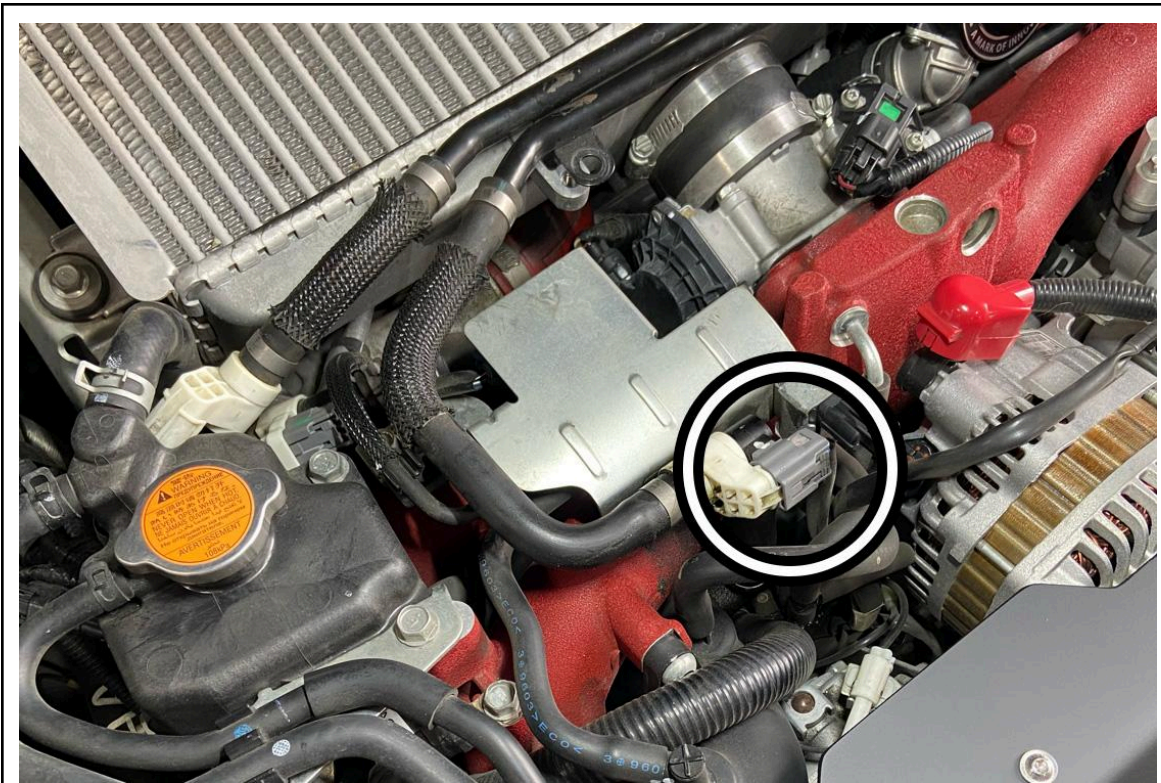

2. Disconnect the electrical connector from the PCV solenoid.



3. Carefully pull on the hose to disconnect it from the hardline. Then, pull the hose from the solenoid. Remove the hose from the vehicle.



4. Reconnect the PCV solenoid back onto the electrical connector.

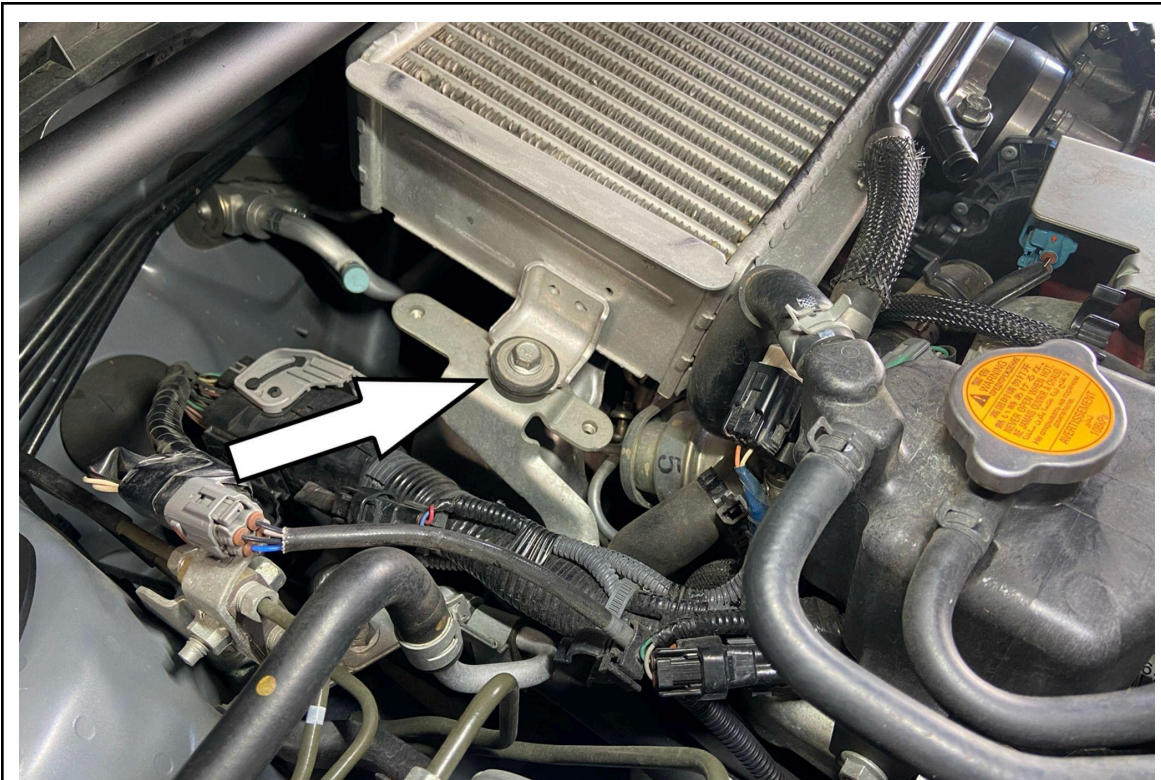

5. Remove the passenger side intercooler mounting bolt.

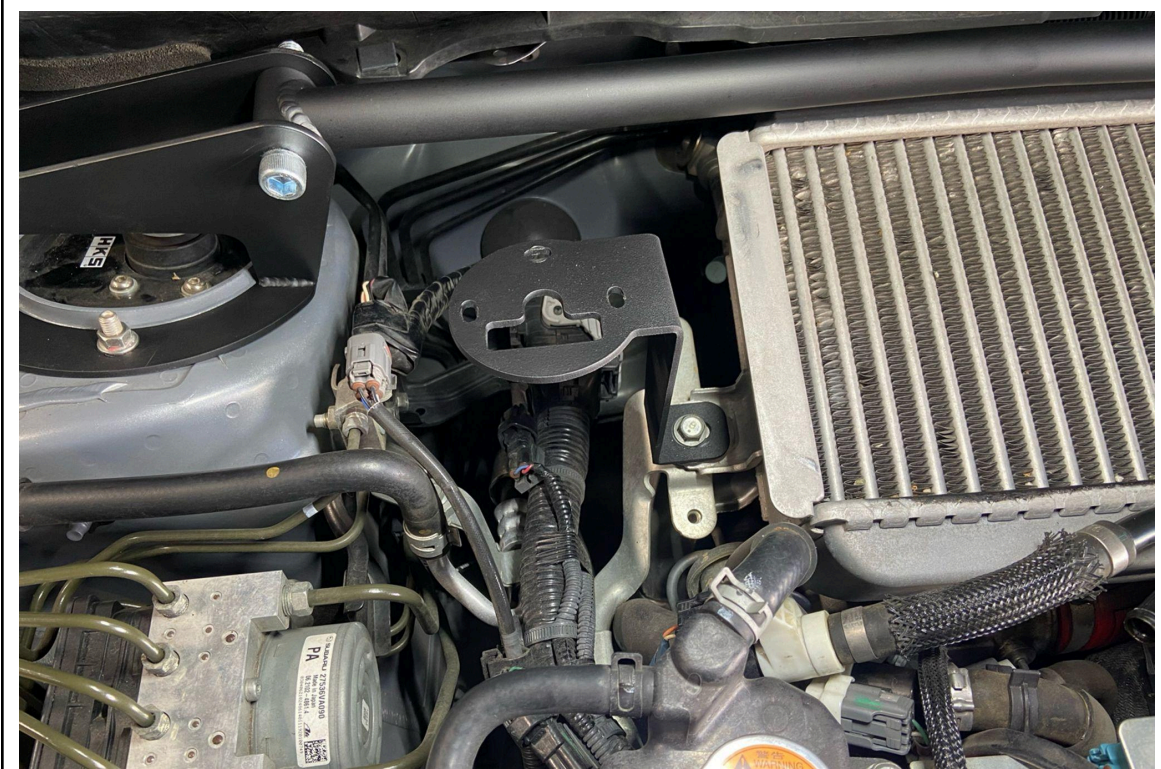

6. Secure the oil catch can bracket onto the intercooler mount using the factory bolt.

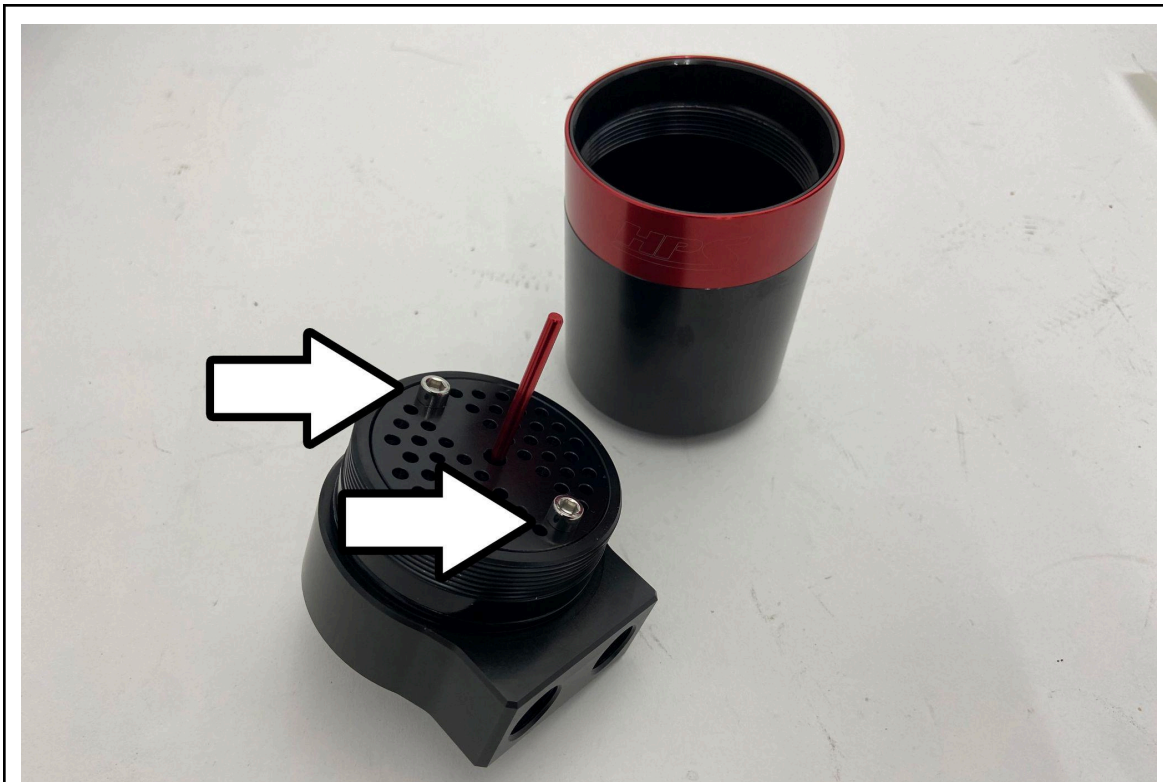

7. Unscrew the top of the HPS oil catch can and check that the Allen bolts are tight.



8. Secure the two M16 to AN-8 adapter fittings and washers onto the oil catch can.

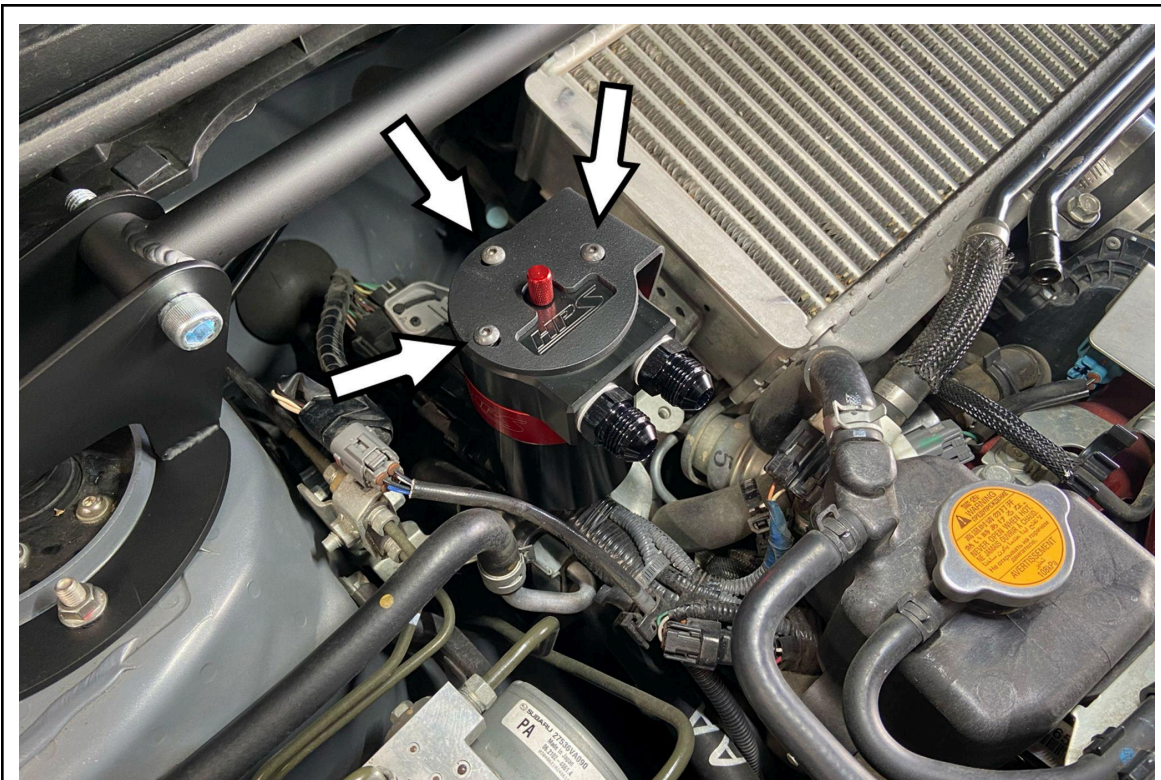

9. Secure the oil catch can to the bracket using the three provided M5 bolts.



10. Push the 30 degree AN-8 hose end fitting into the provided 14.5" inch long hose. Slip one of the provided embossed clamps onto the other end of the hose.

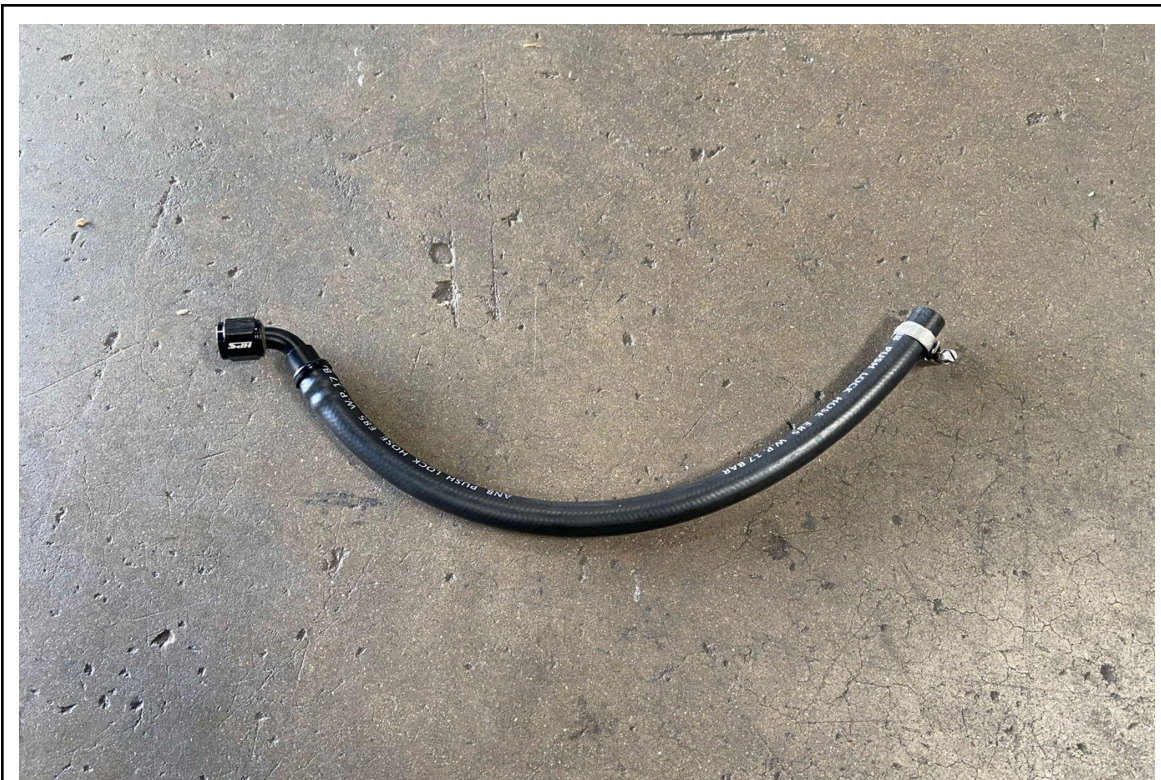

11. Push the 60 degree AN-8 hose end fitting into the provided 17" inch long hose. Slip one of the provided embossed clamps onto the other end of the hose.

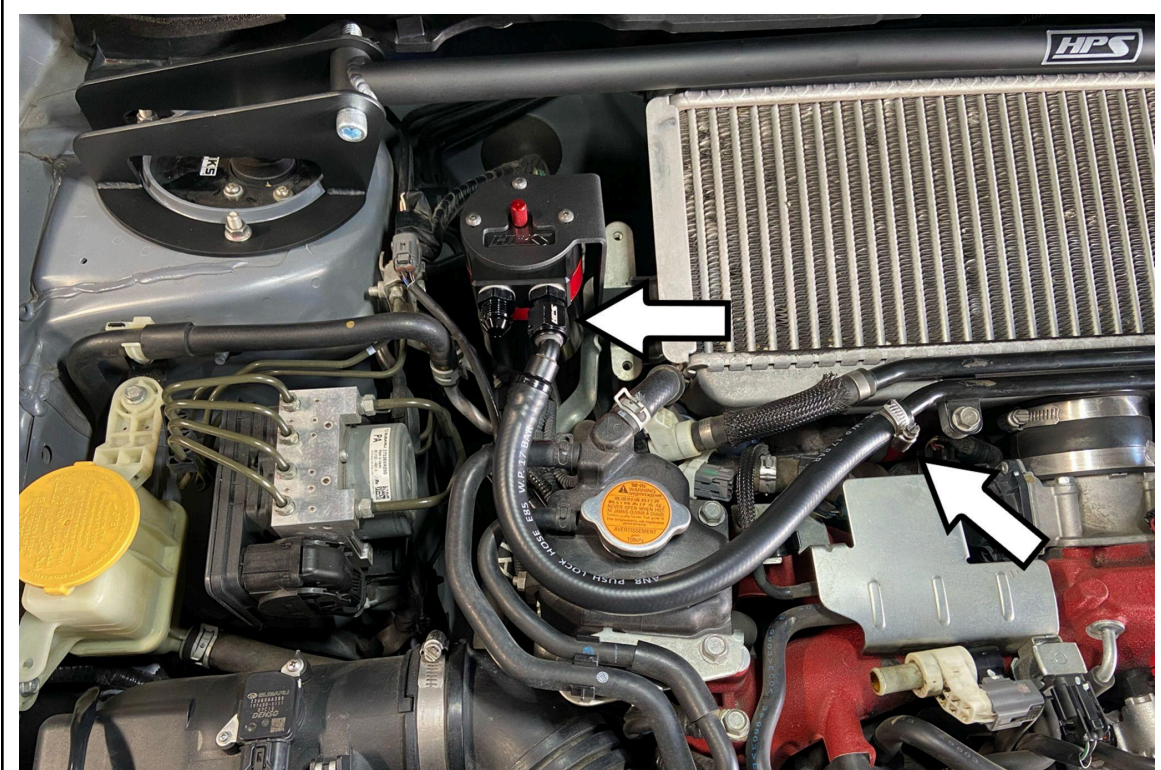

12. Fasten the 30 degree AN fitting onto the driver side of the oil catch can. Then, push the hose onto the PCV hardline and tighten the hose clamp.

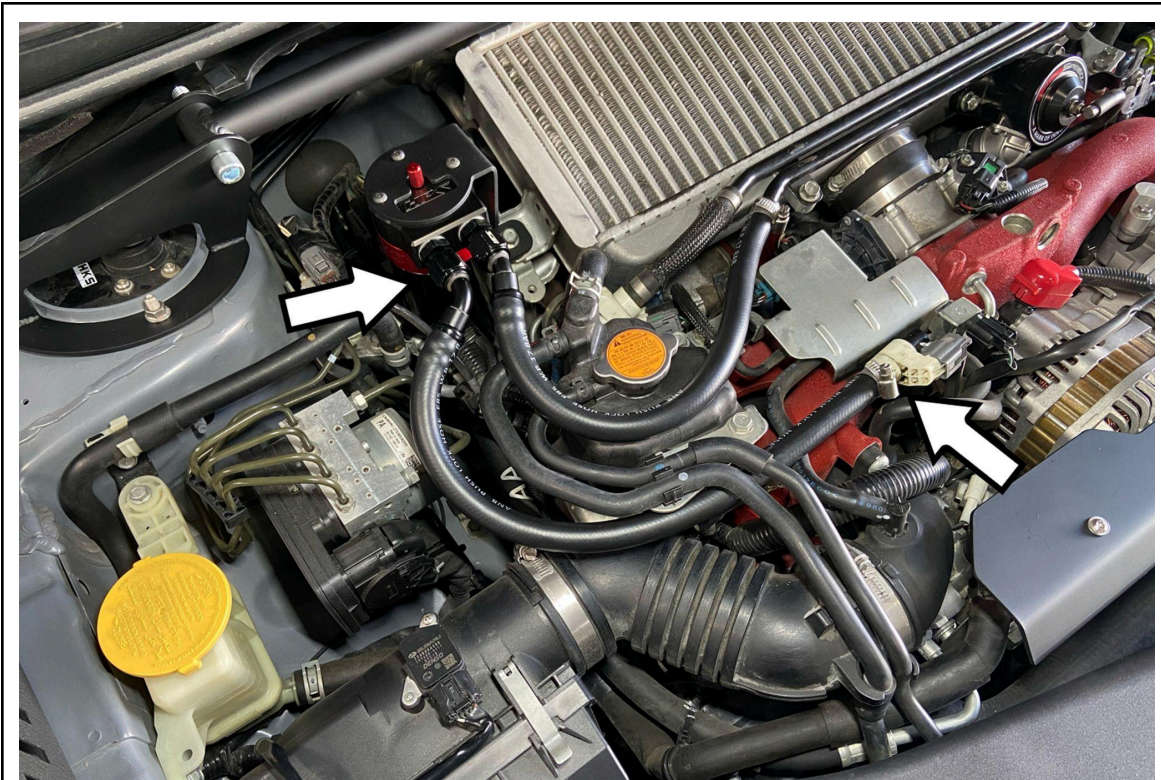

13. Fasten the 60 degree AN fitting onto the passenger side of the oil catch can. Then, push the hose onto the PCV solenoid and tighten the hose clamp.

FINAL STEPS

Upon completion of the installation, reconnect the negative battery terminal before you start the engine. Double check to make sure everything is tight and properly positioned before starting the vehicle.

Start the engine. Let the car idle for 3 minutes. Perform a final inspection before driving. Listen carefully for any odd noises or rattles prior to taking it for a test drive. If any problems arise, go back and check the hoses and clamps that may be causing the issue and correct the problem.

Ensure that the dipstick on the HPS oil catch can is fully seated. Failure to install the dipstick properly will result in a check engine light and poor performance.

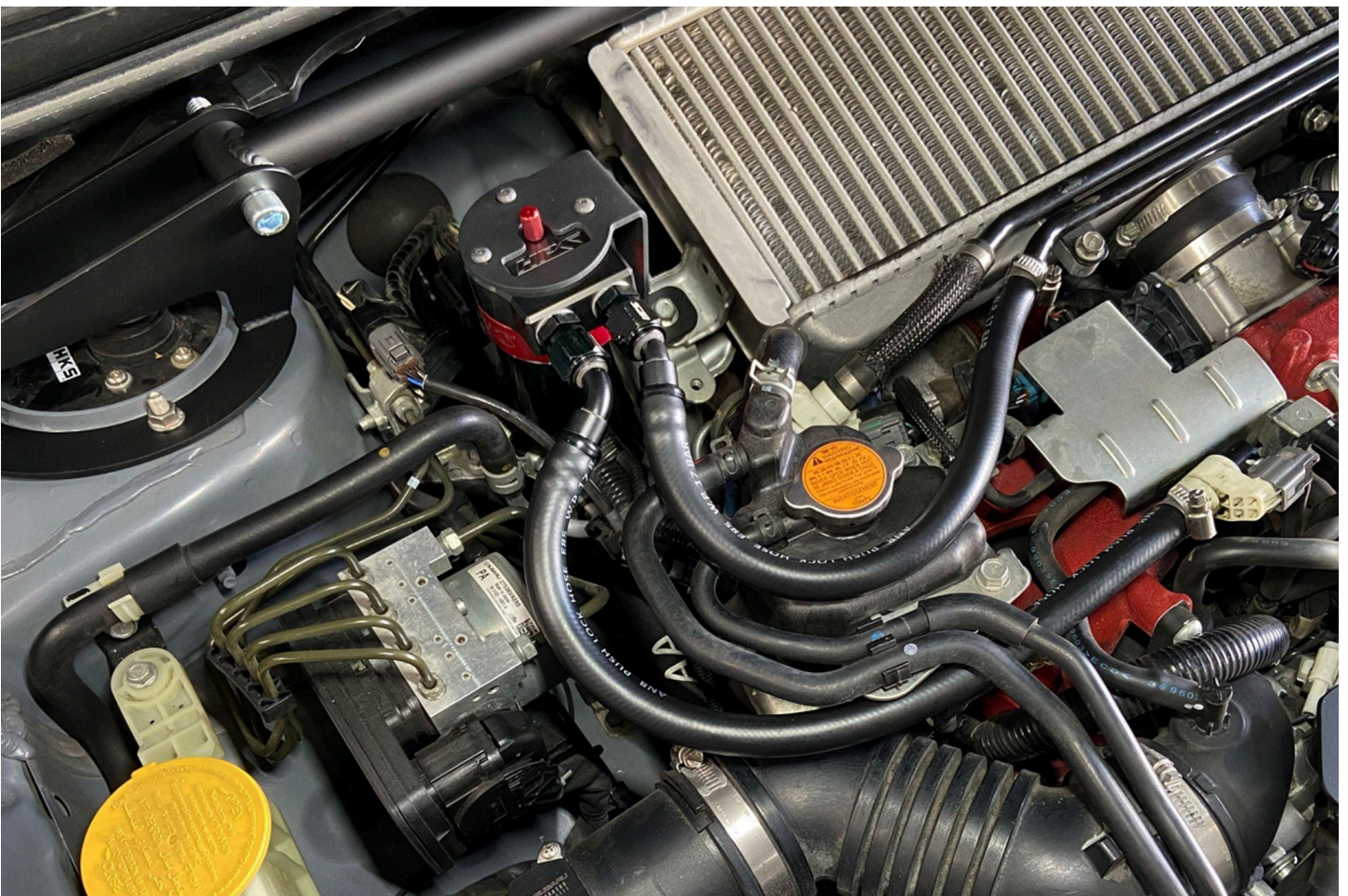

**Also available for
Subaru 2017-2021 WRX STI 2.5L Turbo**



HPS Performance Air Intake Kit
Part Number [837-573](#)



HPS Silicone Radiator + Heater Hose Kit
Part Number [57-1516](#)



HPS Performance Panel Air Filter
Part Number [HPS-452421](#)



**HPS Performance Stainless Steel Magnetic
Oil Drain Plug**
Part Number [MDP-M20x150](#)

Contact an authorized HPS Performance dealer or
visit us at hpsperformance.com for more details