



Equipped with AEM® Dryflow™ Filter
No Oil Required!

INSTALLATION INSTRUCTIONS

PART NUMBER

21-769C (Gun Metal Gray Finish)

2015-17

JEEP

RENEGADE

2.4L

Not legal for sale or use on any pollution controlled motor vehicle in California or states adopting California emission procedures. See AEMIntakes.com for CARB status on each part for a specific vehicle.

ITEM NO.	PART NUMBER	DESCRIPTION	QTY.
1	20-8562	HEAT SHIELD, JEEP RENEGADE 2.4L, 2015, TB/PC	1
2	21512-1	ADAPTER; UNIVERSAL, 6" FILTER 3.5" COUPLER	1
3	21-209ED-HK	AIR FILTER; 6" X 5" DRYFLOW- W/HOLE	1
4	94104	1/2" BNDHOSE CLAMP, 4.125-7.00"	1
5	5-353	HOSE, ADAPTER 3.00/3.50X3 BLK	1
6	1-3025	WASHER, M6 SPLIT LOCK ZINC	2
7	1-2110	BOLT; HEX/FLANGE M6-1.0 X 12	5
8	8-186-1	MOUNT, PLASTIC AIRBOX, NYLON	3
9	9456	1/2" BNDHOSE CLAMP, 3.15"-4.00"	1
10	9448	1/2" BNDHOSE CLAMP, 2.56"-3.50"	1
11	2-1550C	INTAKE TUBE; 2.75"OD X 35", 21-769; GUNMETAL GRAY	1
12	5-272	HOSE, SILICONE 2.75X2" BLACK	1
13	784645	GROMMET, PCV 3/4"ID 1-3/8"OD	1
14	8-139	CONNECTOR, PLASTIC 3/4" 90DEG	1
15	9444	HOSE CLAMP, 2.31-3.25"	2
16	1-3036	WASHER, M8 SPLIT LOCK ZINC	3
17	08557	HOSE CLAMP; SPRING BAND 28MM X 12MM	1
18	21781	EXTENSION HARNESS; 44"L DODGE IAT	1
19	102496	EDGE TRIM; 3/4" BULB, TOP LOC, 39"L	1
20	8-4008	EDGE TRIM, 8"	1
21	1-113	ZIP TIE, 6 LONG	3
22	07733	BOLT; M4 - 0.07 8MM, A/H CAP, SS	2
23	09076	GASKET; MASS AIR SENSOR, 57-9027	1
24	21508	BLOCK OFF PLATE; MASS AIR SENSOR, 57-9027	1

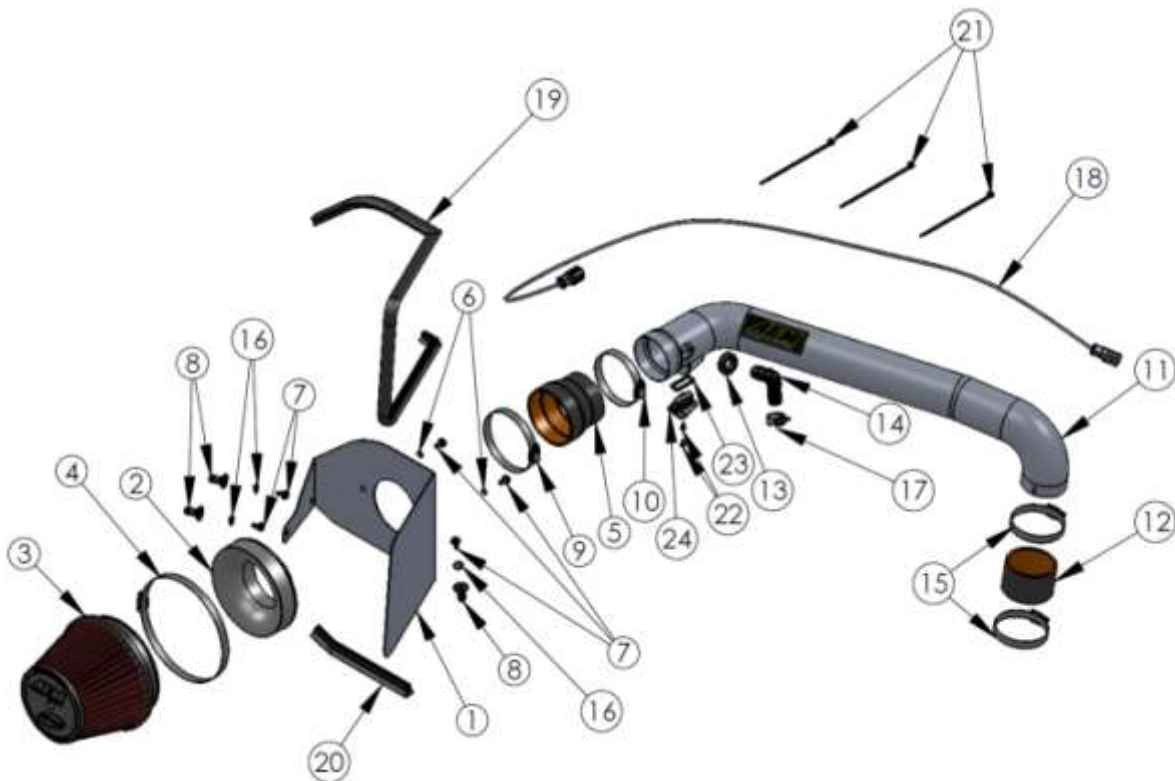

Read and understand these instructions **BEFORE** attempting to install this product. Failure to follow installation instructions and not using the provided hardware may damage the intake tube, throttle body and engine.

1. Preparing Vehicle

- a. Make sure vehicle is parked on level surface.
- b. Set the parking brake.
- c. If engine has run in the past two hours, let it cool down.
- d. Disconnect negative battery terminal.
- e. Do not discard stock components after removal of the factory system.
- f. Open the air intake kit package and make sure all parts are included.

Tools Needed:

Screw driver
10MM socket
8MM socket
Socket Driver
Side Cutters
Pliers

2. Removal of stock system



a. Remove the M6 bolt shown. Pull up on the engine cover to detach it from the mounting grommets.



b. Remove the indicated mounting bolt securing the stock intake tube to the engine.



c. Carefully detach the crankcase breather and humidity sensor electrical connector if so equipped from the intake tube.



d. Unclip the rubber hose shown from the intake tube. Disconnect the IAT harness from the sensor and loosen the hose clamp on the throttle securing the intake tube.



e. Use a flathead screwdriver to detach the inlet duct from the lower air box.



f. Carefully remove the stock intake assembly from the engine bay.



g. Remove the IAT sensor by tilting the lock tab away from the step feature and twist counter-clockwise . Sensor will be reinstalled in a later step.



h. Remove the humidity sensor from the air box with Phillips screw driver if so equipped . Sensor will be reinstalled in a later step.

3. Installation of AEM® intake system.

a. When installing the intake system, do not completely tighten the hose clamps or mounting hardware until instructed to do so.



a. Carefully install the IAT sensor into the endcap of the AEM filter. **Note: Soapy water will help with installation.**



b. Install the supplied edge trim(102496, 8-4008) as shown and trim accordingly if needed with side cutters.



c. Fasten the supplied plastic mounts(8-186-1) to the heat shield as shown using the supplied split washers(1-3036) and M6 bolts(1-2110).



d. Orient and fasten the air horn(21512-1) to the heat shield as shown with the split washers(1-3025) and bolts (1-2110) included in the kit.



e. Install the heat shield as shown into the original air box mounting grommet locations.



f. Extend the stock IAT wire harness by installing the extension(21781) provided and fasten as indicated using the provided zip ties(1-113).



g. Install the supplied coupler(5-272) and fasten using the hose clamp(9444) as shown. Loosely slide the other hose(9444) clamp over the other end of the coupler.



h. Pre-assemble the AEM tube as shown, installing the provided coupler(5-353), hose clamps(9448, 9456), rubber grommet(784645) and plastic elbow(8-139).



i. If equipped with humidity sensor, install the sensor into the sensor pad as shown with supplied hardware otherwise install block-off plate with supplied gasket and hardware as shown.



i. If equipped with humidity sensor, attach the electrical connector at this time otherwise proceed to next installation step.



i. Install the AEM tube into position, lining the inlet end up to the air horn and outlet end to the throttle coupler.



j. Remove the original crank case elbow connection from the rubber hose as shown.



k. Connect the breather hose to the plastic elbow and fasten using the provided spring clamp(08557).



l. Install the air filter and hose clamp(94104) as shown. Connect the IAT harness(21781) to the sensor and check for clearance.



m. Check the harness clearance and snip off excess tabs on zip ties. Reinstall the engine cover and fasten with the stock bolt.



o. Factory air induction system.



p. Finished installation of AEM Intake System.

4. Reassemble Vehicle

- a. Position the inlet pipes for the best fitment. Be sure that the pipes or any other components do not contact any part of the vehicle.
- b. Check for proper hood clearance. Re-adjust pipes if necessary and re-tighten them.
- c. Inspect the engine bay for any loose tools and check that all fasteners that were moved or removed are properly tightened.
- d. Reconnect negative battery terminal and start engine. Let the vehicle idle for 3 minutes. Perform a final inspection before driving the vehicle.

5. Service and Maintenance

- a. AEM Induction Systems requires cleaning the intake system's air filter element every 100,000 miles. When used in dusty or off-road environments, our filters will require cleaning more often. We recommend that you visually inspect your filter once every 25,000 miles to determine if the screen is still visible. When the screen is no longer visible some place on the filter element, it is time to clean it. To clean, purchase our Synthetic air filter cleaner, part number 1-1000 and follow the easy instructions.
- b. Use window cleaner to clean your powder coated AEM[®] intake tube.

NOTE: DO NOT USE aluminum polish on powder coated AEM[®] intake tubes.

For technical inquiries
e-mail us at
sales@aemintakes.com
or
call us at
800.992.3000

AEM Air Intake System Warranty Policy

AEM® warrants that its intake systems will last for the life of your vehicle. AEM® will not honor this warranty due to mechanical damage (i.e. improper installation or fitment), damage from misuse, accidents or flying debris. AEM® will not warrant its powder coating if the finish has been cleaned with a hydrocarbon-based solvent. The powder coating should only be cleaned with a mild soap and water solution. Proof of purchase of both the vehicle and AEM® intake system is required for redemption of a warranty claim.

This warranty is limited to the repair or replacement of the AEM® part. In no event shall this warranty exceed the original purchase price of the AEM® part nor shall AEM® be responsible for special, incidental or consequential damages or cost incurred due to the failure of this product. Warranty claims to AEM® must be transportation prepaid and accompanied with dated proof of purchase. This warranty applies only to the original purchaser of product and is nontransferable. Improper use or installation, use for racing, accident, abuse, unauthorized repairs or alterations voids this warranty. AEM® disclaims any liability for consequential damages due to breach of any written or implied warranty on all products manufactured by AEM®. Warranty returns will only be accepted by AEM® when accompanied by a valid Return Merchandise Authorization (RMA) number. Credit for defective products will be issued pending inspection. Product must be received by AEM® within 30 days of the date RMA is issued.

If you have a warranty issue, please call (800) 992-3000 and our customer service department will assist you. A proof of purchase is required for all AEM® warranty claims.

Not legal for sale or use on any pollution controlled motor vehicle in California or states adopting California emission procedures. See AEMIntakes.com for CARB status on each part for a specific vehicle.