



Equipped with AEM® Dryflow™ Filter
No Oil Required!

INSTALLATION INSTRUCTIONS

PART NUMBER

21-808C (GUN METAL GRAY FINISH)

2015-16

Subaru

Legacy

2.5L

Not legal for sale or use on any pollution controlled motor vehicle in California or states adopting California emission procedures. See AEMIntakes.com for CARB status on each part for a specific vehicle.

ITEM NO.	PART NUMBER	DESCRIPTION	QTY.
1	2-1592C	Intake Tube; 2.75" OD x 49" 21-808 Gunmetal	1
2	20-8590	Heat Shield; 2015 Subaru Legacy 2.5L	1
3	21-2027DK	AIR FILTER; 2.75" X 7" DRYFLOW	1
4	08185	Hose; 2.75" ID x 2.50" L Hump Reinforced	1
5	5-5008	Hose; 1/2" x 8" L	1
6	8-117	Connector; Plastic 1/2" Blk	1
7	102466	Edge Trim; 1/16" Gap 12"	1
8	1228599	Mount; Rubber 1" X 6mm	1
9	9444	Hose Clamp; 2.31"-3.25"	2
10	9448	Hose Clamp; 2.56"-3.50"	1
11	22224	Bolt; M6-1.00x12 Hex; Flg Grade 10.9	3
12	444.460.04	Nut; M6 Hex Serrated	2
13	08160	Washer; 1" Dx1/4" Hole Fender	1
14	1-2051	Bolt; BTH HD M4-0.7 X 6mm	2

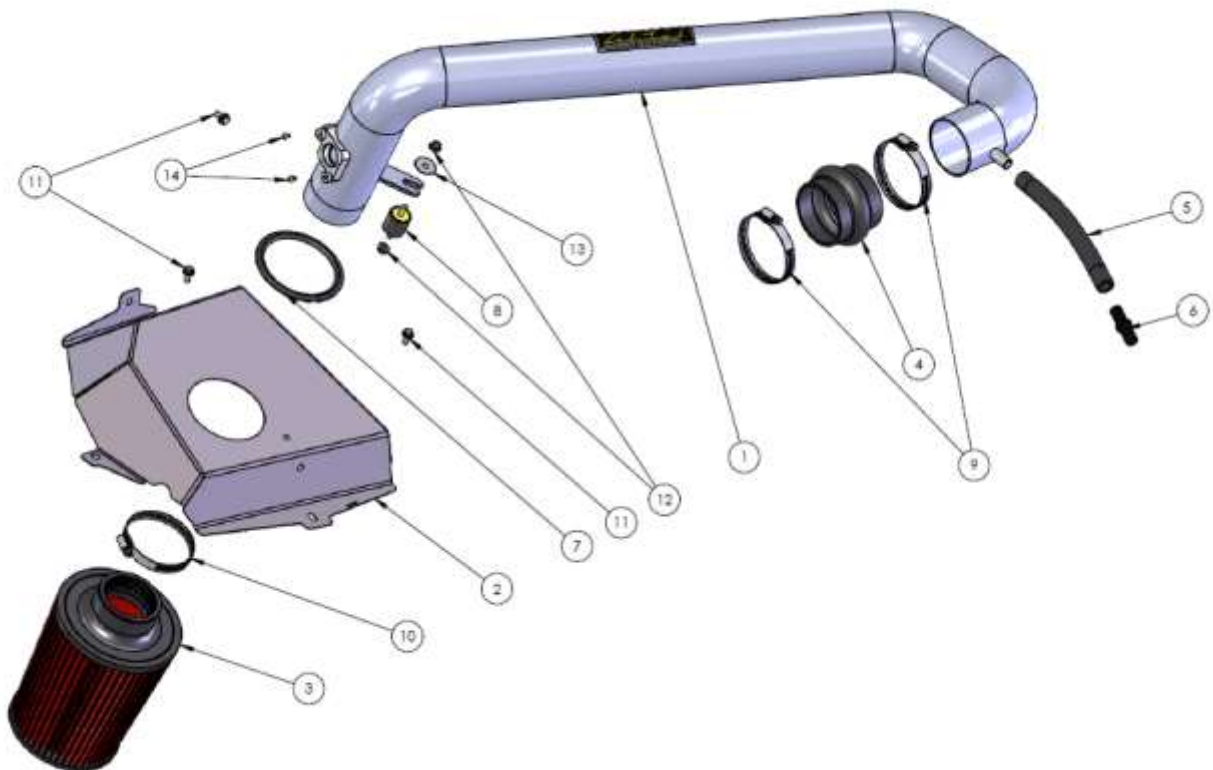

Read and understand these instructions **BEFORE** attempting to install this product. Failure to follow installation instructions and not using the provided hardware may damage the intake tube, throttle body and engine. If you need any assistance please call 1-800-858-3333 to speak with a representative in our Customer Service Center before returning the product.

1. Preparing Vehicle

- Make sure vehicle is parked on level surface.
- Set the parking brake.
- If engine has run in the past two hours, let it cool down.
- Disconnect negative battery terminal.
- Do not discard stock components after removal of the factory system.
- Open the air intake kit package and make sure all parts are included.

Tools Needed:

8mm Nut Driver	Pliers
10mm Socket	Bladed Screwdriver
Socket Driver	Ratchet with Extension
#2 Screwdriver	
4mm Hex Key	

2. Removal of stock system



a. Disconnect the plug from the Mass Air Flow (MAF) sensor by pushing on the clip and pull.



b. Remove the 2 clips that secure the intake scoop.



c. Remove the 2 bolts that secure the air box with a 10mm socket, 1/4" extension, and ratchet. Then pull up on the air box to remove from the rubber grommets.



d. Remove the clip that secures the resonator. Also, loosen the hose clamp on the intake tube with an 8mm socket driver.



e. Remove the vent hose from the resonator nipple by using pliers to relieve pressure on the hose clamp.



f. Remove the stock intake system from the vehicle. **Do not discard any factory intake components.**



g. Remove the air box bracket bolt with a 10mm socket and ratchet. The bracket will not be reused.



h. Remove the two screws that secure the MAF sensor. Then, set the MAF sensor aside for later installation.

3. Installation of AEM® intake system.

a. When installing the intake system, do not completely tighten the hose clamps or mounting hardware until instructed to do so.



a. Install the hose coupler and 2 hose clamps onto the throttle body. Tighten clamp on the throttle body.



b. Install the MAF sensor to the intake tube with the 2 supplied socket head bolts.



c. Install the edge trim and rubber mount to the heat shield as shown.



d. Route the intake tube through the cut out on the heat shield and install the air filter.



e. Secure the intake tube to the rubber mount by tightening the nut with a 10mm socket and ratchet.



f. Install the AEM intake tube into the coupler. DO NOT FULLY TIGHTEN THE HOSE CLAMP AT THIS TIME.



g. Align the heat shield for proper fitment, then secure with 3 supplied M6 bolts. Then, tighten the clamp in 3f.



h. Install the plastic connector to the vent hose as shown.



i. Attach the 8" extended hose to the plastic connector then to the intake tube.



j. Reconnect the MAF sensor plug to the sensor.



STOCK INTAKE INSTALLED



AEM INTAKE INSTALLED

4. Reassemble Vehicle

- a. Position all kit components for best fitment. Ensure that no components contact any unintended part of the vehicle.
- b. Check for proper hood clearance. Re-adjust components if necessary and re-tighten them.
- c. Inspect the engine bay for any loose tools and ensure that all fasteners that were moved or removed are properly tightened.
- d. Reconnect negative battery terminal and start engine. Let the vehicle idle for 3 minutes. Perform a final inspection before driving the vehicle.

5. Service and Maintenance

- a. AEM Induction Systems requires cleaning the intake system's air filter element every 100,000 miles. When used in dusty or off-road environments, our filters will require cleaning more often. We recommend that you visually inspect your filter once every 25,000 miles to determine if the screen is still visible. When the screen is no longer visible some place on the filter element, it is time to clean it. To clean, purchase our Synthetic air filter cleaner, part number 1-1000 and follow the easy instructions.
- b. Use window cleaner to clean your powder coated AEM[®] intake tube.

NOTE: DO NOT USE aluminum polish on powder coated AEM[®] intake tubes.

For technical inquiries
e-mail us at
sales@aemintakes.com
or
call us at
800.992.3000

AEM Air Intake System Warranty Policy

AEM® warrants that its intake systems will last for the life of your vehicle. AEM® will not honor this warranty due to mechanical damage (i.e. improper installation or fitment), damage from misuse, accidents or flying debris. AEM® will not warrant its powder coating if the finish has been cleaned with a hydrocarbon-based solvent. The powder coating should only be cleaned with a mild soap and water solution. Proof of purchase of both the vehicle and AEM® intake system is required for redemption of a warranty claim.

This warranty is limited to the repair or replacement of the AEM® part. In no event shall this warranty exceed the original purchase price of the AEM® part nor shall AEM® be responsible for special, incidental or consequential damages or cost incurred due to the failure of this product. Warranty claims to AEM® must be transportation prepaid and accompanied with dated proof of purchase. This warranty applies only to the original purchaser of product and is nontransferable. Improper use or installation, use for racing, accident, abuse, unauthorized repairs or alterations voids this warranty. AEM® disclaims any liability for consequential damages due to breach of any written or implied warranty on all products manufactured by AEM®. Warranty returns will only be accepted by AEM® when accompanied by a valid Return Merchandise Authorization (RMA) number. Credit for defective products will be issued pending inspection. Product must be received by AEM® within 30 days of the date RMA is issued.

If you have a warranty issue, please call (800) 992-3000 and our customer service department will assist you. A proof of purchase is required for all AEM® warranty claims.

Not legal for sale or use on any pollution controlled motor vehicle in California or states adopting California emission procedures. See AEMIntakes.com for CARB status on each part for a specific vehicle.