



INSTALLATION INSTRUCTIONS

21-860C (Gun Metal Gray Finish)
FORD
2013-18 Focus ST
L4-2.0L Turbo

NOT LEGAL FOR SALE OR USE ON ANY POLLUTION CONTROLLED MOTOR VEHICLE IN CALIFORNIA OR STATES ADOPTING CALIFORNIA EMISSION PROCEDURES.

See aemintakes.com for CARB status on each part for a specific vehicle

TOOLS NEEDED:

Ratchet
 Extension
 8mm socket
 10mm socket
 8mm allen key
 flat blade screw driver

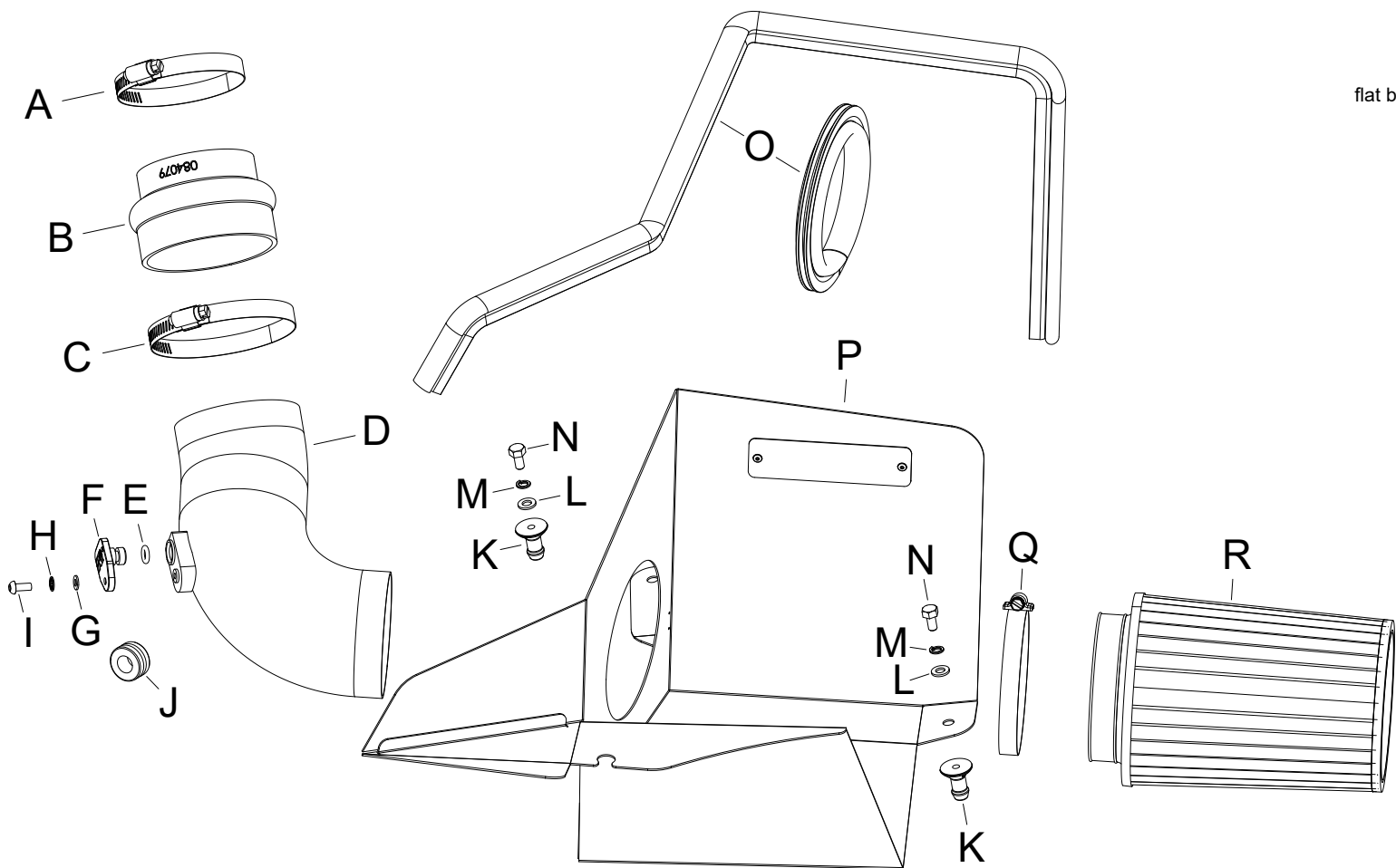

PARTS LIST:

Description	Qty.	Part #	Description	Qty.	Part #	Description	Qty.	Part #
A HOSE CLAMP; #48	1	08601	G WASHER; 5MM FLAT, SS	1	08212	M WASHER; M6 SPLIT LOCK ZINC	2	1-3025
B HOSE; HUMP 3.5" TO 3"ID	1	084079	H WASHER; 5MM STAR CUT	1	07724	N BOLT; M6 X 1.00 X 12MM, SS	2	07727
C HOSE CLAMP; #56	1	08620	I BOLT; M5 X .8 X 12MM, SS	1	07734	O EDGE TRIM; 3/4" BULB, TOP	1	102487
D TUBE; 3.5"OD X 11"L	1	2-1631C	J GROMMET; 1"OD, 1/2"ID, 1/2"	1	08064	P HEAT SHIELD, 2013-18 FORD	1	20-8645B
E O-RING; 0.362"ID X 0.568"OD	1	SPE-OR14	K MOUNT, PLASTIC AIRBOX	2	8-186-1	Q 1/2" BNDHOSE CLAMP, 3.15"	1	9456
F BLOCK OFF PLATE; AIR TEMP	1	21596	L WASHER; 6MM FLAT, SS	2	08269	R AIR FILTER; 3.5" X 7" DRY	1	21-2047DK

If you need any assistance please call 1-800-858-3333 to speak with a representative in our Customer Service Center before returning the product.

Read and understand these instructions BEFORE attempting to install this product. Failure to follow installation instructions and not using the provided hardware may damage the intake tube, throttle body and engine.

TO START:

1. Turn off the ignition and disconnect the negative battery cable.

NOTE: Disconnecting the negative battery cable erases pre-programmed electronic memories. Write down all memory settings before disconnecting the negative battery cable. Some radios will require an anti-theft code to be entered after the battery is reconnected. The anti-theft code is typically supplied with your owner's manual. In the event your vehicles anti-theft code cannot be recovered, contact an authorized dealership to obtain your vehicles anti-theft code.



2. Disconnect the inlet air temperature sensor electrical connection.



3. Unlatch the fresh air intake boot that wraps around the fresh air intake duct at the core support and remove it from the vehicle.



4. Loosen the hose clamp that secures the intake hose to the air filter housing and then disconnect the hose from the housing.



5. Lift up the air filter housing and remove it from the vehicle.

NOTE: AEM recommends that customers do not discard factory air intake.



6. Loosen the hose clamp that secures the intake hose to the turbo inlet tube and then remove the hose from the vehicle.



7. Remove the fresh air intake flange from the core support.

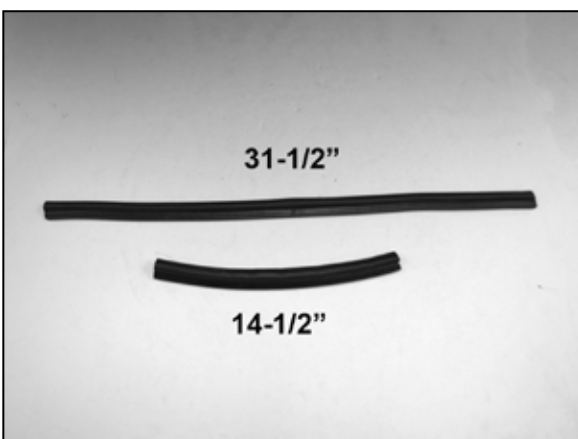

8. Cut the provided edge trim into two sections, one section of 31-1/2" long and one section of 14-1/2" long.



9. Install the edge trim onto the heat shield as shown.



10. Using the provided hardware, install the two provided heat shield mounting studs onto the heat shield as shown.



11. Remove the factory air filter housing mount from the factory housing and install it onto the AEM heat shield as shown.



12. Install the AEM heat shield into the vehicle so that the mounting studs engage the factory mounting grommets.



13. Install the provided hump coupler (084079) onto the factory turbo inlet tube and secure with the provided hose clamp.

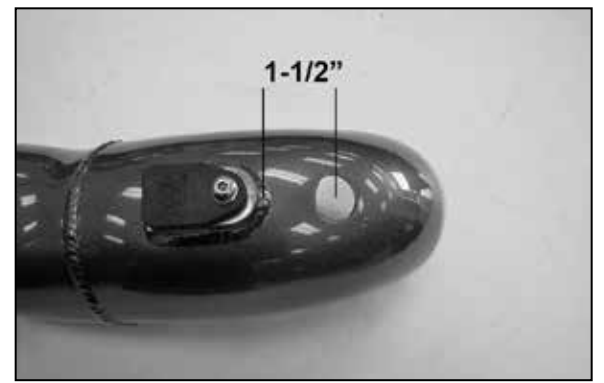

14. On vehicles equipped with a "bolt in" style inlet air temperature sensor, remove the sensor and install it into the AEM intake tube using the provided hardware. If the vehicle is equipped with a "twist in" style inlet air temperature sensor, install the provided block off plate using the provided O-ring and hardware. Measure 1.5" from the bolt in sensor mount and drill a 3/4" id hole. Be sure to remove and burrs from the hole and intake tube. **WARNING: If you bolted in your IAT sensor, do NOT drill a hole in your tube.**



15. Remove the sensor from the factory air filter housing and install it into the AEM intake tube using the provided grommet.



16. Install the AEM intake tube into the coupler and heat shield as shown.



17. Reconnect the inlet air temperature sensor electrical connection.



18. Install the AEM air filter onto the intake tube and secure with the provided hose clamp. Adjust the intake tube and filter for best fit and then secure all hose clamps.



Reassemble Vehicle

Position the inlet pipes for the best fitment. Be sure that the pipes or any other components do not contact any part of the vehicle. Tighten the rubber mount, all bolts, and hose clamps. Check for proper hood clearance. Re-adjust pipes if necessary and re-tighten them. Inspect the engine bay for any loose tools and check that all fasteners that were moved or removed are properly tightened. Reconnect negative battery terminal and start engine. Let the vehicle idle for 3 minutes. Perform a final inspection before driving the vehicle.

Service and Maintenance

AEM Induction Systems requires cleaning the intake system's air filter element every 100,000 miles. When used in dusty or off-road environments, our filters will require cleaning more often. We recommend that you visually inspect your filter once every 25,000 miles to determine if the screen is still visible. When the screen is no longer visible some place on the filter element, it is time to clean it. To clean, purchase our Synthetic air filter cleaner, part number 99-0624 and follow the easy instructions. Use window cleaner to clean your powder coated AEM® intake tube.

NOTE: DO NOT USE aluminum polish on powder coated AEM® intake tubes.

NOT LEGAL FOR SALE OR USE ON ANY POLLUTION CONTROLLED MOTOR VEHICLE IN CALIFORNIA OR STATES ADOPTING CALIFORNIA EMISSION PROCEDURES.

See aemintakes.com for CARB status on each part for a specific vehicle

AEM Air Intake System Warranty Policy

AEM® warrants that its intake systems will last for the life of your vehicle. AEM will not honor this warranty due to mechanical damage (i.e. improper installation or fitment), damage from misuse, accidents or flying debris. AEM will not warrant its powder coating if the finish has been cleaned with a hydrocarbon-based solvent. The powder coating should only be cleaned with a mild soap and water solution. Proof of purchase of both the vehicle and AEM intake system is required for redemption of a warranty claim.

This warranty is limited to the repair or replacement of the AEM part. In no event shall this warranty exceed the original purchase price of the AEM part nor shall AEM be responsible for special, incidental or consequential damages or cost incurred due to the failure of this product. Warranty claims to AEM must be transportation prepaid and accompanied with dated proof of purchase. This warranty applies only to the original purchaser of product and is nontransferable. Improper use or installation, use for racing, accident, abuse, unauthorized repairs or alterations voids this warranty. AEM disclaims any liability for consequential damages due to breach of any written or implied warranty on all products manufactured by AEM. Warranty returns will only be accepted by AEM when accompanied by a valid Return Merchandise Authorization (RMA) number. Credit for defective products will be issued pending inspection. Product must be received by AEM within 30 days of the date RMA is issued.

If you have a warranty issue, please call (800) 992-3000 and our customer service department will assist you. A proof of purchase is required for all AEM warranty claims.