



## INTAKE SYSTEM

# INSTALLATION INSTRUCTIONS

**21-885C**  
**KIA**  
**2021-22 K5**  
**1.6L TURBO**

**NOT LEGAL FOR SALE OR USE ON ANY POLLUTION CONTROLLED MOTOR VEHICLE IN CALIFORNIA OR STATES ADOPTING CALIFORNIA EMISSION PROCEDURES.**

See [aemintakes.com](http://aemintakes.com) for CARB status on each part for a specific vehicle

### TOOLS NEEDED:

Flat blade screw driver  
 Ratchet  
 Extension  
 10mm socket  
 Cutters  
 Pliers  
 10mm wrench  
 9/16" wrench  
 4mm allen

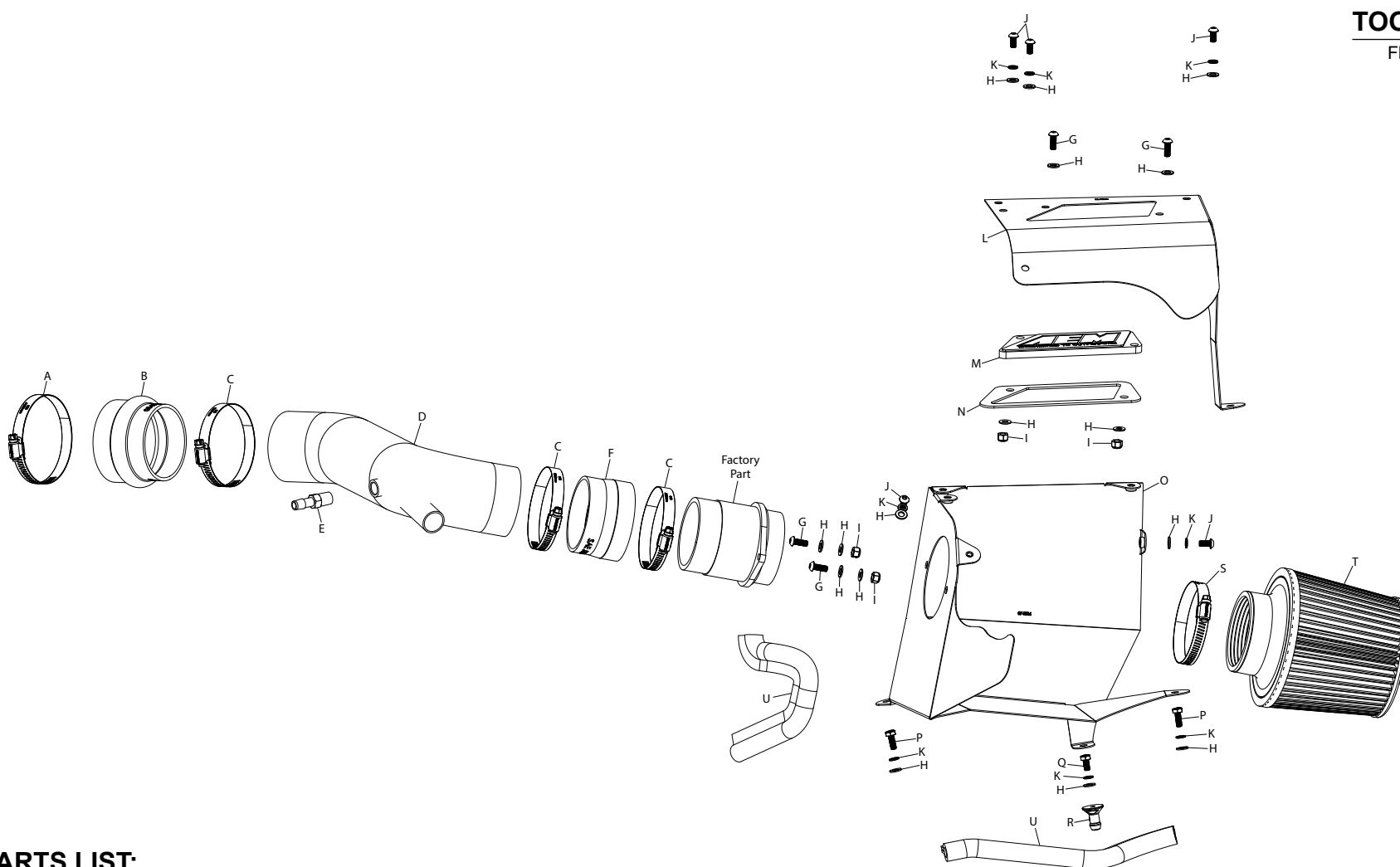

### PARTS LIST:

Description	Qty.	Part #	Description	Qty.	Part #	Description	Qty.	Part #
A HOSE CLAMP; #52	1	08610	H WASHER; 6MM FLAT	16	08269	O HEAT SHIELD	1	074536
B HOSE; HUMP, 3"ID TO 3.25"ID	1	084118	I NUT; 6MM NYLOCK	4	07512	P BOLT; M6-1 X 16MM	2	07812
C HOSE CLAMP; #48	3	08601	J BOLT; M6-1 X 12MM	5	07794	Q BOLT; M6 X 1 X 12MM	1	07727
D INTAKE TUBE; GUNMETAL	1	25862C	K WASHER; M6 SPLIT LOCK	8	1-3025	R MOUNT; PLASTIC AIRBOX	1	8-186-1
E VENT; STRT 3/8" HOSE	1	08047	L HEAT SHIELD; LID	1	074535	S 1/2" BNDHOSE CLAMP	1	9452
F HOSE; 3.125"ID TO 3"ID	1	084031	M PLATE; AEM LOGO, CLEAR	1	8-211-1	T AIR FILTER	1	21-203DK
G BOLT; M6 X 1 X 16MM	4	07730	N SPACER; ALUM CLEAR BADGE	1	7-364	U EDGE TRIM; 33"L	1	102498

**If you need any assistance please call 1-800-858-3333 to speak with a representative in our Customer Service Center before returning the product.**

**Read and understand these instructions BEFORE attempting to install this product. Failure to follow installation instructions and not using the provided hardware may damage the intake tube, throttle body and engine.**

### TO START:

1. Turn off the ignition and disconnect the negative battery cable.

**NOTE: Disconnecting the negative battery cable erases pre-programmed electronic memories. Write down all memory settings before disconnecting the negative battery cable. Some radios will require an anti-theft code to be entered after the battery is reconnected. The anti-theft code is typically supplied with your owner's manual. In the event your vehicles anti-theft code cannot be recovered, contact an authorized dealership to obtain your vehicles anti-theft code.**



2. Pull up the fresh air intake duct to dislodge it from the mounting brackets and then remove it from the vehicle.



3. Disconnect the mass air sensor electrical connection.





4. Release the spring clamps that secure the BOV hose and vent line, then disconnect the lines from the factory intake tube.



5. Loosen the two hose clamps that secure the factory intake tube and then remove the tube from the vehicle.



6. Remove the two bolts that secure the air filter housing and then remove the filter housing from the vehicle.



7. Remove the mass air filter from the factory air filter housing and then remove the O-ring seal from the sensor.



8. Cut the provided edge trim into sections of 11.5", 11" and 9.5". Then install the 9.5" and 11" sections of edge trim onto the heat shield as shown.



9. Install the mounting post to the heat shield using the provided hardware.



10. Using the provided hardware attach the mass air sensor to the heat shield as shown.



11. Install the heat shield assembly into the vehicle so the mounting stud inserts into the mounting grommet, then secure with the provided hardware.



12. Install the provided hump coupler onto the turbo inlet and secure with the provided hose clamp.



13. Install the provided straight coupler onto the mass air sensor and secure with the provided hose clamp.



14. Install the provided vent fitting into the K&N intake tube as shown.



15. Install the intake tube into the hump coupler and then into the straight coupler, adjust for best fit and then secure with the provided hose clamps.



16. Connect the BOV hose and the vent line and secure with the provided spring clamp.



17. Reconnect the mass air sensor electrical connection.



18. Install the air filter onto the mass air sensor and secure with the provided hose clamp.





19. Install the AEM window into the heat shield lid with the spacer between the window and the lid. Secure the assembly with the provided hardware. Install the 11.5 section of edge trim onto the lid as shown.



20. Install the lid onto the lid and secure with the provided hardware.



21. Reinstall the Fresh air intake duct.



#### Reassemble Vehicle

Position the inlet pipes for the best fitment. Be sure that the pipes or any other components do not contact any part of the vehicle. Tighten the rubber mount, all bolts, and hose clamps. Check for proper hood clearance. Re-adjust pipes if necessary and re-tighten them. Inspect the engine bay for any loose tools and check that all fasteners that were moved or removed are properly tightened. Reconnect negative battery terminal and start engine. Let the vehicle idle for 3 minutes. Perform a final inspection before driving the vehicle.

#### Service and Maintenance

AEM Induction Systems requires cleaning the intake system's air filter element every 100,000 miles. When used in dusty or off-road environments, our filters will require cleaning more often. We recommend that you visually inspect your filter once every 25,000 miles to determine if the screen is still visible. When the screen is no longer visible some place on the filter element, it is time to clean it. To clean, purchase our Synthetic air filter cleaner, part number AEM-1-1000 and follow the easy instructions. Use window cleaner to clean your powder coated AEM® intake tube.

**NOTE: DO NOT USE aluminum polish on powder coated AEM® intake tubes.**

NOT LEGAL FOR SALE OR USE ON ANY POLLUTION CONTROLLED MOTOR VEHICLE IN CALIFORNIA OR STATES ADOPTING CALIFORNIA EMISSION PROCEDURES.

See [aemintakes.com](http://aemintakes.com) for CARB status on each part for a specific vehicle

#### AEM Air Intake System Warranty Policy

AEM® warrants that its intake systems will last for the life of your vehicle. AEM will not honor this warranty due to mechanical damage (i.e. improper installation or fitment), damage from misuse, accidents or flying debris. AEM will not warrant its powder coating if the finish has been cleaned with a hydrocarbon-based solvent. The powder coating should only be cleaned with a mild soap and water solution. Proof of purchase of both the vehicle and AEM intake system is required for redemption of a warranty claim.

This warranty is limited to the repair or replacement of the AEM part. In no event shall this warranty exceed the original purchase price of the AEM part nor shall AEM be responsible for special, incidental or consequential damages or cost incurred due to the failure of this product. Warranty claims to AEM must be transportation prepaid and accompanied with dated proof of purchase. This warranty applies only to the original purchaser of product and is nontransferable. Improper use or installation, use for racing, accident, abuse, unauthorized repairs or alterations voids this warranty. AEM disclaims any liability for consequential damages due to breach of any written or implied warranty on all products manufactured by AEM. Warranty returns will only be accepted by AEM when accompanied by a valid Return Merchandise Authorization (RMA) number. Credit for defective products will be issued pending inspection. Product must be received by AEM within 30 days of the date RMA is issued.

If you have a warranty issue, please call (800) 992-3000 and our customer service department will assist you. A proof of purchase is required for all AEM warranty claims.