



INTAKE SYSTEM

INSTALLATION INSTRUCTIONS

26-3005C

TOYOTA / BMW

2020-22 GR SUPRA, TURBO

2020-22 Z4, TURBO

L6-3.0L

NOT LEGAL FOR SALE OR USE ON ANY POLLUTION CONTROLLED MOTOR VEHICLE IN CALIFORNIA OR STATES ADOPTING CALIFORNIA EMISSION PROCEDURES.

See aemintakes.com for CARB status on each part for a specific vehicle

TOOLS NEEDED:

Ratchet
Extension
11/16" 12 point socket
10mm socket
11mm socket
T25 torx
T30 torx
3/16 allen key
4mm allen key
5mm allen key
flat blade screw driver

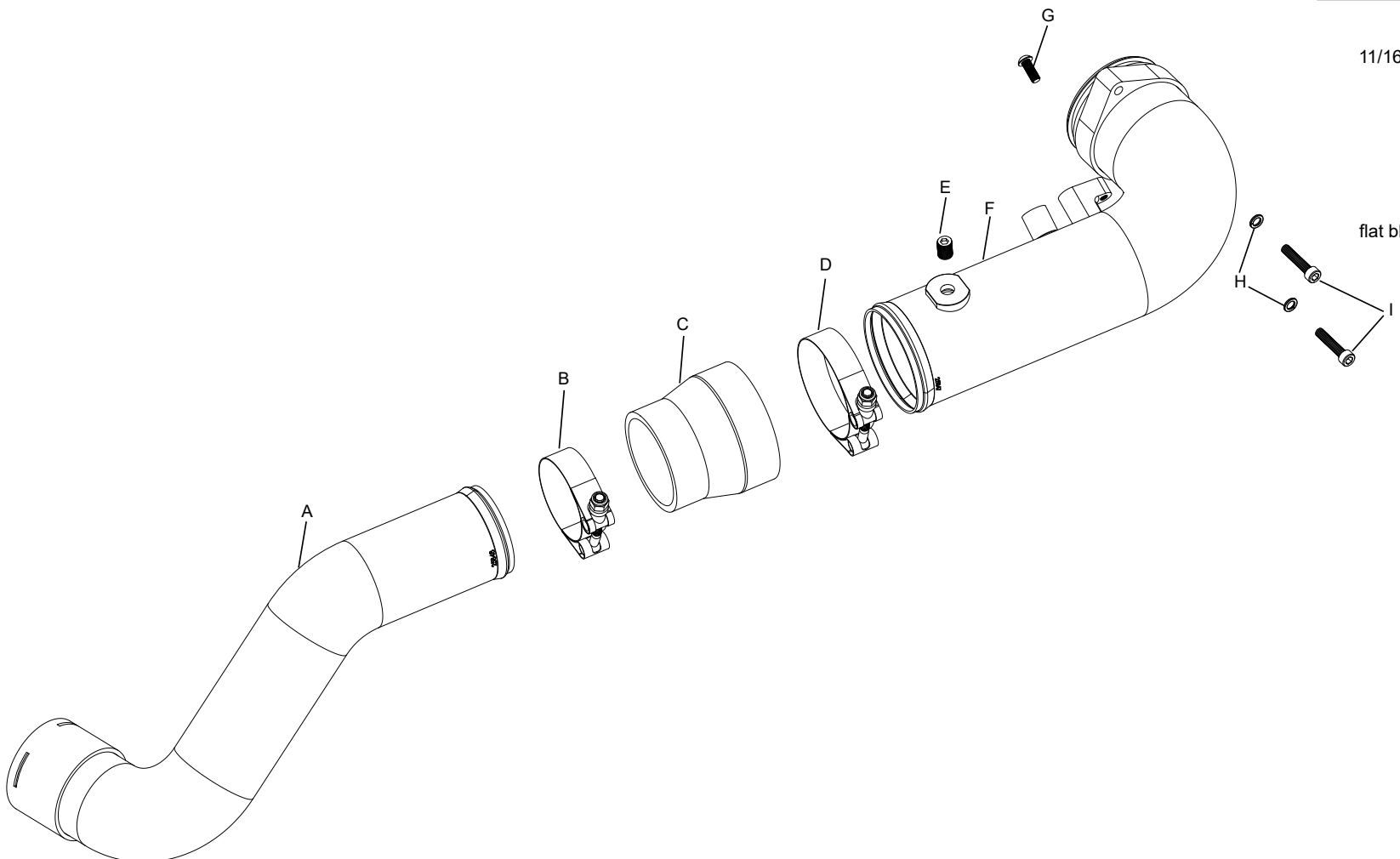

PARTS LIST:

Description	Qty.	Part #	Description	Qty.	Part #	Description	Qty.	Part #
A TUBE; 2.5"OD X 17"L, (AL)	1	25848C	D HOSE CLAMP; T-BOLT, #312	1	21852	G BOLT; M6 X 1 X 16MM, BTNHD	1	07730
B HOSE CLAMP; T-BOLT, #263	1	21851	E PLUG; STAINLESS STEEL 1/8" NPT	1	1-1014	H WASHER; M6 SPLIT LOCK ZINC	2	1-3025
C HOSE; 3" TO 2.5"ID X 3"L	1	08713	F TUBE; 3"OD X 15"L, (AL)	1	25847C	I BOLT; M6-1 X 30MM, SOCKET	2	1-2020

If you need any assistance please call 1-800-858-3333 to speak with a representative in our Customer Service Center before returning the product.

Read and understand these instructions BEFORE attempting to install this product. Failure to follow installation instructions and not using the provided hardware may damage the intake tube, throttle body and engine.

TO START:

1. Turn off the ignition and disconnect the negative battery cable.

NOTE: Disconnecting the negative battery cable erases pre-programmed electronic memories. Write down all memory settings before disconnecting the negative battery cable. Some radios will require an anti-theft code to be entered after the battery is reconnected. The anti-theft code is typically supplied with your owner's manual. In the event your vehicles anti-theft code cannot be recovered, contact an authorized dealership to obtain your vehicles anti-theft code.



2. Lift up and remove the engine cover from the engine.



3. Disconnect the inlet air temperature sensor electrical connection and then remove the complete air intake system from the vehicle. **NOTE: AEM-21-875DS intake system pictured.**



4. Disconnect the electrical connections from the two sensors installed into the factory charge pipe.



5. Disconnect the CCV vent from the turbo intake plenum, release the retaining clip that secures the plenum onto the turbo inlet and then remove the plenum from the vehicle.



6. Remove the two bolts that secure the factory charge pipe to the throttle body.



7. Remove the bracket that secures the coolant pump. This pump will not be removed, removing the bracket will aid in the charge pipe removal.



8. Release the locking clip that secures the charge pipe to the turbo outlet, separate the charge pipe from the turbo and remove it from the vehicle.



9. Remove the two sensors and O-ring from the factory charge pipe and install them onto the AEM charge pipe as shown.



10. Install the 1/8npt pipe plug into the water injection port. **NOTE: be sure to use pipe tape or other pipe sealant on the threads of the plug (not supplied).**



11. Remove the retaining clip and O-ring from the lower section of the factory charge pipe and install them onto the AEM charge pipe as shown.



12. Install the AEM lower charge pipe onto the turbo outlet, be sure that the locking clip engages to secure the pipe to the turbo.



13. Using the provided T-bolt, install the provided step coupler onto the lower charge pipe. **NOTE: It will be necessary to loosen the nut on the clamp completely to allow the clamp to slide onto the coupler, it is a tight fit to secure the coupler tightly against the tube bead. It is easier to install the coupler and clamp onto the tube on the bench before the tube is installed into the vehicle.**



14. Install the upper charge pipe into the coupler and then into the throttle body, secure the tube to the throttle body with the provided hardware and then secure the coupler with the T-bolt clamp. **NOTE: It will be necessary to loosen the nut on the clamp completely to allow the clamp to slide onto the coupler, it is a tight fit to secure the coupler tightly against the tube bead.**



15. Reconnect the two sensor electrical connections. **Note: Due to manufacturer tolerance, the wiring harness may need to be adjusted to allow for enough slack in the wiring harness.**



16. Reinstall the coolant pump clamp.



17. Reinstall the turbo inlet plenum being sure the retaining clip snaps into the groove to secure the plenum to the turbo. Reconnect the CCV vent to the plenum.



18. Reinstall the intake system into the vehicle and secure to the intake plenum, reconnect the inlet air temperature sensor electrical connection.



19. Reinstall the engine cover.

Reassemble Vehicle

Position the inlet pipes for the best fitment. Be sure that the pipes or any other components do not contact any part of the vehicle. Tighten the rubber mount, all bolts, and hose clamps. Check for proper hood clearance. Re-adjust pipes if necessary and re-tighten them. Inspect the engine bay for any loose tools and check that all fasteners that were moved or removed are properly tightened. Reconnect negative battery terminal and start engine. Let the vehicle idle for 3 minutes. Perform a final inspection before driving the vehicle.

Service and Maintenance

AEM Induction Systems requires cleaning the intake system's air filter element every 100,000 miles. When used in dusty or off-road environments, our filters will require cleaning more often. We recommend that you visually inspect your filter once every 25,000 miles to determine if the screen is still visible. When the screen is no longer visible some place on the filter element, it is time to clean it. To clean, purchase our Synthetic air filter cleaner, part number AEM-1-1000 and follow the easy instructions. Use window cleaner to clean your powder coated AEM® intake tube.

NOTE: DO NOT USE aluminum polish on powder coated AEM® intake tubes.

NOT LEGAL FOR SALE OR USE ON ANY POLLUTION CONTROLLED MOTOR VEHICLE IN CALIFORNIA OR STATES ADOPTING CALIFORNIA EMISSION PROCEDURES.

See aemintakes.com for CARB status on each part for a specific vehicle

AEM Air Intake System Warranty Policy

AEM® warrants that its intake systems will last for the life of your vehicle. AEM will not honor this warranty due to mechanical damage (i.e. improper installation or fitment), damage from misuse, accidents or flying debris. AEM will not warrant its powder coating if the finish has been cleaned with a hydrocarbon-based solvent. The powder coating should only be cleaned with a mild soap and water solution. Proof of purchase of both the vehicle and AEM intake system is required for redemption of a warranty claim.

This warranty is limited to the repair or replacement of the AEM part. In no event shall this warranty exceed the original purchase price of the AEM part nor shall AEM be responsible for special, incidental or consequential damages or cost incurred due to the failure of this product. Warranty claims to AEM must be transportation prepaid and accompanied with dated proof of purchase. This warranty applies only to the original purchaser of product and is nontransferable. Improper use or installation, use for racing, accident, abuse, unauthorized repairs or alterations voids this warranty. AEM disclaims any liability for consequential damages due to breach of any written or implied warranty on all products manufactured by AEM. Warranty returns will only be accepted by AEM when accompanied by a valid Return Merchandise Authorization (RMA) number. Credit for defective products will be issued pending inspection. Product must be received by AEM within 30 days of the date RMA is issued.

If you have a warranty issue, please call (800) 992-3000 and our customer service department will assist you. A proof of purchase is required for all AEM warranty claims.