



## INTAKE SYSTEM

### INSTALLATION INSTRUCTIONS

**26-3011C**  
**TOYOTA / BMW**  
**2021 GR SUPRA**  
**2.0L TURBO**  
**2021 Z4**  
**2.0L TURBO**

NOT LEGAL FOR SALE OR USE ON ANY POLLUTION CONTROLLED MOTOR VEHICLE IN CALIFORNIA OR STATES ADOPTING CALIFORNIA EMISSION PROCEDURES.

See [aemintakes.com](http://aemintakes.com) for CARB status on each part for a specific vehicle

#### TOOLS NEEDED:

Ratchet  
 Extension  
 T25 TORX  
 T30 TORX  
 4mm allen  
 Flat Blade screw driver  
 Pliers

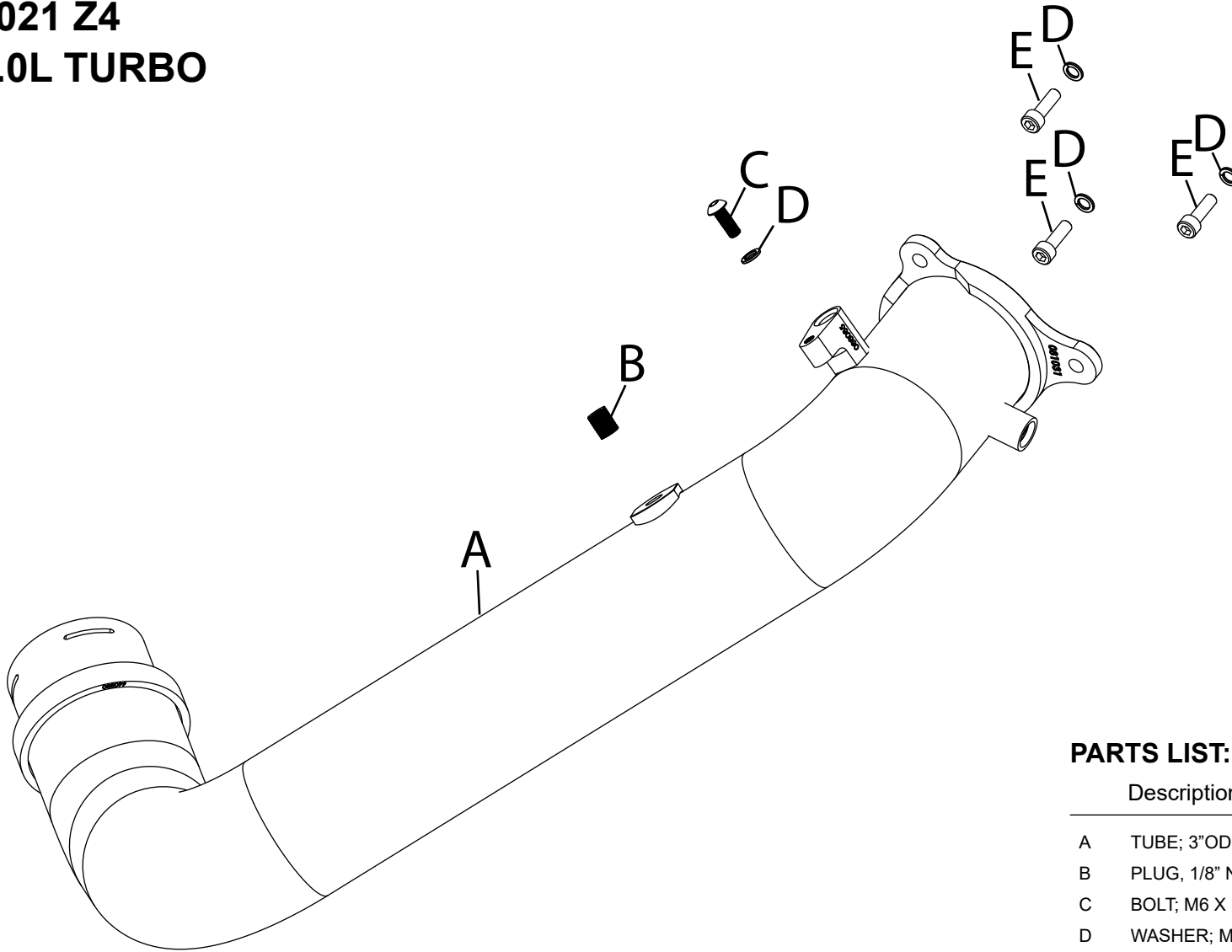

#### PARTS LIST:

	Description	Qty.	Part #
A	TUBE; 3"OD X 29"L, GUNMETAL	1	25860C
B	PLUG, 1/8" NPT	1	1-1014
C	BOLT; M6 X 1 X 16MM	1	07730
D	WASHER; M6 SPLIT LOCK	4	1-3025
E	BOLT; M6-1.00 X 20MM	3	07860

If you need any assistance please call 1-800-858-3333 to speak with a representative in our Customer Service Center before returning the product.

Read and understand these instructions **BEFORE** attempting to install this product. Failure to follow installation instructions and not using the provided hardware may damage the intake tube, throttle body and engine.

#### TO START:

1. Turn off the ignition and disconnect the negative battery cable.  
**NOTE: Disconnecting the negative battery cable erases pre-programmed electronic memories. Write down all memory settings before disconnecting the negative battery cable. Some radios will require an anti-theft code to be entered after the battery is reconnected. The anti-theft code is typically supplied with your owner's manual. In the event your vehicles anti-theft code cannot be recovered, contact an authorized dealership to obtain your vehicles anti-theft code.**



2. Lift up the engine cover to release it from the mounting grommets and then remove it from the vehicle. **NOTE: THE INTAKE SYSTEM HAS BEEN REMOVED FOR PHOTO'S.**



3. Disconnect the inlet air temperature sensor and pressure sensor electrical connections.



4. Remove the three bolts that secure the factory charge tube to the throttle body.



5. Using a flat blade screwdriver, release the retaining clip from lower factory charge pipes lower connection.



6. Separate the charge pipe from the turbo charger and then remove it from the vehicle.



7. Remove the retaining clip from the stock charge pipe and set aside to be used with the AEM charge pipe in a later step.



8. Remove the factory O-ring from the factory charge pipe.



9. Remove the screw that secures the pressure sensor into the factory charge pipe and then remove the sensor from the pipe.



10. Remove the inlet temperature sensor from the factory charge pipe.



11. Install the 1/8npt pipe plug into the accessory port of the AEM charge pipe. Be sure to apply thread sealer to the plug before installation. Install the AEM decal as shown.



12. Install the pressure sensor into the AEM charge tube and secure with the provided hardware.



13. Install the inlet air temperature sensor into the AEM charge pipe.



14. Install the factory O-ring and retaining clip into the AEM charge pipe as shown.



15. Install the AEM charge pipe onto the turbo inlet and throttle body. Push the tube onto the turbo until the retaining ring locks it into position while also aligning the top of the pipe with the throttle body.



16. Secure the pipe to the throttle body with the hardware provided.



17. Reconnect the inlet temperature sensor and pressure sensor electrical connections.



18. Reinstall the engine cover.



### Reassemble Vehicle

Position the inlet pipes for the best fitment. Be sure that the pipes or any other components do not contact any part of the vehicle. Tighten the rubber mount, all bolts, and hose clamps. Check for proper hood clearance. Re-adjust pipes if necessary and re-tighten them. Inspect the engine bay for any loose tools and check that all fasteners that were moved or removed are properly tightened. Reconnect negative battery terminal and start engine. Let the vehicle idle for 3 minutes. Perform a final inspection before driving the vehicle.

### Service and Maintenance

AEM Induction Systems requires cleaning the intake system's air filter element every 100,000 miles. When used in dusty or off-road environments, our filters will require cleaning more often. We recommend that you visually inspect your filter once every 25,000 miles to determine if the screen is still visible. When the screen is no longer visible some place on the filter element, it is time to clean it. To clean, purchase our Synthetic air filter cleaner, part number AEM-1-1000 and follow the easy instructions. Use window cleaner to clean your powder coated AEM® intake tube.

**NOTE: DO NOT USE aluminum polish on powder coated AEM® intake tubes.**

NOT LEGAL FOR SALE OR USE ON ANY POLLUTION CONTROLLED MOTOR VEHICLE IN CALIFORNIA OR STATES ADOPTING CALIFORNIA EMISSION PROCEDURES.

See [aemintakes.com](http://aemintakes.com) for CARB status on each part for a specific vehicle

### AEM Air Intake System Warranty Policy

AEM® warrants that its intake systems will last for the life of your vehicle. AEM will not honor this warranty due to mechanical damage (i.e. improper installation or fitment), damage from misuse, accidents or flying debris. AEM will not warrant its powder coating if the finish has been cleaned with a hydrocarbon-based solvent. The powder coating should only be cleaned with a mild soap and water solution. Proof of purchase of both the vehicle and AEM intake system is required for redemption of a warranty claim.

This warranty is limited to the repair or replacement of the AEM part. In no event shall this warranty exceed the original purchase price of the AEM part nor shall AEM be responsible for special, incidental or consequential damages or cost incurred due to the failure of this product. Warranty claims to AEM must be transportation prepaid and accompanied with dated proof of purchase. This warranty applies only to the original purchaser of product and is nontransferable. Improper use or installation, use for racing, accident, abuse, unauthorized repairs or alterations voids this warranty. AEM disclaims any liability for consequential damages due to breach of any written or implied warranty on all products manufactured by AEM. Warranty returns will only be accepted by AEM when accompanied by a valid Return Merchandise Authorization (RMA) number. Credit for defective products will be issued pending inspection. Product must be received by AEM within 30 days of the date RMA is issued.

If you have a warranty issue, please call (800) 992-3000 and our customer service department will assist you. A proof of purchase is required for all AEM warranty claims.