

Instruction Manual P/N:EVO9007

Injen intake systems are street legal in most states unless the state is adopting to California Emissions standards. States that have adopted California emission standards include: Arizona, California, Connecticut, District of Columbia, Maine, Maryland, Massachusetts, New Jersey, New Mexico, New York, Oregon, Pennsylvania, Rhode Island, Vermont, and Washington. These states will require an California Air Resource Board Executive Order Number (CARB E.O.) for the legal use of an Injen intake system in your vehicle for use on public roads or highways. These vehicle will be considered "Legal in California only for racing vehicles competition use only, which may never be used upon a public street or highway. **Please keep your factory air box assembly for any future use.**

NOTE: Verify your filter before any cleaning maintenance!

Blue media filter: Dry Air Filter, no oil required.

(SuperNano Web Dry filters require no oil, these can be cleaned using a vacuum or light compressed air. Please do not clean using water or injen restore kit.)

Red media filter: Factory Oiled Air Filter.

(Oiled cotton gauze filters require oil, please use injen restore kit. This filter can use water or cleaning solution for maintenance.)

Please visit injen.com for filter cleaning instructions.



NOTE: DISCONNECT BATTERY BEFORE INSTALLATION!!!

Instruction Manual P/N:EVO9007



1. Stock intake system shown.



2. Disconnect the MAF sensor harness.



3. With pliers, pull back the harness clip away from the air box.

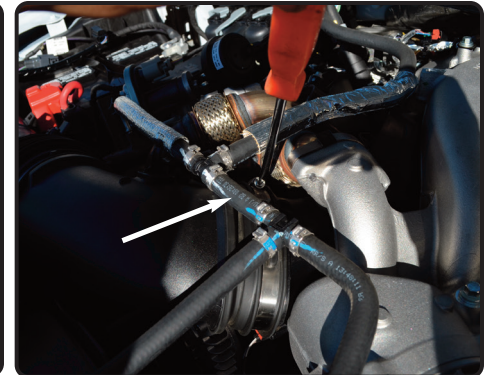

4. Loosen the clamp on the turbo using 7mm nut driver.

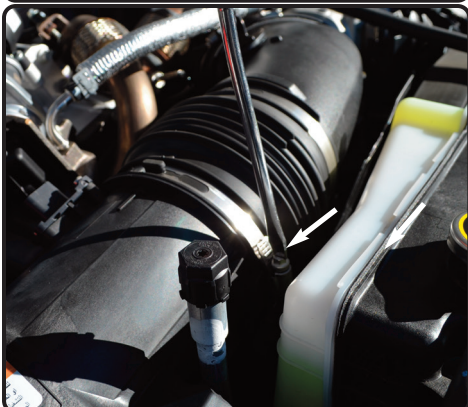

5. Loosen the clamp on the airbox using 7mm nut driver.



6. Carefully lift up the push clip from OEM factory ram.



7. Now unclip the upper half of the air box assembly lift up and remove.



8. Lift up and remove the factory ram from the vehicle.

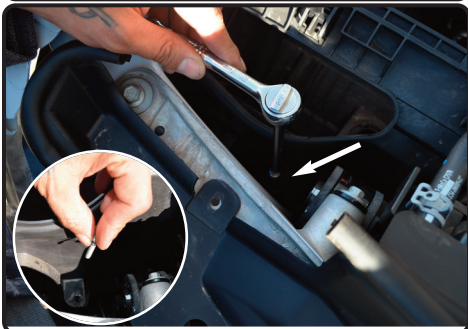

9. Locate the screw holding in the airbox, loosen and remove using 8mm nut driver.



10. Now carefully lift up and remove the bottom half of the air box out of the vehicle.

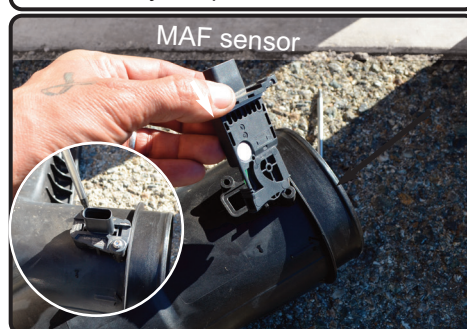

11. Loosen the 2 screws holding in the MAF sensor using T20 torx bit and remove.



12. Carefully pull out the filter monitor and remove the OEM grommet and will be used on the new intake system.



13. Install the MAF sensor into the new intake tube and secure using provided M4 button head screws.



14. Install the OEM grommet from step 12 into the hole on the intake tube.



15. Install the filter monitor into the grommet and secure. Make sure to reset.



16. Remove the Rubber O rings from the OEM air box.



17. Re-install into the new intake system plastic fittings.



18. Optional urethane plugs can be installed to the side of the air box.



19. Install the rubber inlet duct to the front of the air box. Locate the 2 rubber studs to the holes on air box. .



20. Push down and make sure the grommets are seated.



21. Install the air filter into the air box.



22. Once installed and seated, turn in either direction 1/4" turn until filter locks and seats into position.



23. Install into the new injen battery tray.



24. Re-install the push clip from step 6.

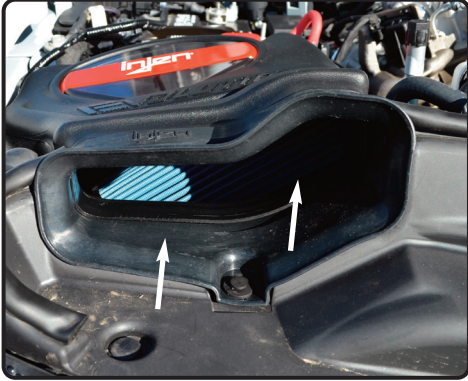

25. Make sure its seated and secured.



26. If A/C line comes close to new injen tube, push forward lightly towards front of the vehicle allowing for clearance.



27. Install the provided hump hose with clamps to the turbo flange Tighten the clamp on the flange only.



28. Install the intake tube into the vehicle, and position tube to filter and hump hose.

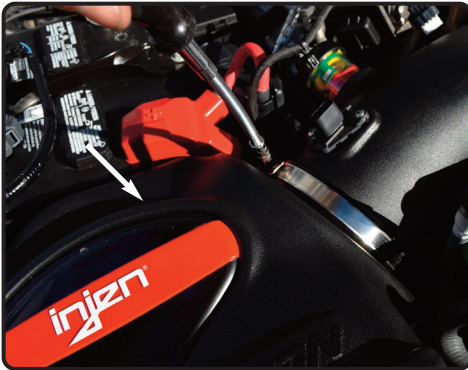

29. With provided hump hose and clamps. Attach to the turbo. Install the intake tube.

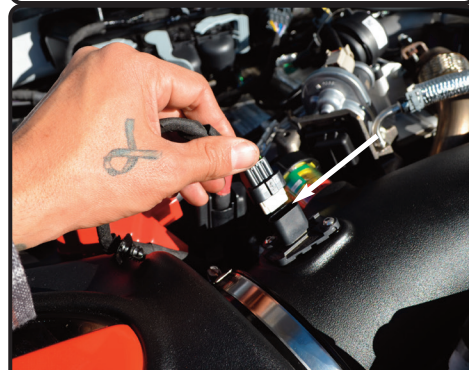

30. Position intake tube and secure the clamps using 8mm nut driver.



Congratulations! You have just completed the installation of this intake system. Periodically, check the alignment of the intake, normal wear and tear can cause nuts and bolts to come loose. **Note: Check clearance and adjust if needed! Failure to check the alignment and adjust the intake can cause damage that will void the warranty. Injen Technology is not responsible for any damages caused by/from improper installation.**

Test Drive:

1. With the transmission in neutral or park and the parking brake engaged, start the engine. Listen for air leaks or odd noises. If air leaks are detected, secure hoses and connections. For any odd noises, inspect entire system for cause and adjust intake as needed. The Injen intake will function identically to the factory system but will be louder and more powerful.
2. Perform a road test. Listen for odd noises or rattles and fix as necessary.
3. If there are no issues, continue to enjoy your added performance from the Injen performance Intake kit.
4. Injen Technology recommends you periodically check clearance and adjust if needed! Failure to check the alignment and adjust the intake can cause damage that will void the warranty. Injen Technology is not responsible for any damages caused by/from improper installation.

1. Upon completion of the installation, reconnect the negative battery terminal before you start the engine.
 2. Align the entire intake system for the best possible fit. Once the intake has been properly fitted continue to tighten all nuts, bolts and clamps.
 3. Periodically, recheck the alignment of the intake system and make sure there is proper clearance around and along the length of the intake. Failure to follow proper maintenance procedures may cause damage to the intake and will void the warranty.
 4. Start the engine and listen carefully for any odd noises, rattles and/or air leaks prior to taking it for a test drive. If any problems arise go back and check the vacuum lines, hoses and clamps that maybe causing leaks or rattles and correct the problem.
 5. Check the filter for excessive dirt build up. Clean or replace the filter with an original Injen filter (can be bought on-line at "injenonline.com").
- Congratulations! You have just completed the installation of the best intake system sold on the market. Enjoy the added power and performance of your new intake system.