

IMF43



2013+ MITSUBISHI MIRAGE / SPACE STAR  
MUD FLAP INSTALLATION INSTRUCTIONS

For high resolution color images of these instructions, please visit <http://www.rallyarmor.com>  
Check wheel clearance after installation, especially vehicles outfitted with non-OEM wheels and suspensions.

**To protect your Rally Armor mud flap set, care must be taken during parking and reversing.  
Rally Armor is not responsible for damage or loss of installed flaps.**

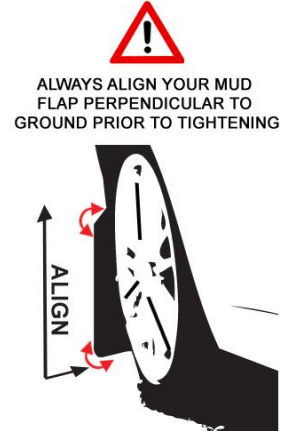

YOUR MOUNTING HARDWARE CONSISTS OF:			GUIDE TO HARDWARE PROVIDED:	
Quantity	Hardware Item	Item ID		
2	Lock Nuts	SSLNUT		
6	Short Screws	.75SS		
8	Long Screws	1SS		
16	Washers	SmWash		
8	Polygon Clips	PolyClp		
6	Flat U clips	UCLP		
2	Front Mounting Brackets	HMF14/16-DF & PF		
2	Rear Mounting Brackets	HMF43-BR-RE		

  

Locknut SSLNUT		Front Bracket	
"Long" Screw 1SS		HMF 14/16 -DF	HMF 14/16 -PF
"Short" Screw .75SS		Flat "U" Clip (UCLP)	Polygon Clip (POLYCLP)
		Washer (SMWASH)	Rear Bracket (HMF43-BR-RE)

! IMPORTANT NOTES	
<p><b>Cautionary Tip:</b> The hardware is strong and self-threading but <u>over-tightening the clips is not advised.</u></p> <p><b>Installation Tip:</b> To ease installation and avoid damage to existing OEM clips during removal, a well-lit, climate controlled installation environment is recommended.</p> <p><b>Parking and Reversing:</b> Any extended mud flap application can be damaged or dislodged should they get caught in between a tire and a curb or object. To protect your Rally Armor mud flap set, care must be taken during parking and reversing. Rally Armor is not responsible for damage or loss of installed flaps.</p>	<p><b>Recommended tools:</b> Offset, ratcheting Phillips screwdriver, flat screwdriver, pick, 7/16<sup>th</sup> wrench.</p> <p><b>To the customer:</b> Retain these instructions after installation. They may be necessary for installing other optional parts or removal of this accessory.</p> <p><b>To the installer:</b> Please return these instructions to the customer after installation. Always test and adjust wheel clearance before returning vehicle.</p>

# Front Mud Flap Installation

- **(Figure A)** Park the vehicle on an even surface. Turn the steering wheel towards the side you are working on. Remove the two outer fender liner fasteners. Remove the inner and lower fender liner fasteners. Uninstall splash guards if present. Position the liner away to gain access to the inner wheel well area.
- **(Figure B)** Install a Polygon Clip (**PolyClip**) over each of the two mounting points at an angle as shown. Replace the liner.
- **(Figure C)** Install a Flat U clip (**UClip**) over each of the two front bracket mounting points on the as shown.

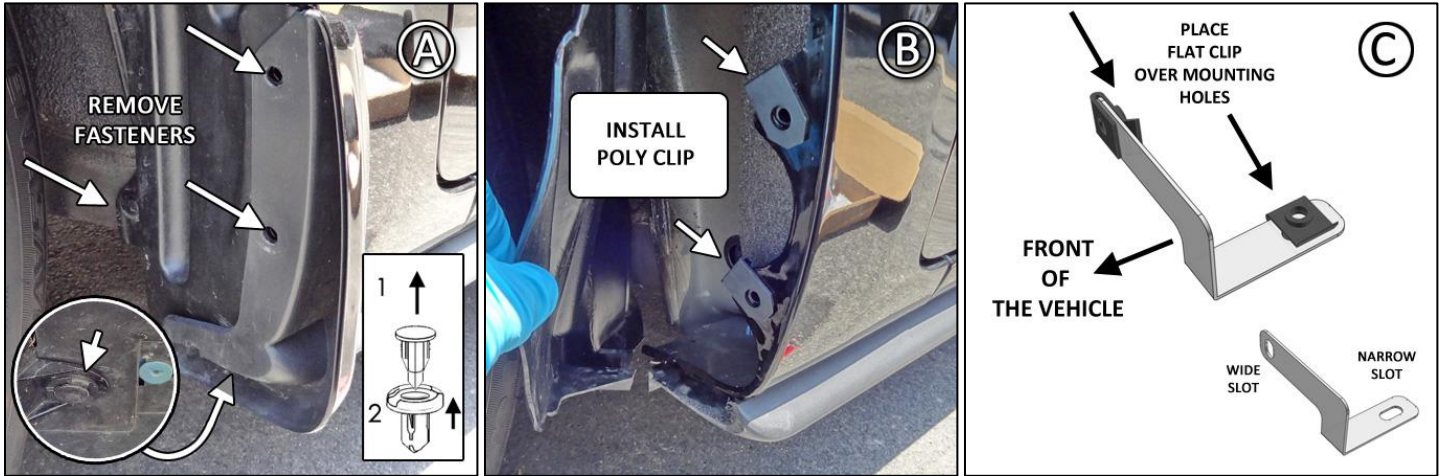

- **(Figure D)** Position the bracket between the side skirt and the liner, and re-install inner liner fastener. Hold bracket up against liner.
- **(Figure E)** Working from underneath the vehicle. Hand thread a short screw (.75SS) and a washer (SmWash), through the side skirt mounting point and into the lower Flat U clip mounted on the bracket on the other side. Position bracket against liner.
- **(Figure F)** Position the front mud flap with logo facing the rear of the vehicle against the corresponding mounting points on the wheel well. Hand thread a long screw (1SS) and a washer (SmWash), through the mud flap and into each of the 2 outer mounting points, install a short screw (.75SS) into the inner bracket mounting point. Align the outer edge of the flap by incrementally adjusting the assembly side to side, as well as the lower & upper portions of the flap, confirming the flap is perpendicular to even ground. Tighten all mounting screws (including lower bracket) until they are seated. **Do not over tighten.**





## Rear Mud Flap Installation

- **(Figure G)** Removal of the rear tire is *not required*, but can ease installation. Remove the two fender liner fasteners found on the edge of the bumper liner and inner wheel well. Remove splash guard (if present) and spring clips underneath. Position the liner away to gain access to the inner wheel well area.
- **(Figure H)** Place a Polygon Clip (**PolCl**) over each of the two outer bumper mounting points.
- **(Figure I)** Place a flat U clip (**UClp**) over the rear bumper bracket (**HMF43-BR-RE**) as shown.

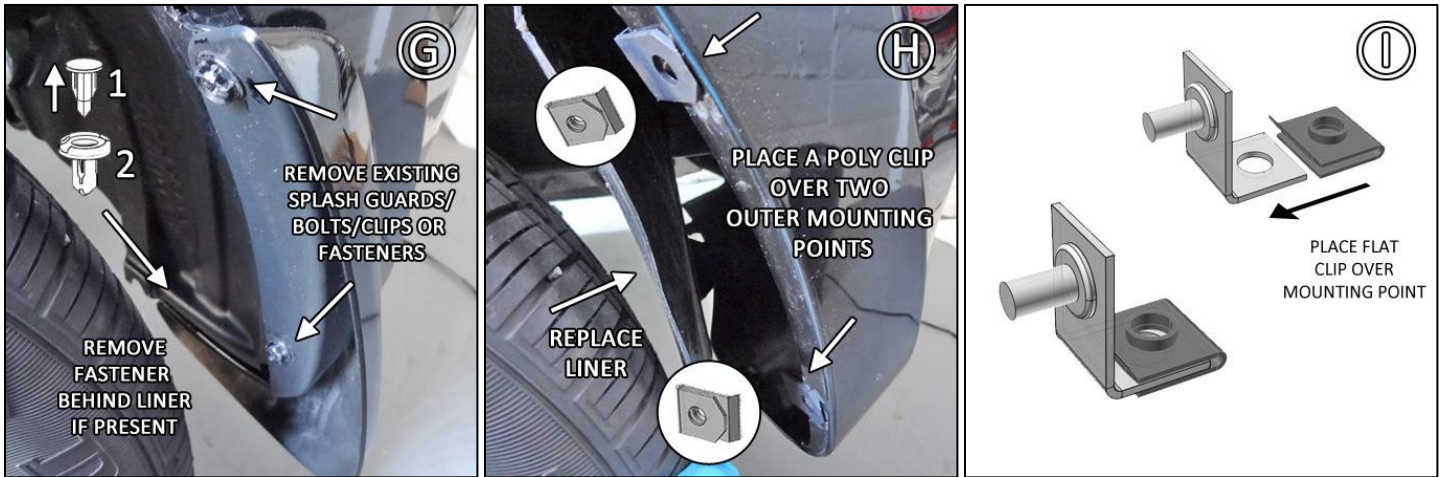

- **(Figure J)** Place the rear bracket assembly (**HMF43-BR-RE**) **ABOVE** the rear bumper skin (**DO NOT** mount the bracket below the bumper). Thread a short screw (**.75SS**) and washer (**SmWash**) through the bumper skin and into the flat clip mounted on the bracket. Do not fully tighten as to allow for left/right adjustment during mud flap mounting. Replace liner behind the bracket and over mounting clips.
- **(Figure K)** Place the rear mud flap with logo facing the rear of the vehicle against the corresponding mounting points on the wheel well. Install a long screw (**1SS**) and washer (**SmWash**) through the mud flap into the two outer mounting points. For the inner mounting point, install a Lock nut (**SSLNUT**) and washer (**SmWash**). Do not fully tighten, you will adjust the mud flap.
- **(Figure L)** Align outer edge of the flap by incrementally adjusting the assembly side to side, as well as the lower & upper portions of the flap. **Tighten all mounting screws only until washers are seated. Do not over tighten.**



IMF43



FRONT

HMF43 MOUNTING DIAGRAM

REAR

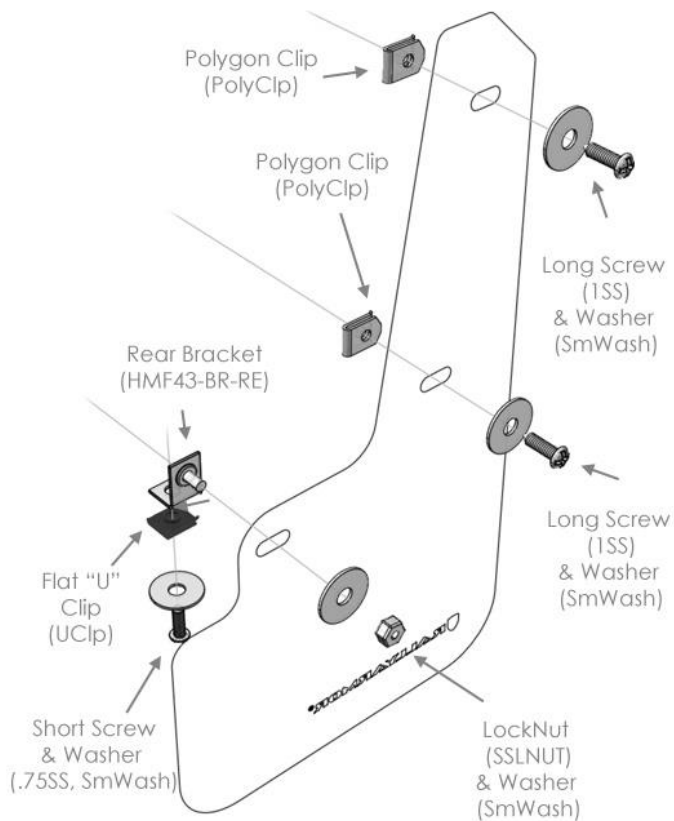
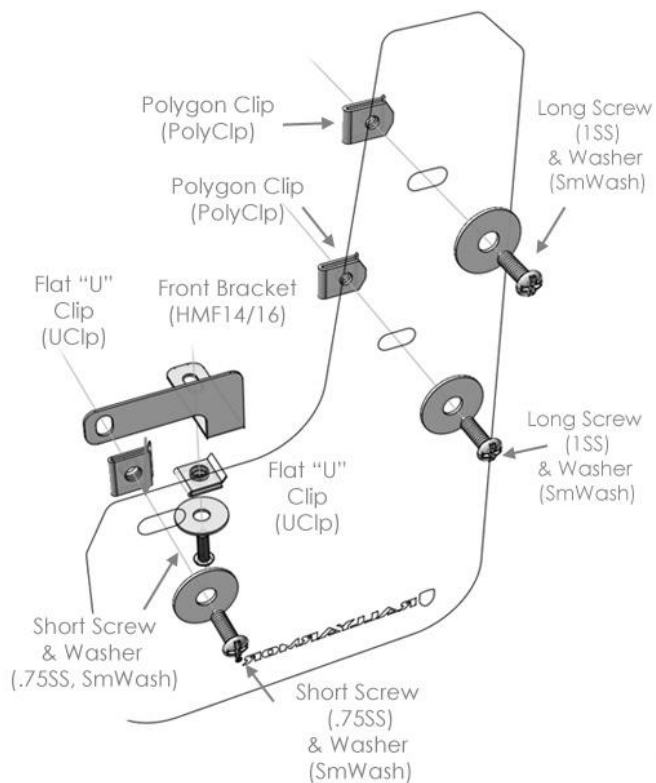

**Check wheel clearance after installation, especially on vehicles outfitted with non-OEM offset wheels and suspensions. Adjust to accommodate accordingly in these scenarios. Rally Armor is not responsible for damage or loss of installed flaps.**