

VCC13

THIRTEEN



HYDRAULIC HANDBRAKE INSTALLATION INSTRUCTIONS:

PART NUMBER:

HYHB-0101

HYHB-0102

HYHB-0103

HYHB-0104

We recommend that installation of all Voodoo13 parts be completed by a professional who is experienced in suspension tuning. With proper installation and maintenance, Voodoo13 suspension products will provide exceptional performance and durability. For any questions, please contact Voodoo13 immediately. We thank you for choosing Voodoo13 for your suspension tuning needs!

NEED HELP?

Our representatives are here to help you with any questions concerning the operation of this product.

CALL 480-889-0812

Monday thru Friday 8:30am to 5:30pm MST

PART BREAKDOWN

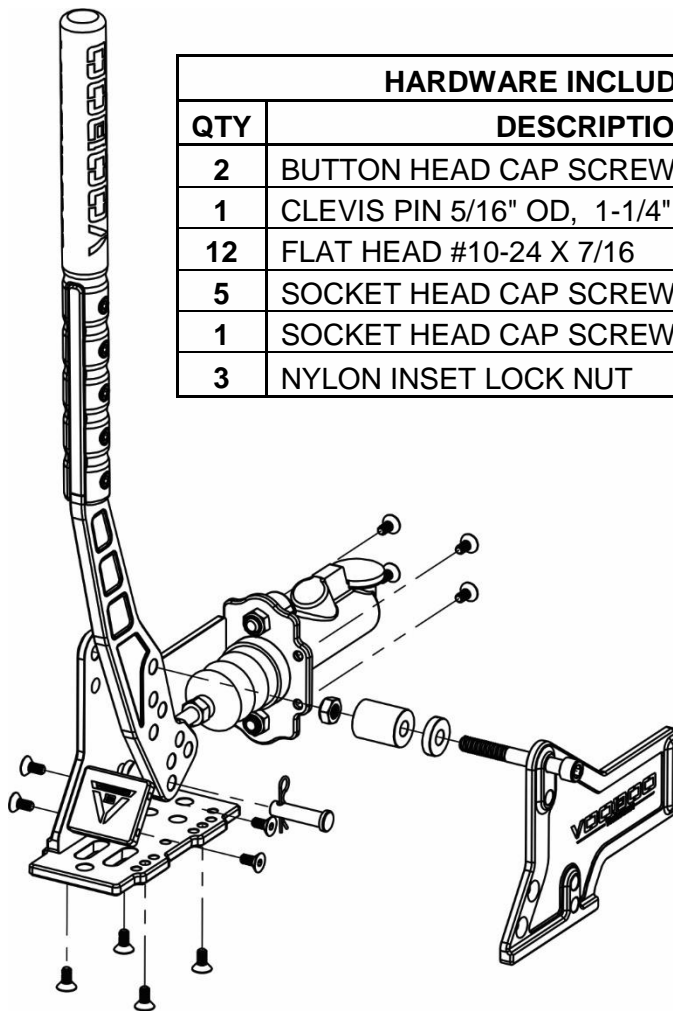

HARDWARE INCLUDED	
QTY	DESCRIPTION
2	BUTTON HEAD CAP SCREW, 5/16"-18 X 1-1/8
1	CLEVIS PIN 5/16" OD, 1-1/4"
12	FLAT HEAD #10-24 X 7/16
5	SOCKET HEAD CAP SCREW #10-24 X 5/8
1	SOCKET HEAD CAP SCREW 5/16"-18 X 2-1/2"
3	NYLON INSET LOCK NUT

INSTALLATION PROCEDURE

IMPORTANT! PLEASE READ BEFORE ATTEMPTING INSTALLATION!

The base plate and side plates are shipped assembled with the mounting hardware hand tight. It is extremely important that during installation you back all hardware out several turns so that during assembly it makes everything easier to line up. Once assembled into your preferred configuration, you may tighten the hardware completely.

Step 1: Refer to the diagrams and choose the preferred setup of your choice. Three ways our kit can be used: The handbrake can be configured for a pullback function either with the master cylinder facing forward or backwards. The handbrake can also be used in a pull up function. In all three configurations, leverage can be adjusted to effect the amount of throw required to lock up the rear wheels. Each configuration has two levels of adjustment.

Step 2: View the diagram below on how to route the brake lines correctly. You can either tap into the existing front lines for hydraulic fluid or run an external reservoir. Then route that line into the inlet of the master cylinder on the hydraulic handbrake. From there route a new line from the outlet of the hydraulic handbrake's master cylinder to the rear brake lines. Ensure to bleed the brakes after installation before driving on a public road.

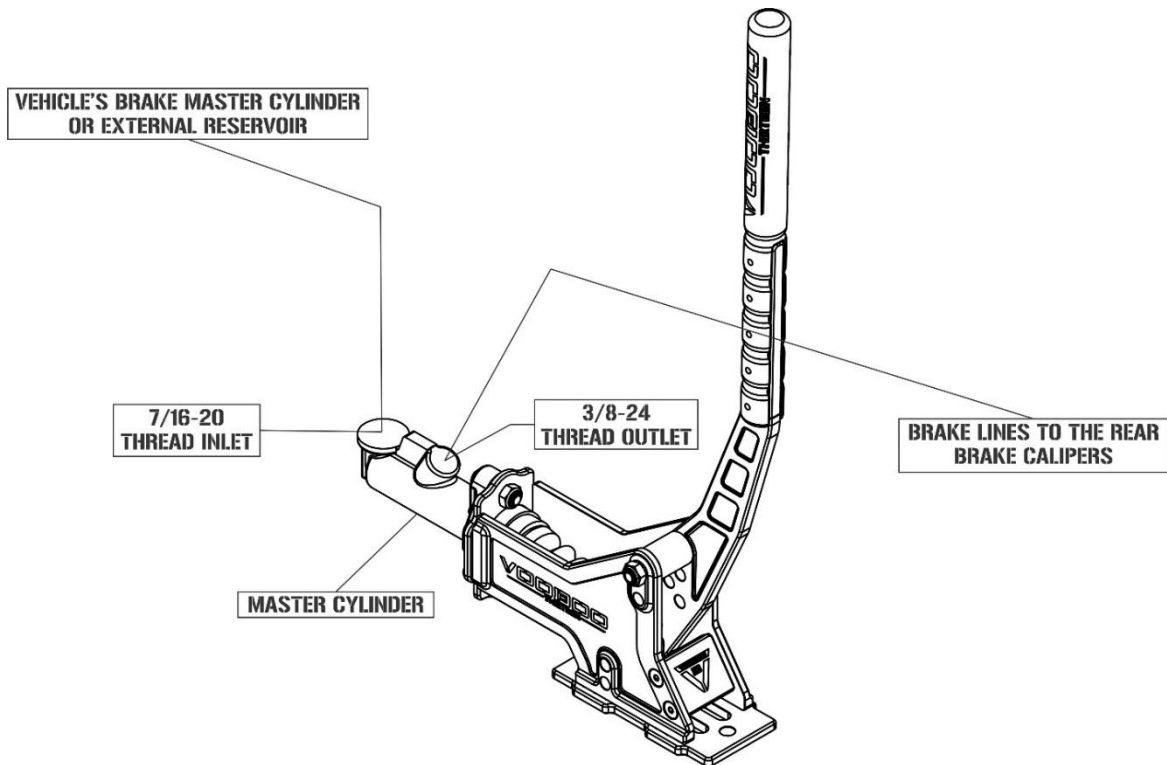

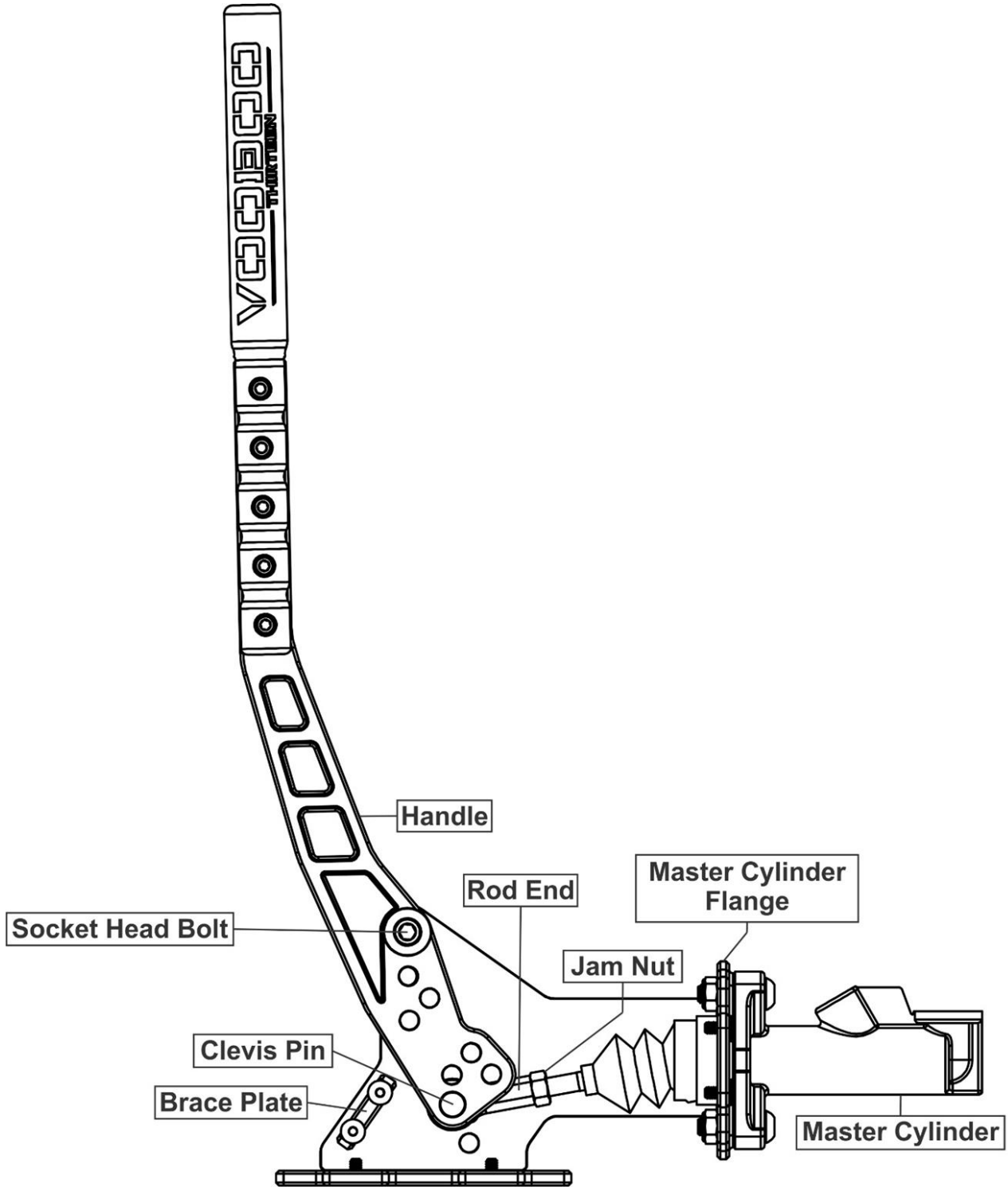

BASE FEATURES

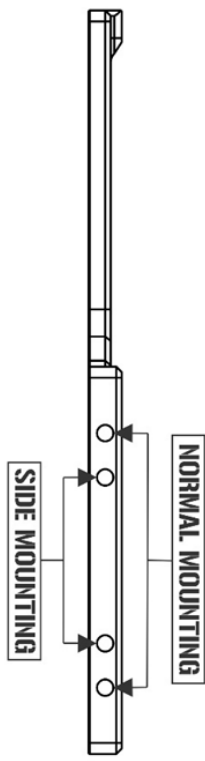

MOUNTING HOLES SIZE: 5/16"

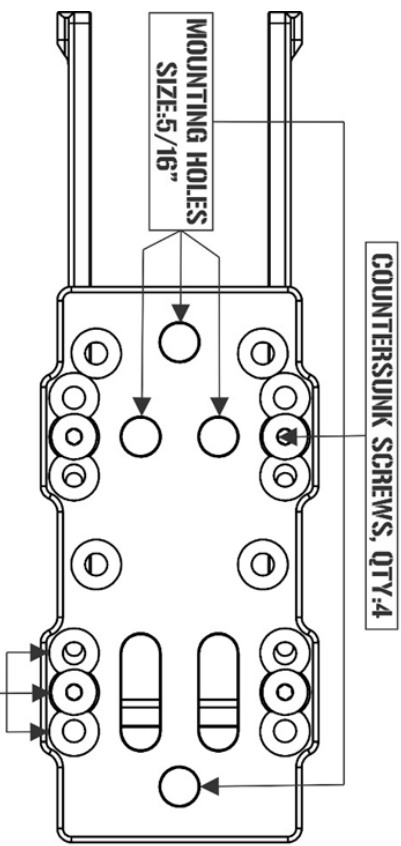

3 POSITION AVAILABLE TO ADJUST THE
HANDBRAKE EITHER FURTHER
FORWARD OR BACKWARD

NORMAL MOUNT

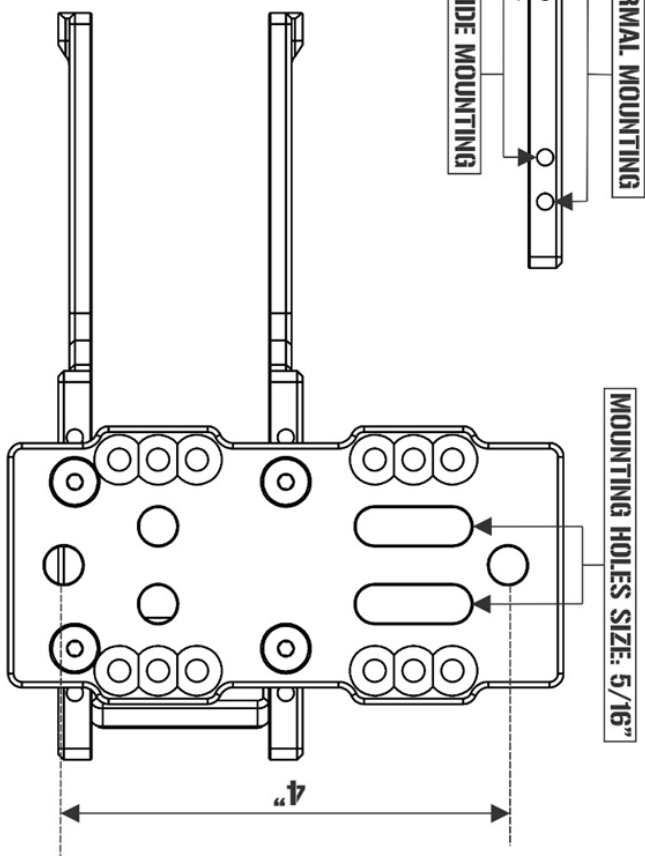

SIDE MOUNT

BASE FEATURES CONTINUED

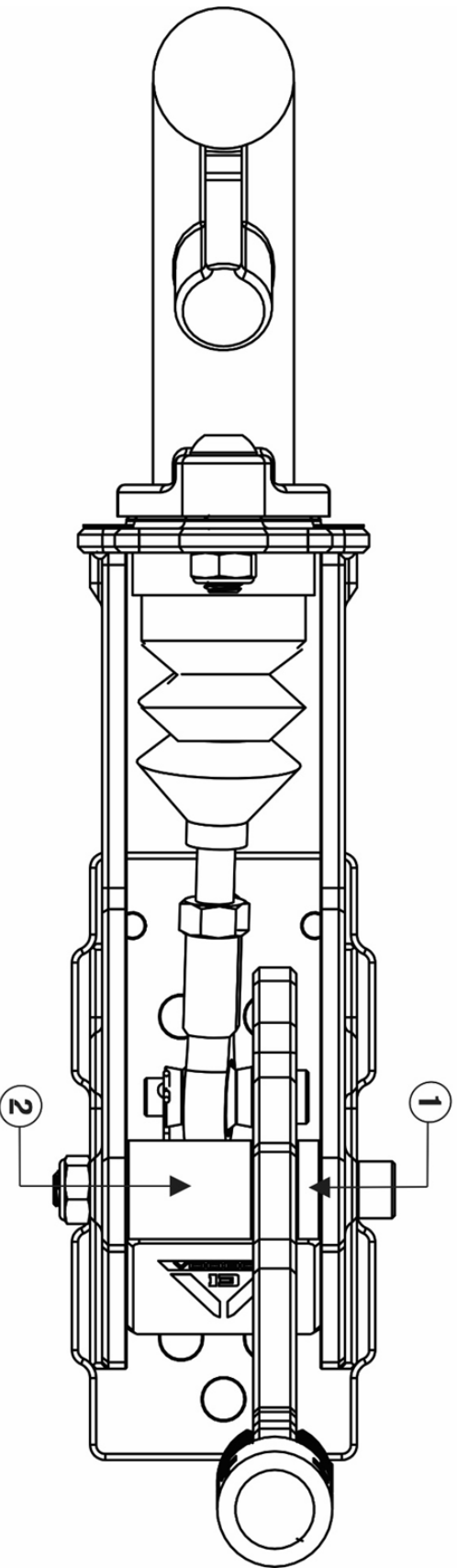

SPACERS 1 AND 2 ARE INTERCHANGEABLE TO OFFSET THE HANDLE EITHER TO THE LEFT OR RIGHT. WHEN CHANGING THE OFFSET, THE ROD END AND THE MISALIGNMENT SPACERS MUST BE MOVED TO THE SAME SIDE AS SPACER #2 AS SHOWN BELOW

ASSEMBLY: PART ONE

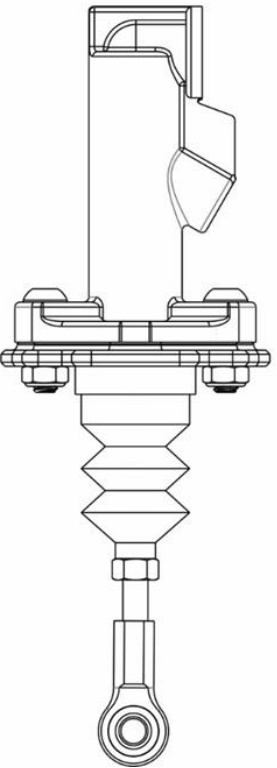
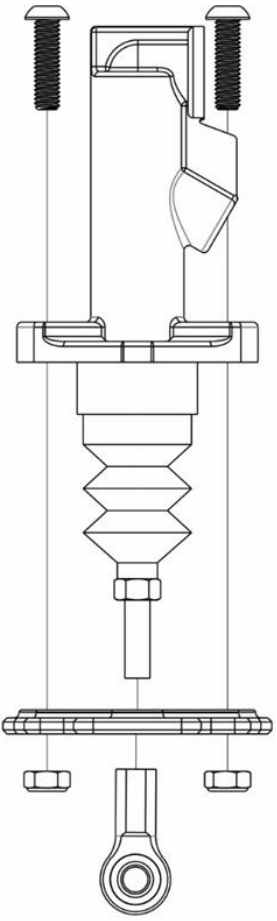
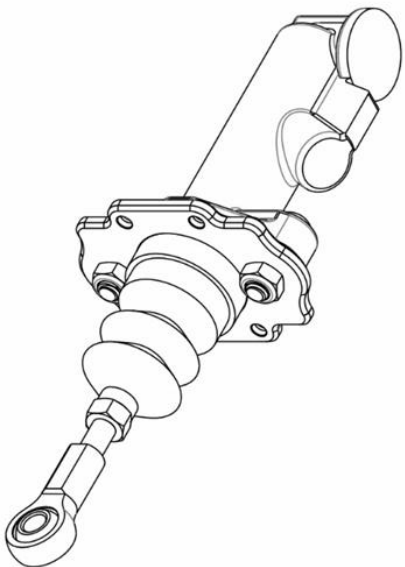
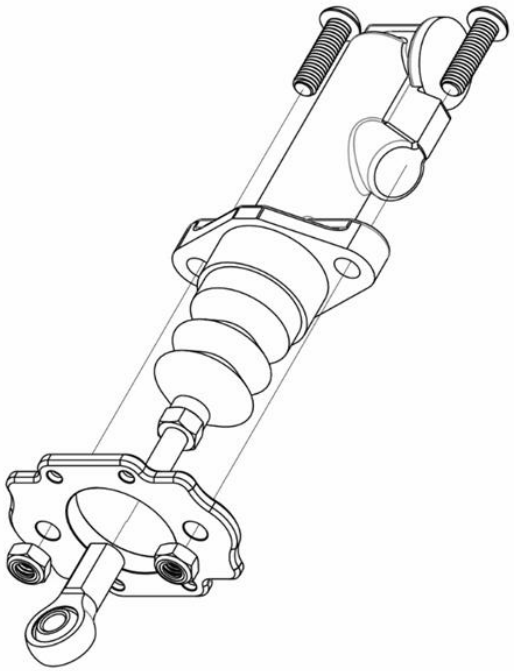

ASSEMBLY PART 2

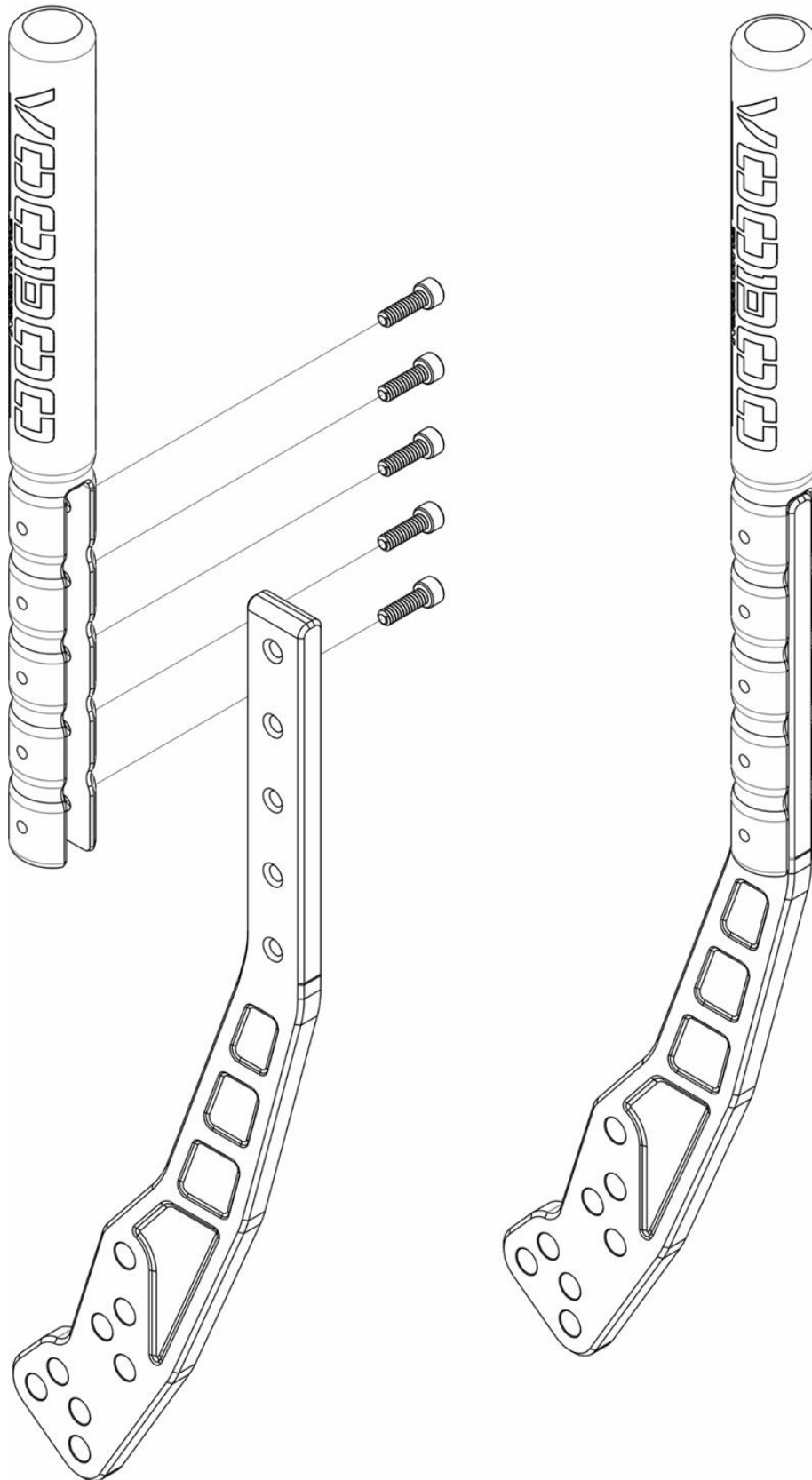

ASSEMBLY PART 3

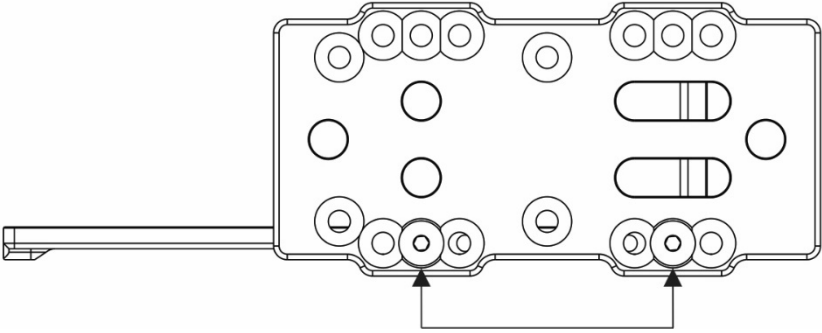
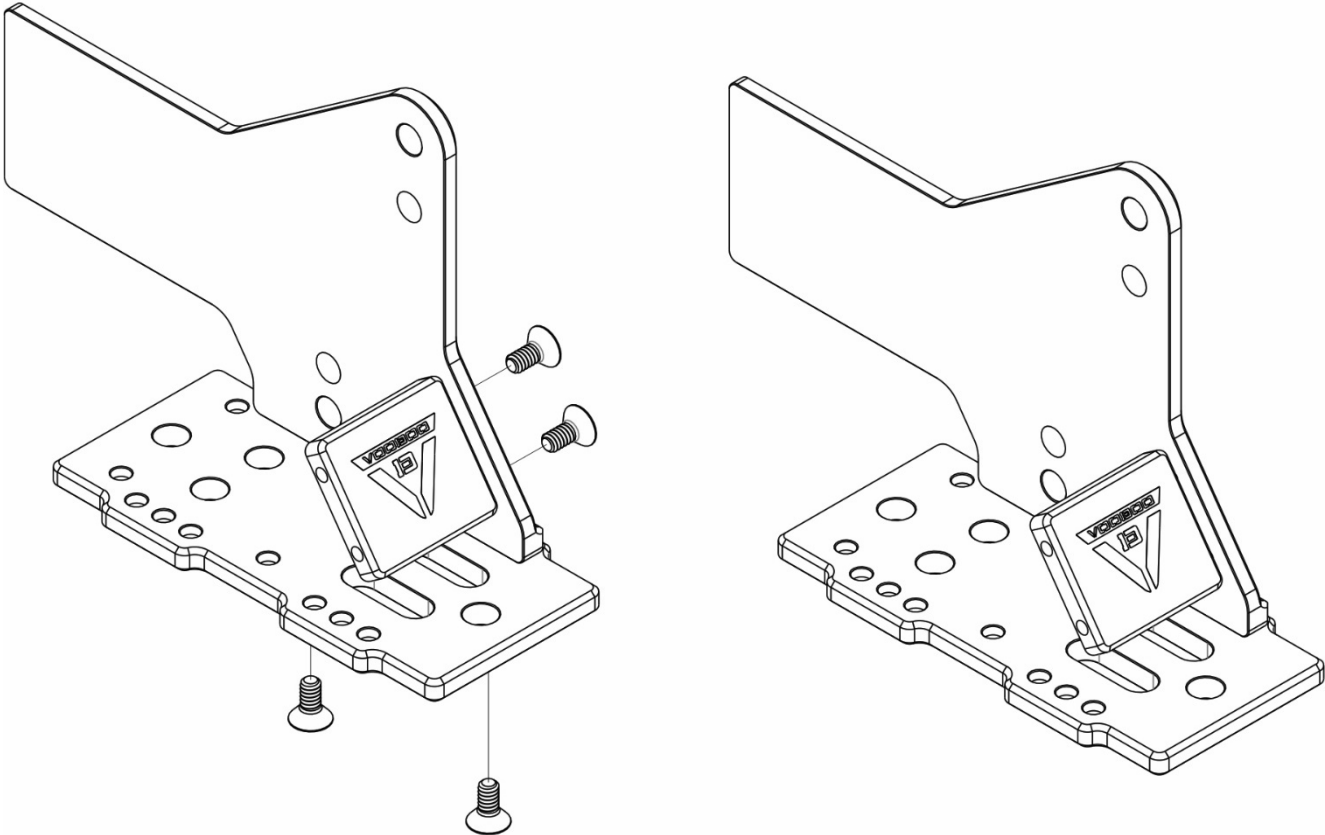

**REFER TO BASE FEATURE
DIAGRAMS FOR MORE
CONFIGURATIONS**

ASSEMBLY PART 4

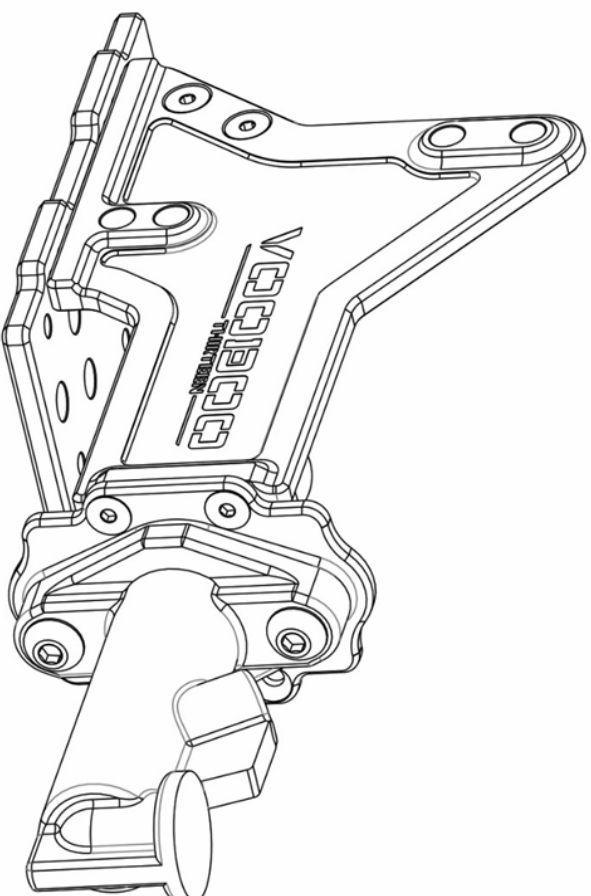
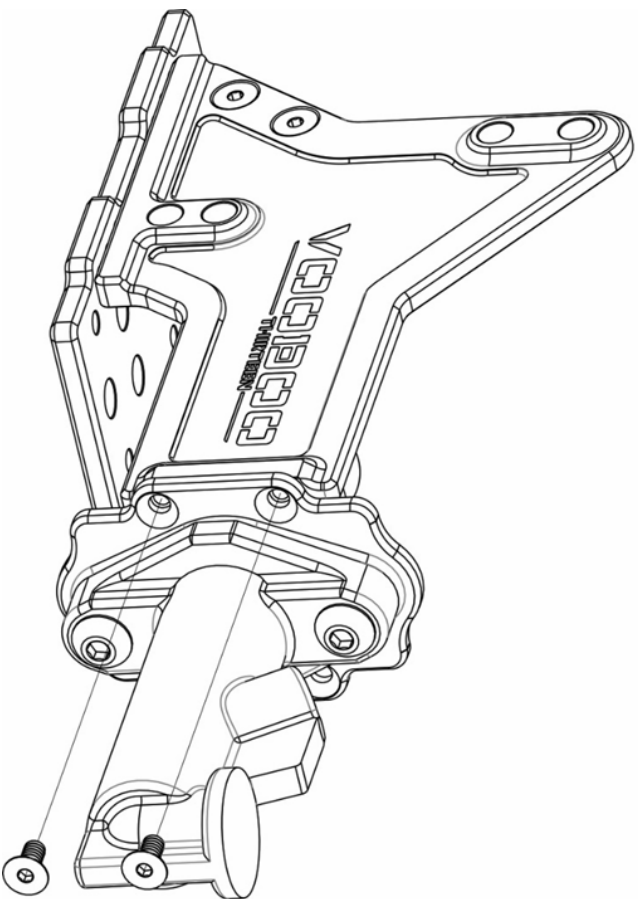

ASSEMBLY PART 5

HANDLE

REFER TO INVERTED,
NON-INVERTED, AND
PULL UP DIAGRAMS
FOR MOUNTING
LOCATIONS

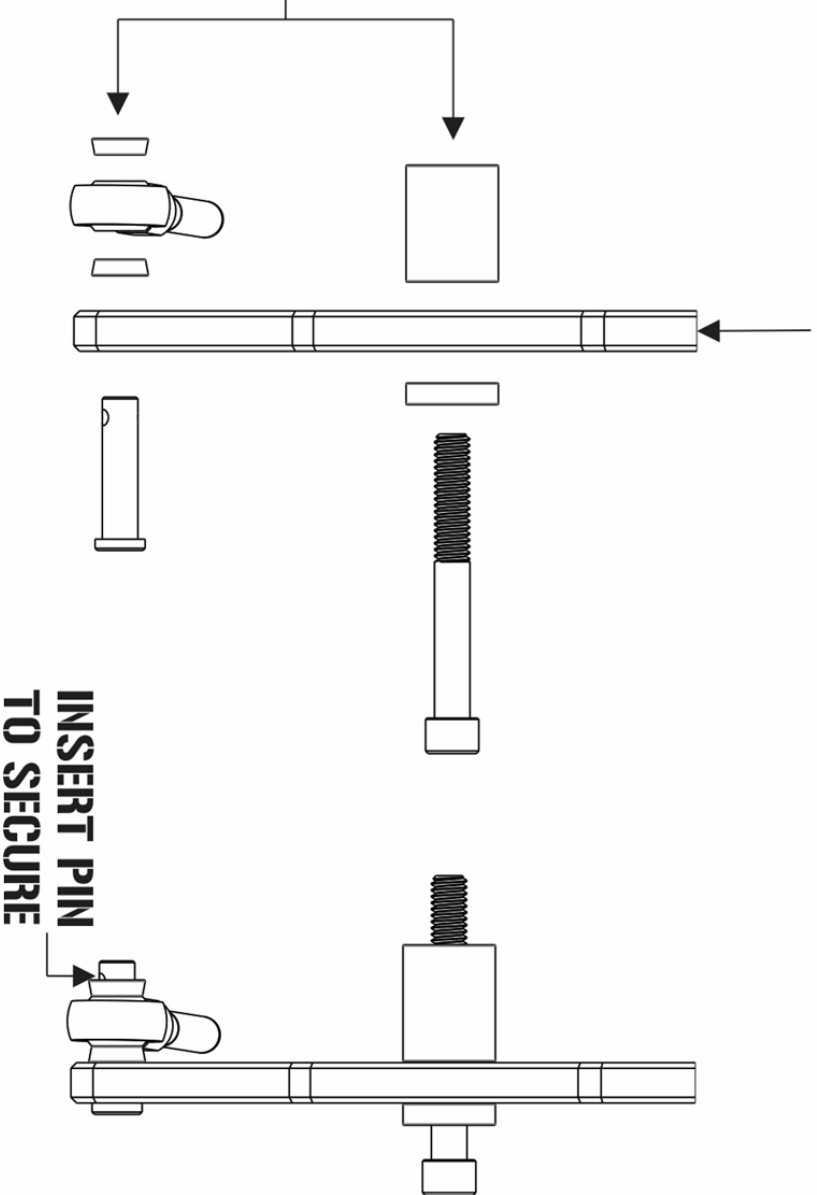

INVERTED ASSEMBLY

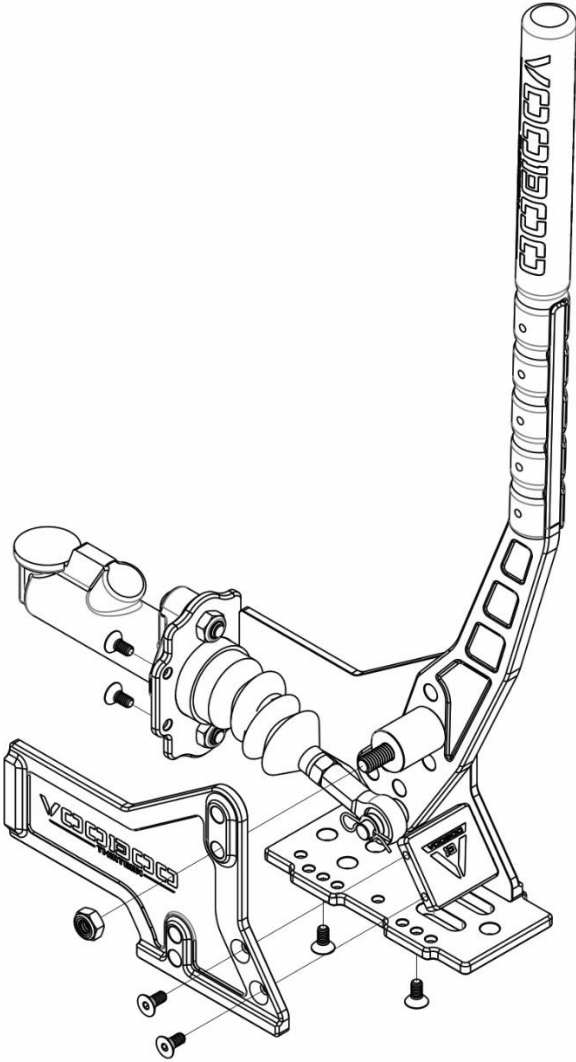

HIGH EFFORT

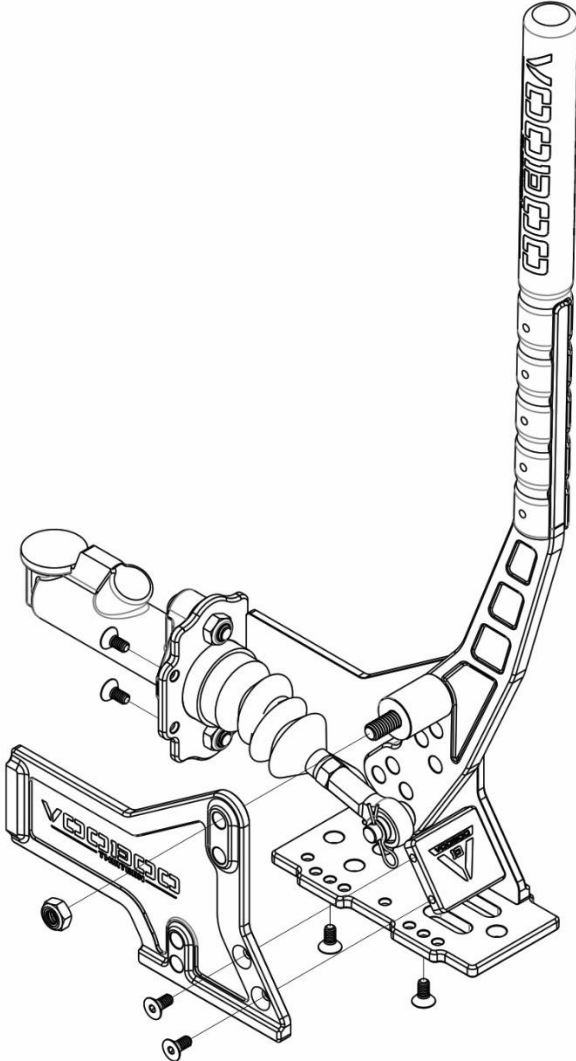

LOW EFFORT

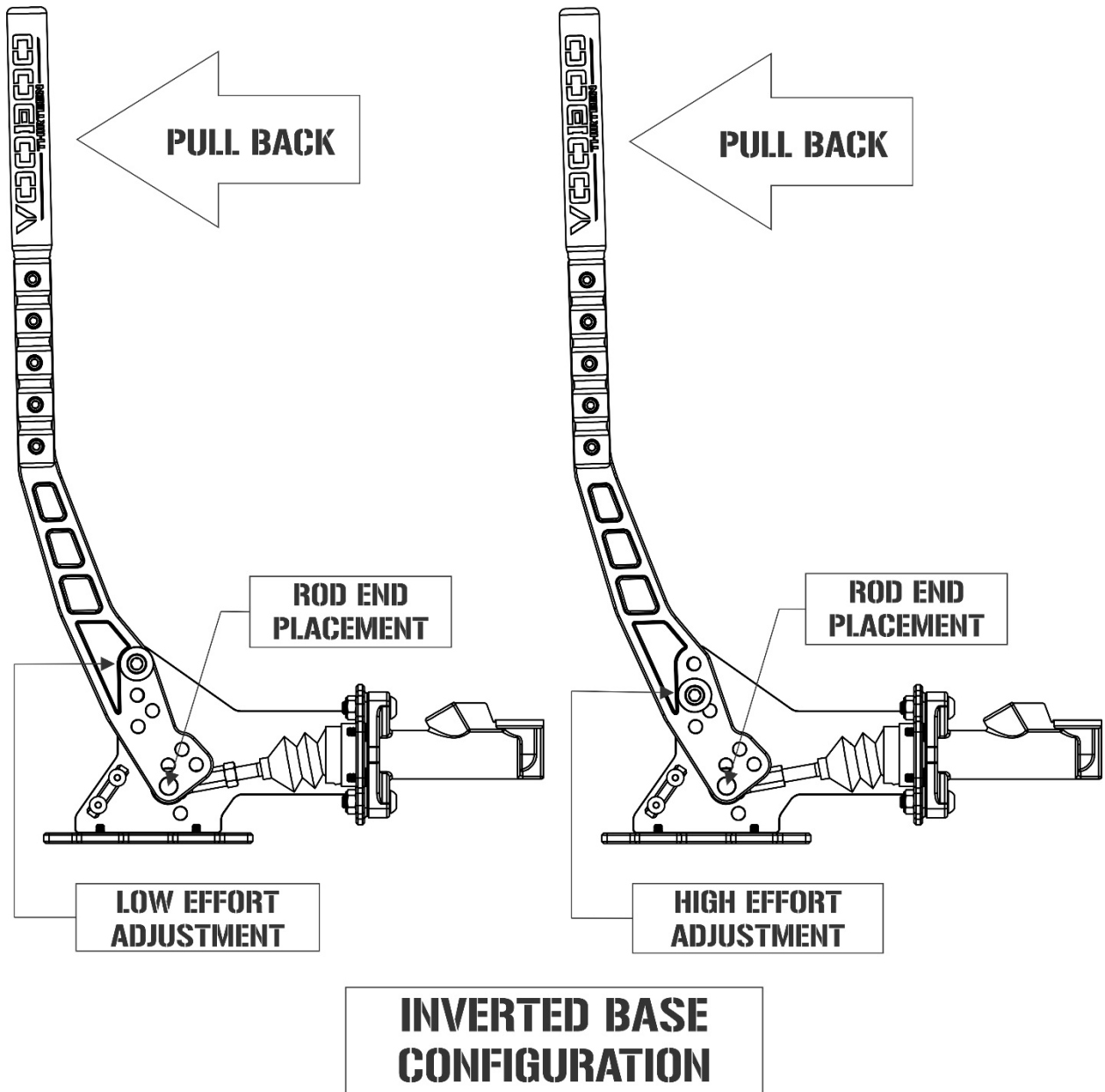

NON-INVERTED ASSEMBLY

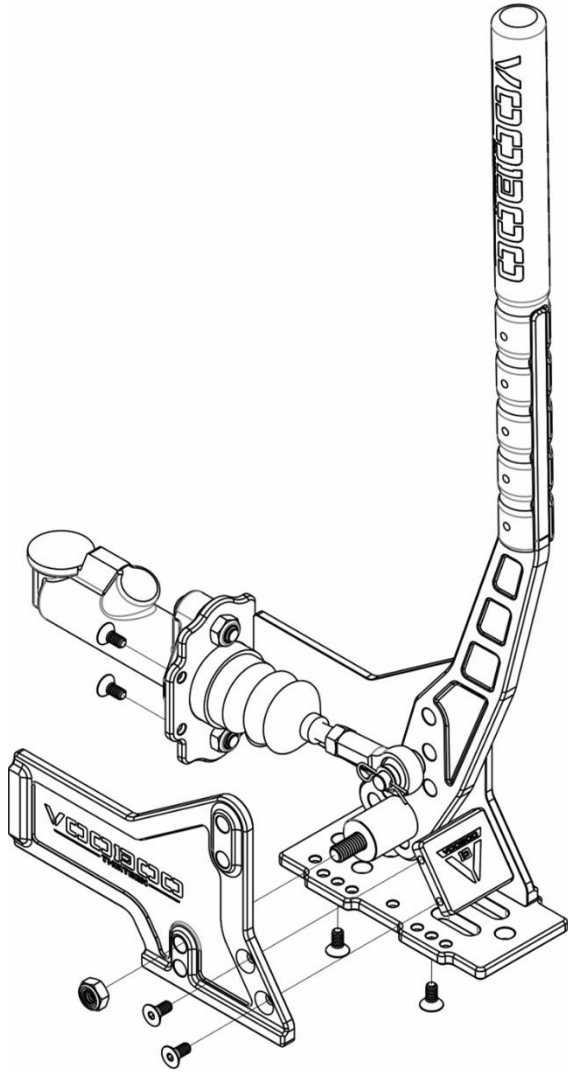

HIGH EFFORT

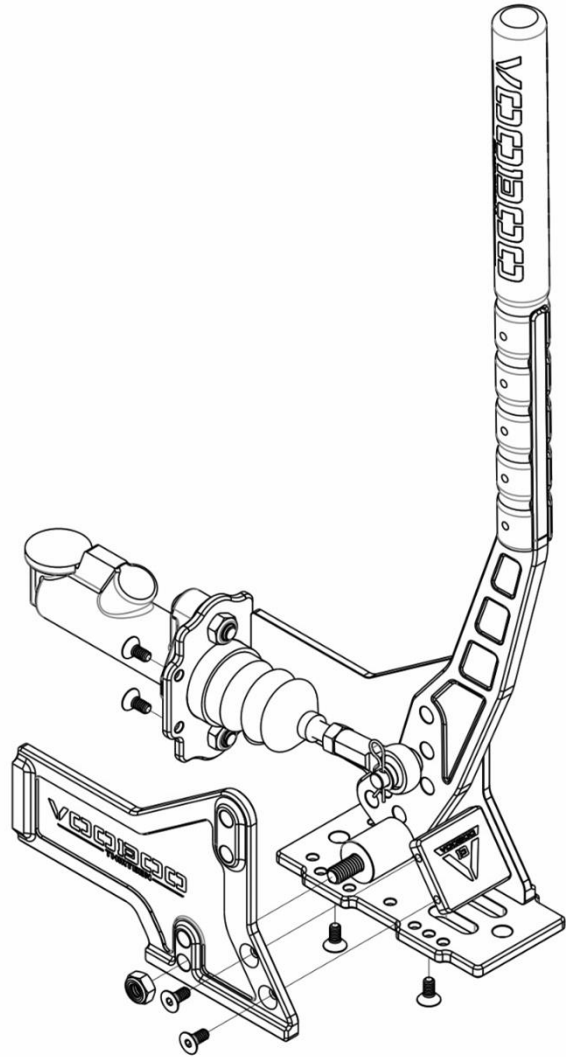

LOW EFFORT

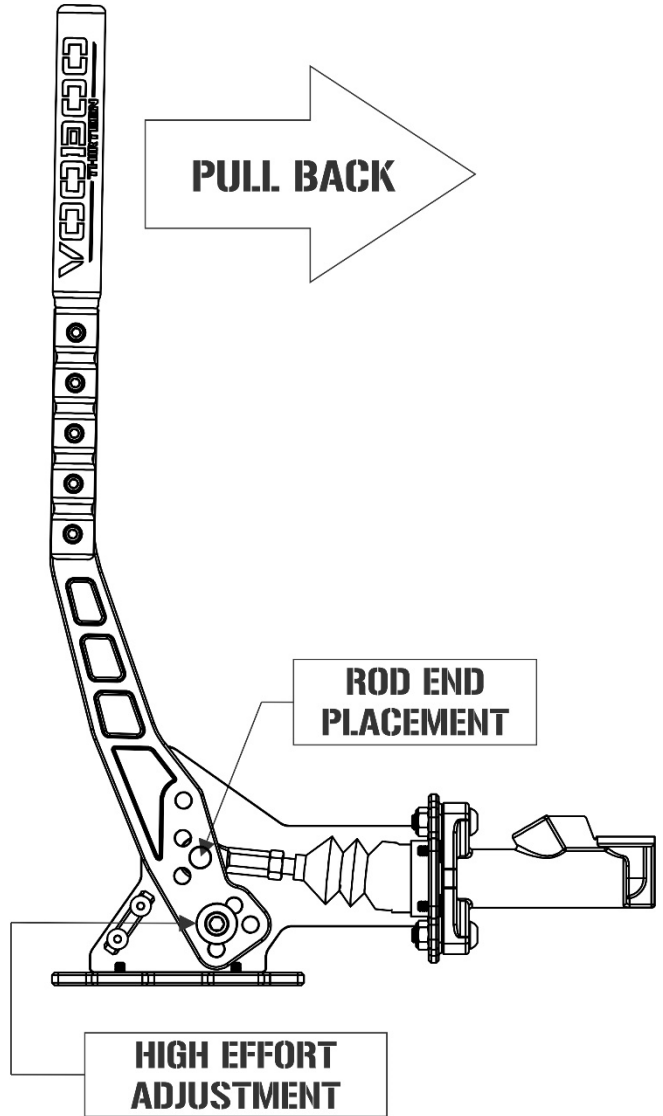
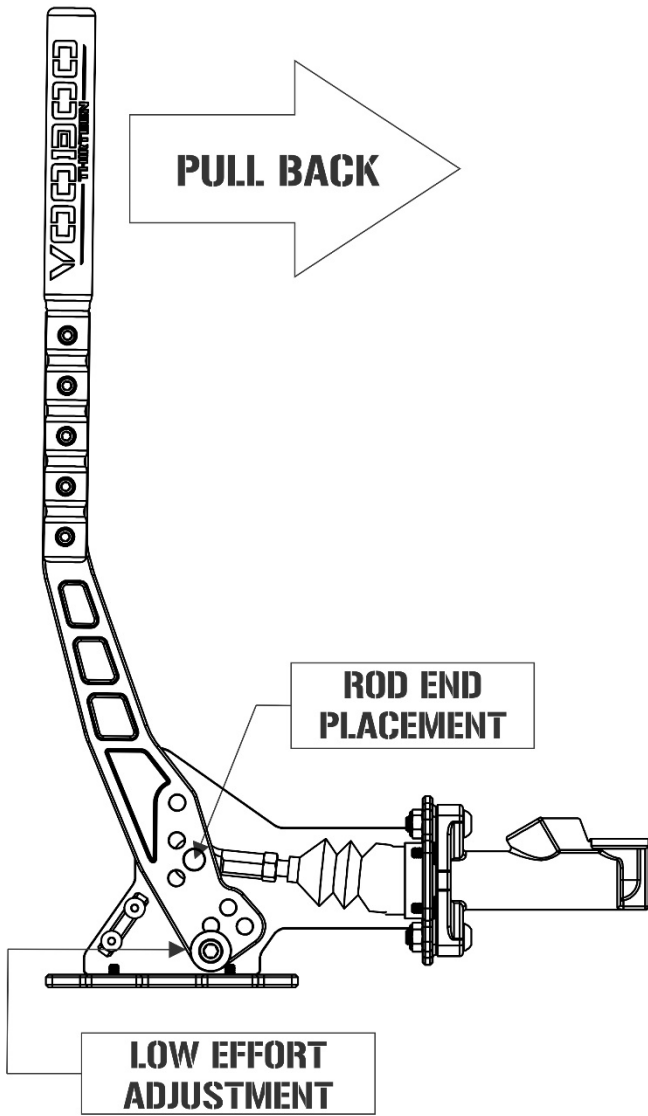

NON-INVERTED BASE CONFIGURATION

PULL UP ASSEMBLY

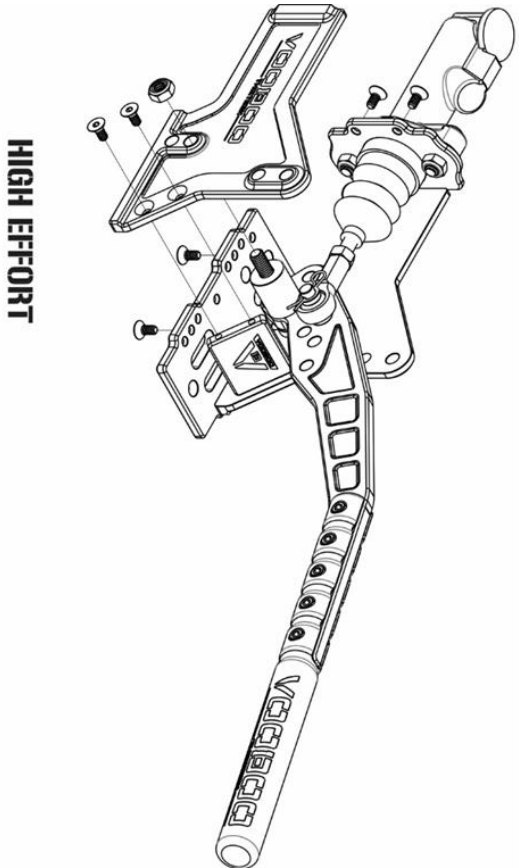

LOW EFFORT

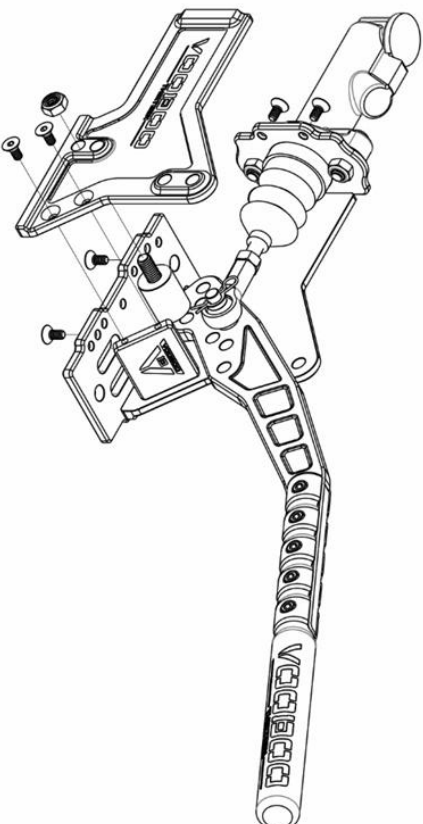

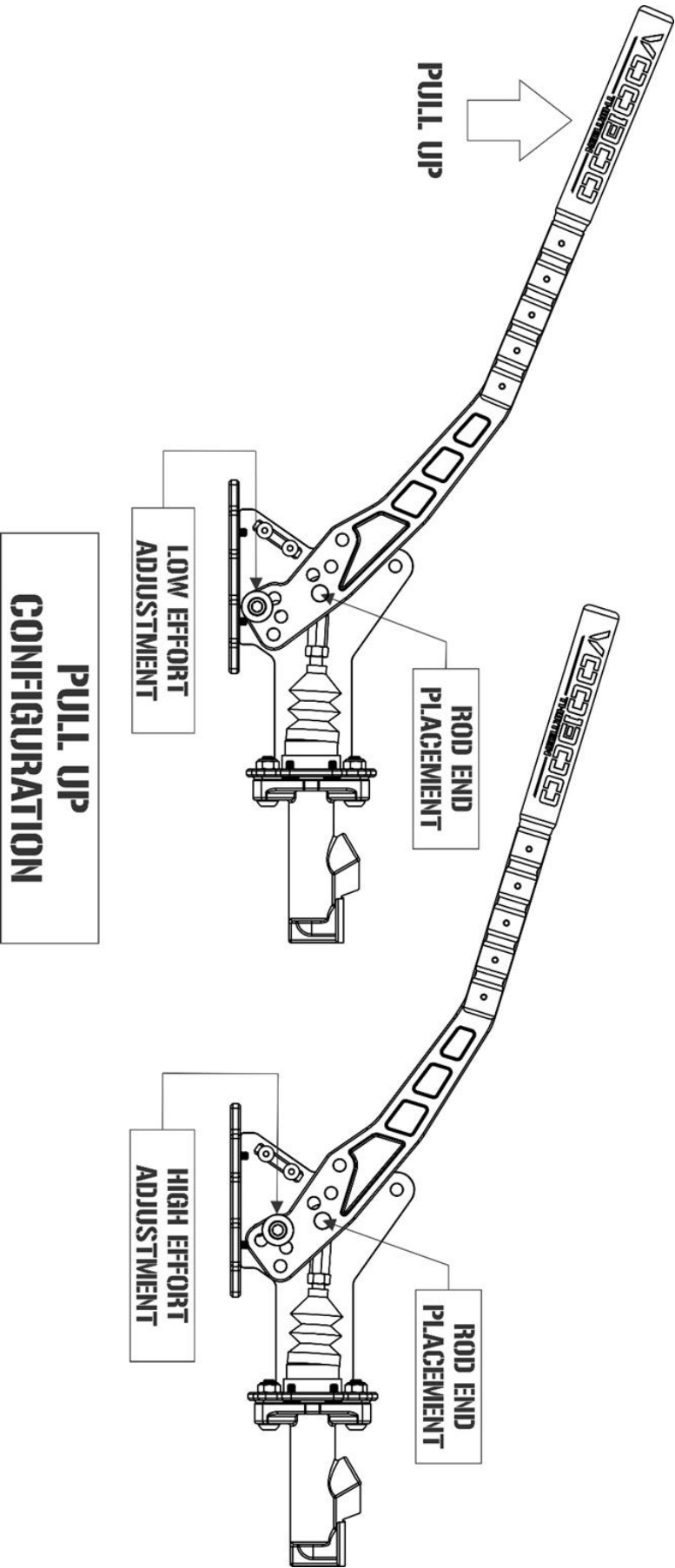

WARRANTY

All products sold are subject to the following warranty:

Voodoo13 offers a Limited Lifetime Warranty for our products to the original retail consumer against defects and workmanship when used on light truck and car applications under normal operating conditions. This warranty does not apply to parts that have been improperly installed or wearable items such as, but not limited to, worn bushings or bearings unless proven to be defective from the manufacturer.

Exterior finish on all Voodoo13 products is not considered a valid warranty; consumers are responsible for the maintenance of paint, anodize or raw metal finish.

The consumer will be responsible for the removal and freight costs both to and from the Distributor from which the product was originally purchased. Proof of purchase and product registration through the Voodoo13 website is mandatory in order to receive warrantee replacement; original invoice from the Distributor from which the product was purchased must accompany the product in question for warrantee.

Voodoo13 has the right to refuse a warrantee claim if procedures are not met by the original consumer. All returns must have an R.M.A. approval from Voodoo13 prior to shipping direct to the Voodoo13 facility. Exclusions from this warranty are sales outside of the United States, the finish, dents, rust, or any condition caused by abnormal use or neglect.

WARNING

High performance parts. For off-road use only. Installation should be carried out by a qualified facility. Improper use or installation may result in injury or death.



VOODOO13
254 W Broadway Rd,
Mesa, AZ 85210
Ph: 480.889.0812
Fax: 480.829.8103
www.VOODOO13USA.com