



**REAR CAMBER ARM
INSTALLATION INSTRUCTIONS:
2015+ FORD MUSTANG S550 (EXCL. GT350)
PART NUMBER:
RCFO-0100**

We recommend that installation of all Voodoo13 parts be completed by a professional who is experienced in suspension tuning. With proper installation and maintenance, Voodoo13 suspension products will provide exceptional performance and durability. For any questions, please contact Voodoo13 immediately. We thank you for choosing Voodoo13 for your suspension tuning needs!

NEED HELP?

Our representatives are here to help you with any questions concerning the operation of this product.

CALL 480-889-0812

Monday thru Friday 8:30am to 5:30pm MST

RECOMMENDED TOOLS AND SUPPLIES

- General Mechanics Tool Set
- 18mm Ratcheting Wrench

PART BREAKDOWN

NOTE: For any OE hardware please refer to OEM service manual for torque specifications. For all included hardware please torque to specifications shown below.

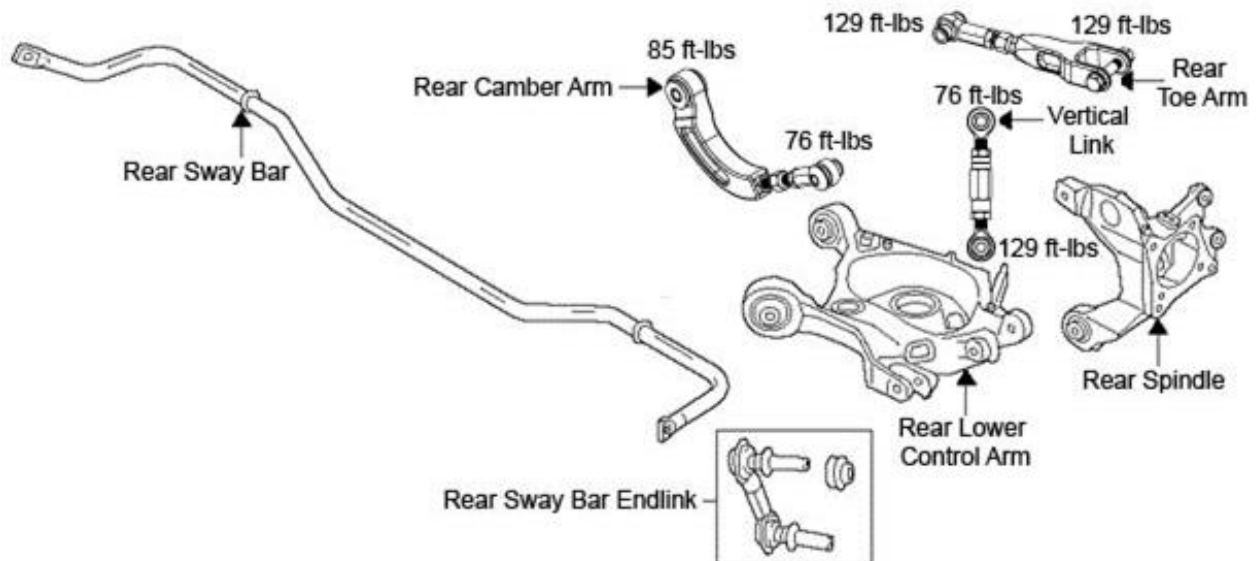

INSTALLATION PROCEDURE

Step 1: Lift the vehicle to a safe height using the recommended factory lift points to work underneath the rear suspension. Ensure to place safety jack stands where recommended by Ford before anyone goes underneath the car (unless using a vehicle lift with safety locks).

Step 2: Begin to loosen the outer bolt to the upper control that is connected to the knuckle. Use a 15mm and 18mm wrench.

Step 3: Move to the opposing side of the arm and loosen the nut with an 18mm wrench. It's recommended to use an 18mm ratcheting wrench for ease of removal. The head of the bolt has a tab that will rest on the subframe to help assist removal by not slipping.

Step 4: Remove the stock arm and place it on a level surface. Place the new arm over it to get a general idea of what the stock length is and adjust accordingly until they match.

Step 5: Begin to install the arm on the subframe side. Do not fully tighten the bolt to allow some play to help ease of installing the other end of the arm.

Step 6: Next, start to install the rod end side of the arm to the spindle. Use the supplied bolt, fender washer and nut. Ensure the conical spacer is seated correctly before tightening and setting final **torque of 76 ft-lbs**.

Step 7: At this point we advise to either slide the arm to the inner side of the factory slotted adjustment for more negative camber or to the outer side of the of the factory slotted adjustment for more camber correction. Just make sure that both arms are set the same to avoid the risk of introducing bumpsteer.

Once you have decided what camber range you desire, set final **torque** of the inner bolt to **85 ft-lbs**.

Step 8: Align the rod end correctly (Refer to the next page) and tighten the jam nuts with the wheel off. With the wheel off there's more accessibility.

Step 9: Repeat steps 2 thru 8 for the opposite side.

Step 10: Lower vehicle safely back to the ground and perform a vehicle alignment. You are finished!

ROD END ADJUSTMENT GUIDELINES

When adjusting rod end to desired position, adjust so that the rod end and adjuster have approximately the same amount of thread showing. Always use the jam nuts to secure the rod end and adjuster. Never tighten the rod end into the adjuster or the adjuster in the lower control arm as a jamming mechanism.

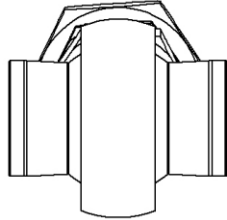

CORRECTLY POSITIONED

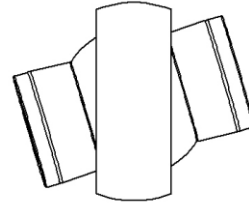

INCORRECTLY POSITIONED
TOO MUCH STATIC ROD END MISALIGNMENT

WARRANTY

All products sold are subject to the following warranty:

Voodoo13 offers a Limited Lifetime Warranty for our products to the original retail consumer against defects and workmanship when used on light truck and car applications under normal operating conditions. This warranty does not apply to parts that have been improperly installed or wearable items such as, but not limited to, worn bushings or bearings unless proven to be defective from the manufacturer.

Exterior finish on all Voodoo13 products is not considered a valid warranty; consumers are responsible for the maintenance of paint, anodize or raw metal finish.

The consumer will be responsible for the removal and freight costs both to and from the Distributor from which the product was originally purchased. Proof of purchase and product registration through the Voodoo13 website is mandatory in order to receive warrantee replacement; original invoice from the Distributor from which the product was purchased must accompany the product in question for warrantee.

Voodoo13 has the right to refuse a warrantee claim if procedures are not met by the original consumer. All returns must have an R.M.A. approval from Voodoo13 prior to shipping direct to the Voodoo13 facility. Exclusions from this warranty are sales outside of the United States, the finish, dents, rust, or any condition caused by abnormal use or neglect.

 **WARNING**

High performance parts. For off-road use only. Installation should be carried out by a qualified facility. Improper use or installation may result in injury or death.



VOODOO13
254 W Broadway Rd
Mesa, AZ 85210
Ph: 480.889.0812
Fax: 480.829.8103
www.VOODOO13USA.com