

VOCC13

THIRTEEN



REAR CAMBER ARM INSTALLATION INSTRUCTIONS:

- 2005 - 2013 AUDI A3/S3/RS3 (8P)**
 - 2015 - PRESENT AUDI A3/S3/RS3 (8V)**
 - 2007 - 2013 AUDI TT/TTS/TTRS (8J)**
 - 2015 - PRESENT AUDI TT/TTS/TTRS (8S)**
 - 2007 - 2009 VOLKSWAGEN EOS (MKV)**
 - 2010 - 2013 VOLKSWAGEN EOS (MKVI)**
 - 2006 - 2009 VOLKSWAGEN JETTA/GTI/GLI/RABBIT/R32 (MKV)**
 - 2010 - 2014 VOLKSWAGEN GOLF/GTI/RABBIT/R (MKVI)**
 - 2015 - PRESENT VOLKSWAGEN GOLF/GTI/R (MKVII)**
 - 2006 - 2013 VOLKSWAGEN PASSAT**
 - 2008 - 2013 VOLKSWAGEN TIGUAN**
- PART NUMBER:
VOO-RCVW-0100**
- (INDEPENDENT REAR SUSPENSION ONLY)**

We recommend that installation of all Voodoo13 parts be completed by a professional who is experienced in suspension tuning. With proper installation and maintenance, Voodoo13 suspension products will provide exceptional performance and durability. For any questions, please contact Voodoo13 immediately. We thank you for choosing Voodoo13 for your suspension tuning needs!

NEED HELP?

Our representatives are here to help you with any questions concerning the operation of this product.

CALL 480-889-0812

Monday thru Friday 8:30am to 5:30pm MST

RECOMMENDED TOOLS AND SUPPLIES

- General Mechanics Tool Set
- 18mm and 21mm sockets

PART BREAKDOWN

NOTE: For any OE hardware please refer to OEM service manual for torque specifications. For all included hardware please torque to specifications shown below.

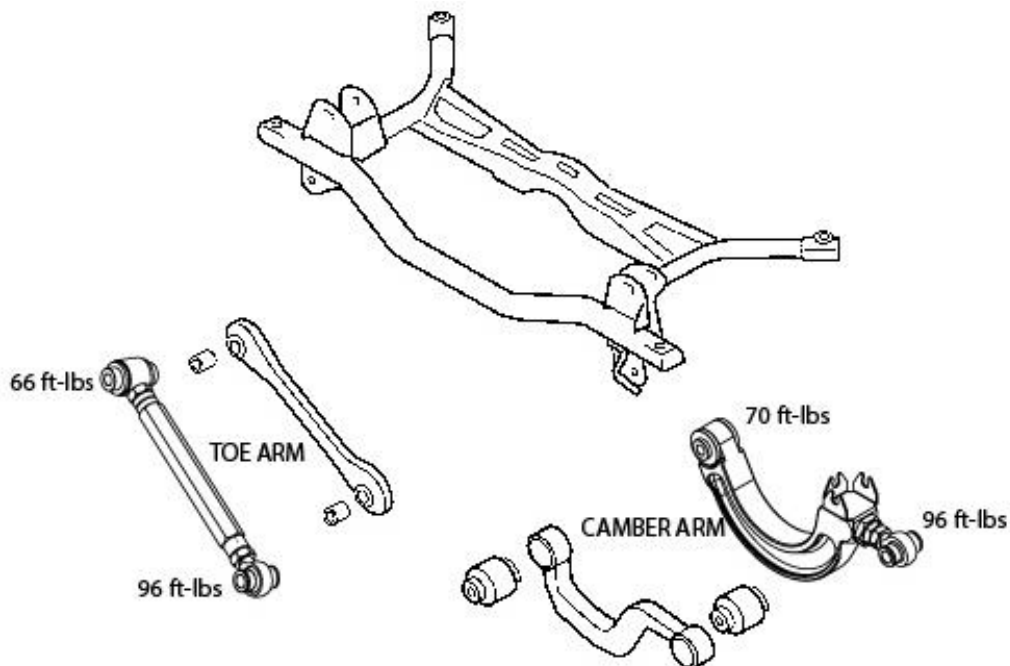

INSTALLATION PROCEDURE

Step 1: Lift the vehicle to a safe height using the recommended factory lift points to work underneath the rear suspension. Ensure to place safety jack stands where recommended by Volkswagen/Audi before anyone goes underneath the car (unless using a vehicle lift with safety locks)

Step 2: Remove the rear wheels to gain access to the rear upper control arm.

Step 3: First disconnect the rear sensor from the arm. Remove the nut and bolt from the hub side. Socket size needed on both sides are a 21mm.



Step 4: Remove the eccentric bolt and nut on the subframe side. Socket size needed on both sides are an 18mm.



Step 5: Overlay the new arm over the factory arm to set a baseline for desired camber.



Step 6: Install the arm by the subframe first for an easier install. Torque the bolt and nut to **70 ft-lbs and apply an additional 90° turn.**

Step 7: Next install the with the factory hardware on the hub side and torque to **96 ft-lbs and apply an additional 90° turn.**

Step 8: Install the sensor line into the new bracket. Set the desire amount of camber and tighten the jam nuts.

Step 9: Lower vehicle safely back to the ground and perform a vehicle alignment. You are finished!

ROD END ADJUSTMENT GUIDELINES

When adjusting rod end to desired position, adjust so that the rod end and adjuster have approximately the same amount of thread showing. Always use the jam nuts to secure the rod end and adjuster. Never tighten the rod end into the adjuster or the adjuster in the lower control arm as a jamming mechanism.

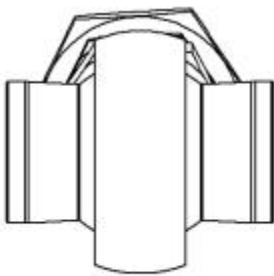
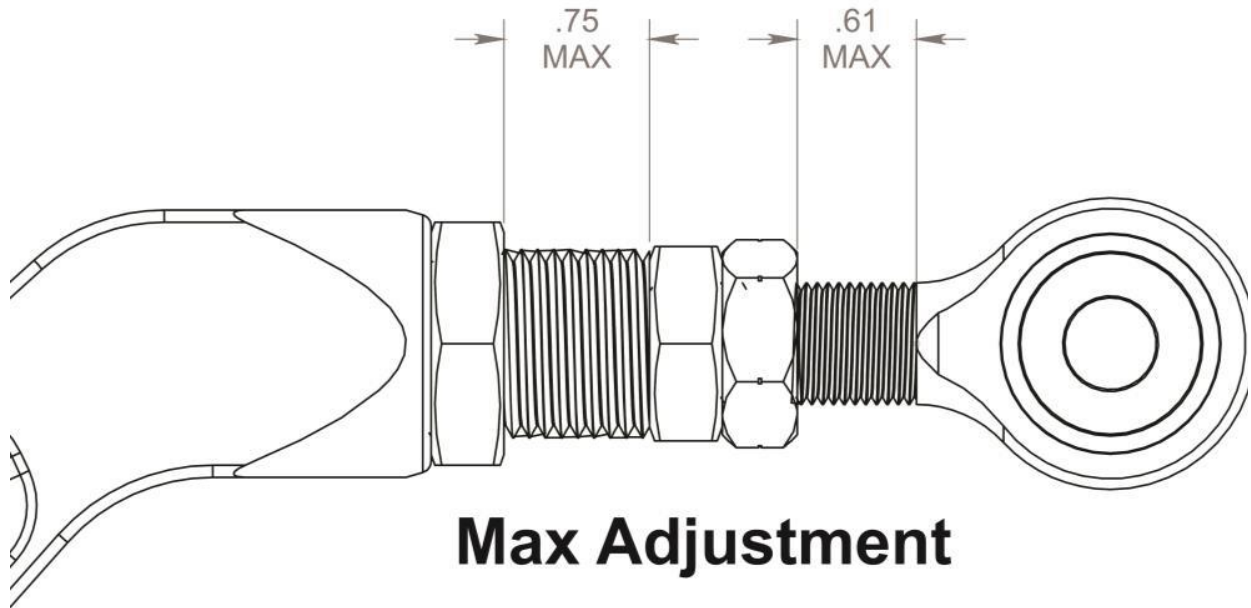

CORRECTLY POSITIONED

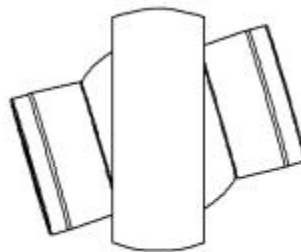

INCORRECTLY POSITIONED
TOO MUCH STATIC ROD END MISALIGNMENT

WARRANTY

All products sold are subject to the following warranty:

Voodoo13 offers a Limited Lifetime Warranty for our products to the original retail consumer against defects and workmanship when used on light truck and car applications under normal operating conditions. This warranty does not apply to parts that have been improperly installed or wearable items such as, but not limited to, worn bushings or bearings unless proven to be defective from the manufacturer.

Exterior finish on all Voodoo13 products is not considered a valid warranty; consumers are responsible for the maintenance of paint, anodize or raw metal finish.

The consumer will be responsible for the removal and freight costs both to and from the Distributor from which the product was originally purchased. Proof of purchase and product registration through the Voodoo13 website is mandatory in order to receive warrantee replacement; original invoice from the Distributor from which the product was purchased must accompany the product in question for warrantee.

Voodoo13 has the right to refuse a warrantee claim if procedures are not met by the original consumer. All returns must have an R.M.A. approval from Voodoo13 prior to shipping direct to the Voodoo13 facility. Exclusions from this warranty are sales outside of the United States, the finish, dents, rust, or any condition caused by abnormal use or neglect.

WARNING

High performance parts. For off-road use only. Installation should be carried out by a qualified facility. Improper use or installation may result in injury or death.



VOODOO13

254 W Broadway Rd

Mesa, AZ 85210

Ph: 480.889.0812

Fax: 480.829.8103

www.VOODOO13USA.com